

CHANDIGARH PROJECT



NOTE:-

SECTOR	5 M	7 1/2 M	10 M	ONE KANAL	TOTAL PLOTS	TOTAL UNITS
39-C	142	76	36	16	270	794
39-C	108	86	36	12	242	714
TOTAL PLOTS	250	162	72	28	512	-
TOTAL UNITS	75	486	216	56	-	1508

LEGEND

- LAND ALLOTTED
- LAND NOT ALLOTTED
- LAND RESERVED FOR FUTURE PLANNING
- GREEN SPACES

THIS DRAWING IS THE COMPUTERIZED REPRODUCTION OF THE ORIGINAL DRAWING NO. 16 OF JOB NO. 68 DTD.

Pooja Sharma PREPARED BY
S.K.Madan CHECKED BY
Daljit Singh A.T.P.

CHIEF ARCHITECT SENIOR TOWN PLANNER

DIVL. TOWN PLANNER ASSTT. TOWN PLANNER

SCALE :- 160 FEET TO AN INCH

DRAWN BY: CHECKED:

DRG.NO : 16 JOB NO : 68 DATED:

LAYOUT PLAN OF SECTOR -39

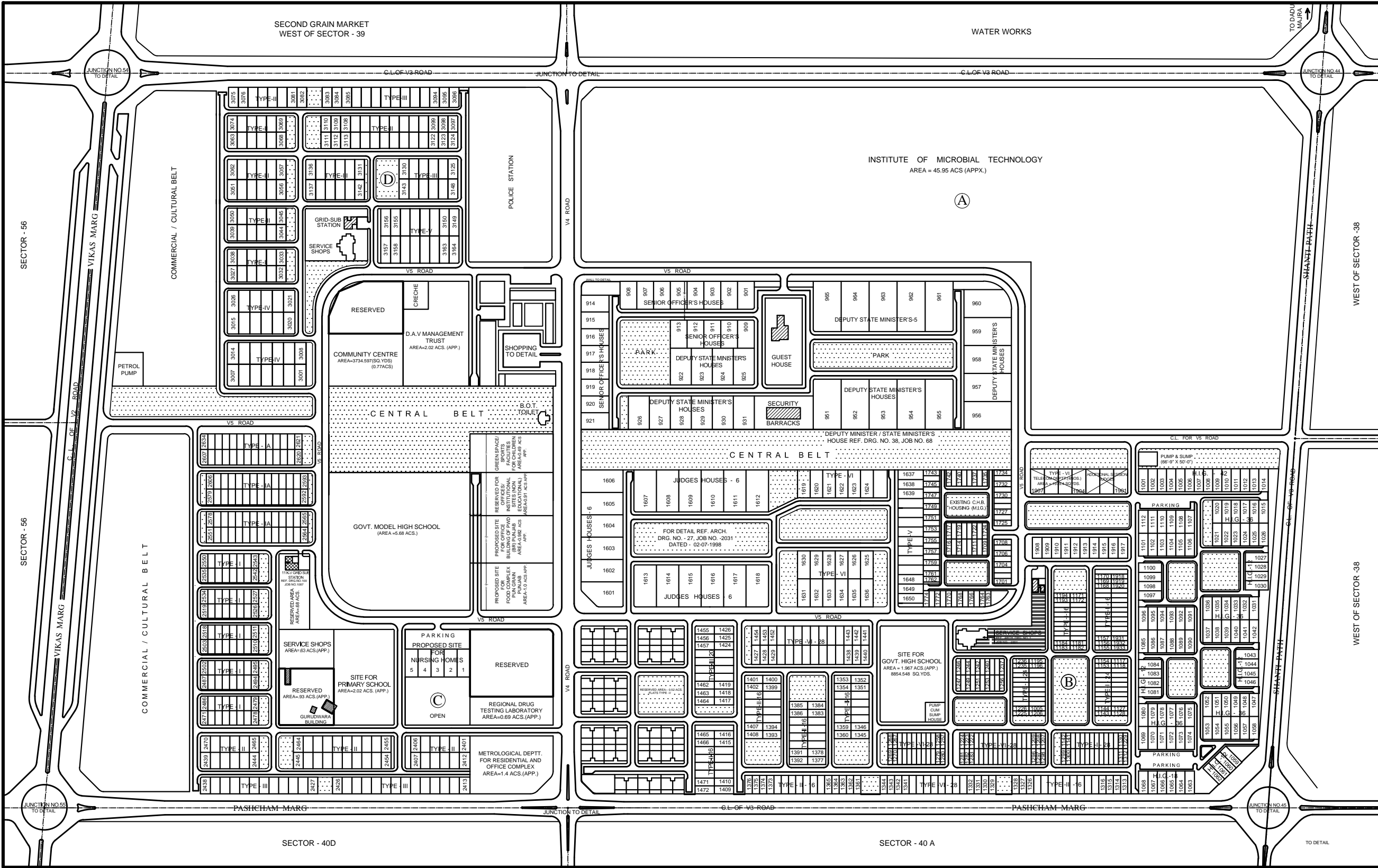

SECOND GRAIN MARKET
WEST OF SECTOR - 39

WATER WORKS

INSTITUTE OF MICROBIAL TECHNOLOGY
AREA = 45.95 ACS (APPX.)

COMMERCIAL / CULTURAL BELT

POLICE STATION

COMMUNITY CENTRE
AREA=37.45/59750 SQ.YDS.
(0.77ACS)

GOVT. MODEL HIGH SCHOOL
(AREA =5.86 ACS.)

CENTRAL BELT

CENTRAL BELT

JUDGES HOUSES - 6

DEPUTY MINISTER / STATE MINISTER'S HOUSE REF. DRG. NO. 38, JOB NO. 68

JUDGES HOUSES - 6

JUDGES HOUSES - 6

JUDGES HOUSES - 6

JUDGES HOUSES - 6

JUDGES HOUSES - 6

JUDGES HOUSES - 6

JUDGES HOUSES - 6

JUDGES HOUSES - 6

JUDGES HOUSES - 6

JUDGES HOUSES - 6

JUDGES HOUSES - 6

SITE FOR GOVT. HIGH SCHOOL
AREA = 1.867 ACS (APPX.)
8854.548 SQ.YDS.

SECTOR - 40D

SECTOR - 40 A

WEST OF SECTOR -38

WEST OF SECTOR -38

TO DETAIL