

FRONT ELEVATION

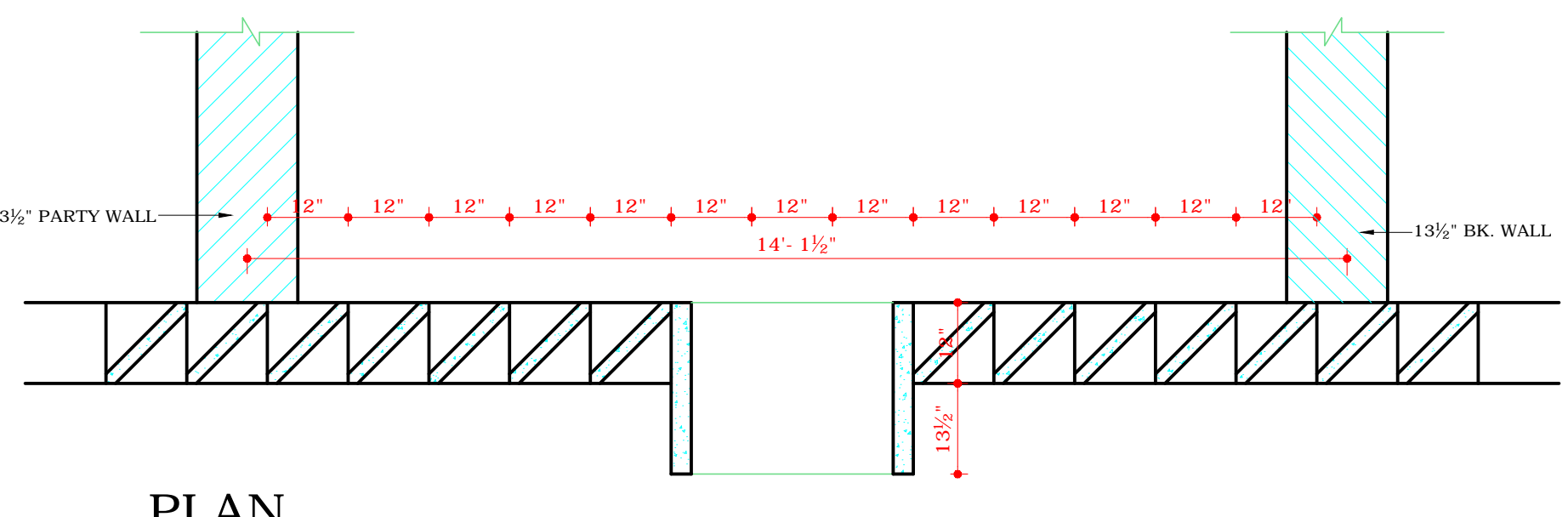

PLAN

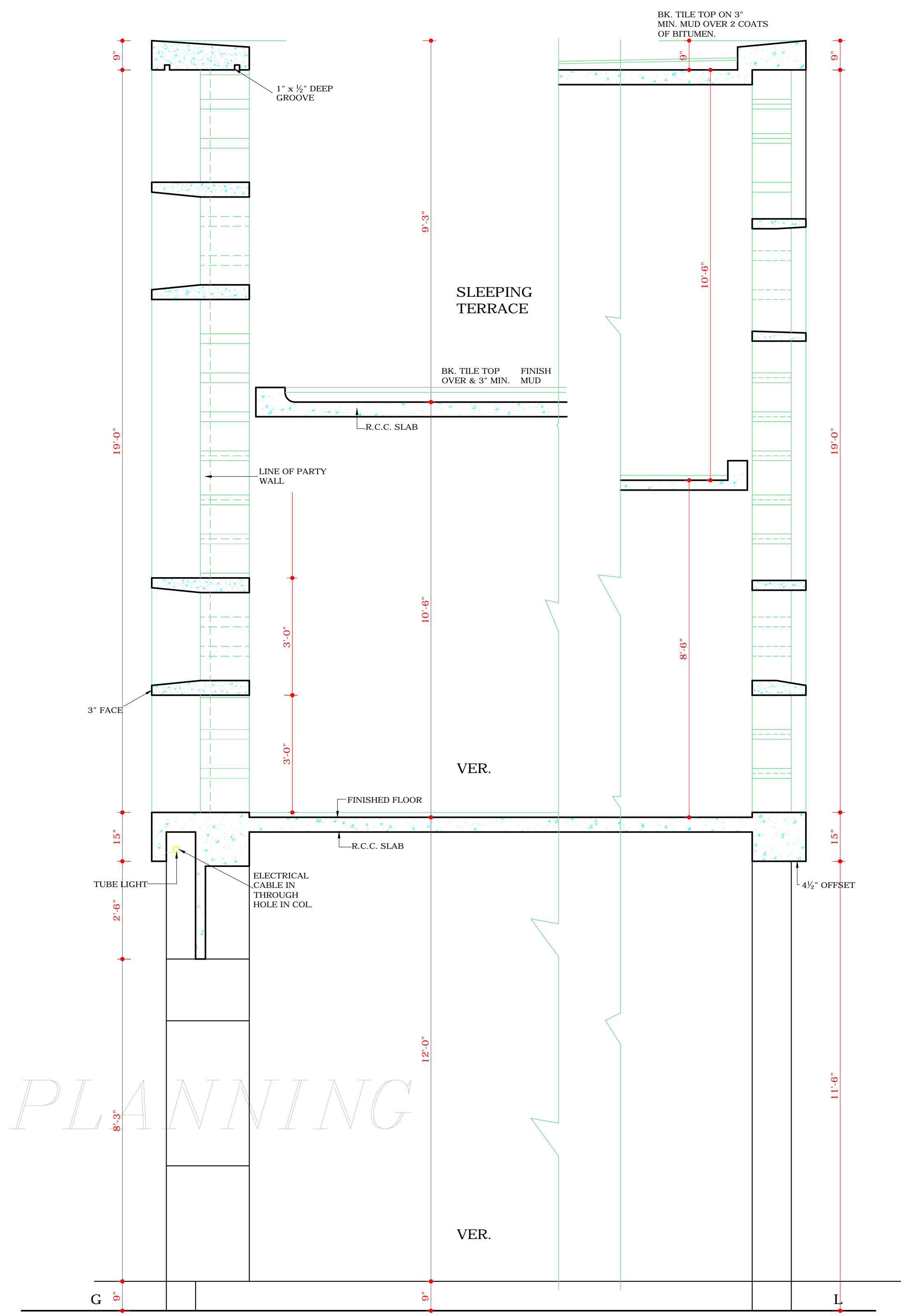

CROSS SECTION

DISCLAIMER
 THOUGH EVERY CARE HAS BEEN TAKEN TO PROVIDE THE CORRECT VERSION OF THE ARCHITECTURAL CONTROL ON THIS DIGITIZED (PDF) FORMAT, YET IN CASE OF ANY DISCREPANCY, THE MASTER COPY OF THE ARCHITECTURAL CONTROL APPLICABLE ON EACH SUCH SITE, AS AVAILABLE IN THE COMMERCIAL RECORD OF THE OFFICE OF CHIEF ARCHITECT OR HER/HIS INTERPRETATION WILL OVERRULE THE DIGITIZED FORMAT.

SD. J.S. DETHE SENIOR ARCHITECT
 SD. P. JEANERT 31.1.63 CHIEF ARCHITECT
 SD. S.L. VARMA 19.9.70 CHIEF ADMINISTRATOR

S.NO.	NOTES
1	THIS DRG. IS THE PROPERTY OF DEPTT. OF ARCHITECTURE, CHD. AND MUST NOT BE COPIED, ALTERED OR USED IN WHOLE OR IN PART WITHOUT THE PERMISSION OF THIS DEPTT. IN WRITING.

THIS ARCHITECTURAL CONTROL (DRG. NO. 11, 12, 13 OF JOB NO. 210) IS ALSO APPLICABLE TO S.C.F. SITES NO. 44 TO 49 IN THE SHOPPING CENTRE SECTOR-11, CHD. AS APPROVED BY THE CHIEF ADMINISTRATOR CHANDIGARH VIDE MEMO NO. 5229 - UTFI (4) - 94/7114 DATED, CHANDIGARH THE 19.5.94

NOTE:
 THIS DRAWING IS THE COMPUTERISED REPRODUCTION OF ORIGINAL DRG. NO.13 JOB NO. 210 DATED-23-10-08

S.NO.	REVISIONS
-------	-----------

CHIEF ARCHITECT	Sd/- J.S. DETHE SENIOR ARCHITECT
	Sd/- S.D. SHARMA 12 / 9 / 69 ARCHITECT
	Sd/- S.K. MIDHA ASSTT. ARCHITECT

OFFICE OF THE CHIEF ARCHITECT & SECRETARY CHANDIGARH ADMN. CHD.

SCALE = 1/2" INCH TO A FOOT	DATE - AUG 14, 1969
DRAWN BY P. PARKASH 14.8.69	CHECKED Sd/-
JOB NO. 210	DRG NO. 13

SHOPPING CENTRE SECTOR 11-D 16-D

ELEVATION.