

DEPARTMENT OF  
ARCHITECTURE

NOTES

THIS DRG. IS THE PROPERTY OF THE DEPTT. OF ARCHITECTURE, CHANDIGARH ADMN. AND FORMERLY THE GOVT. OF PUNJAB AND MUST NOT BE ALTERED, COPIED OR USED IN WHOLE OR IN PART WITHOUT THE PERMISSION OF THIS DEPTT. IN WRITING.  
THIS DRG. IS TRACED FROM DRG. No. 5 JOB No. 220 ON DATED 27.4.73  
SD:-  
27th APRIL 1973

NOTE:- THIS DRAWING IS THE COMPUTERISED REPRODUCTION OF ORIGINAL DRG. No. 5 JOB No. 220 DATED- 11-12-08

DESCRIPTION	DATE SIGN
REVISIONS	
Sd/- S.L.VARMA CHIEF ADMINISTRATOR	Sd/- M.N.SHARMA CHIEF ARCHITECT
Sd/- P.JEANNERET SENIOR ARCHITECT	Sd/- ADITYA PARKASH 22 X.59 JUNIOR ARCHITECT

OFFICE OF THE  
CHIEF ARCHITECT  
CHANDIGARH U.T.

SCALE = 1/2" TO A FOOT

DATE

DRAWN SIGN  
SD/-  
27th APRIL 1983

DRG No. 5  
JOB No. 220

DETAIL DRAWING OF  
SHOP-CUM-FLAT  
SECTOR - 24  
SECTIONS.

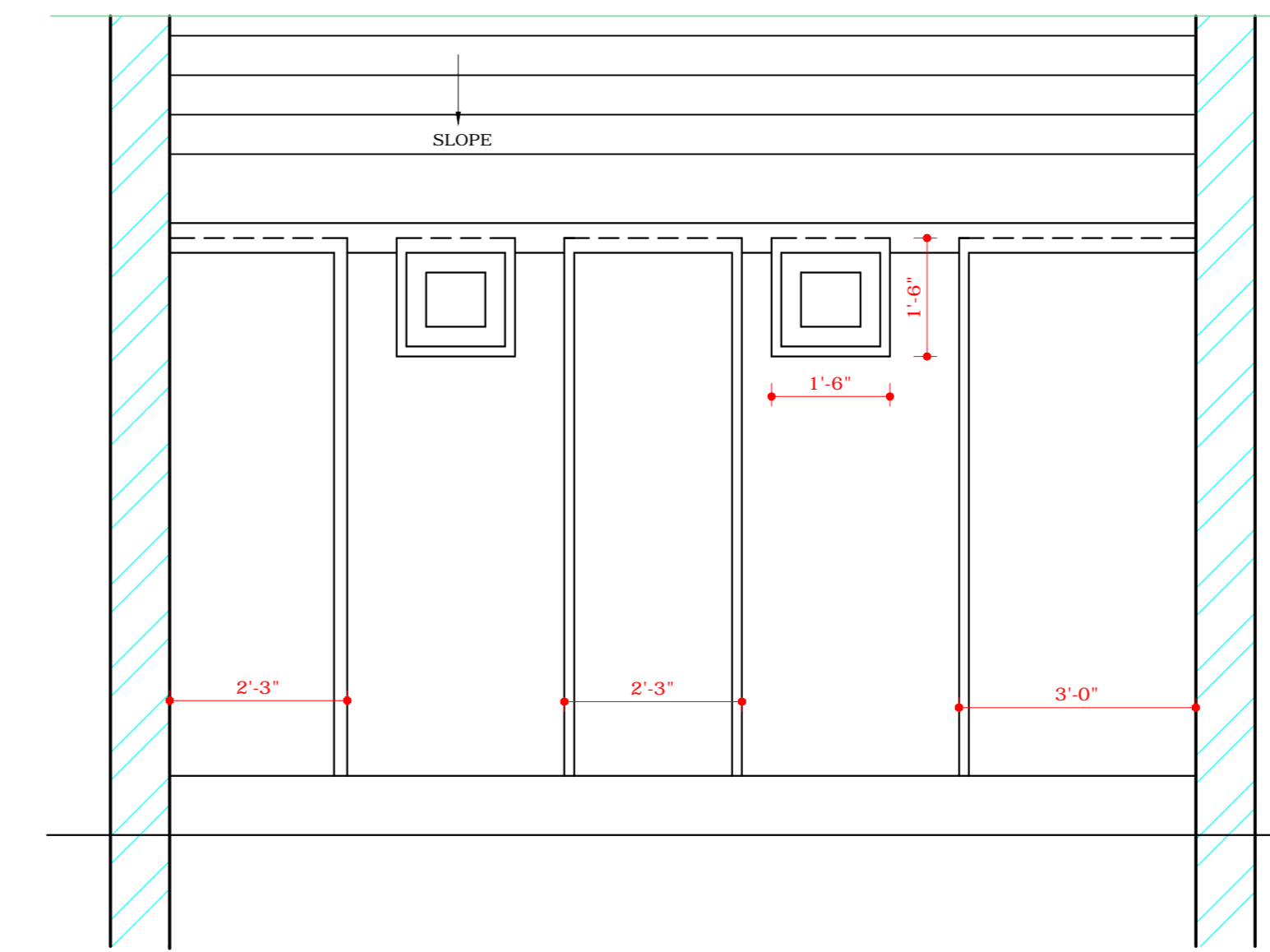

SECTIONAL ELEVATION AT CC'

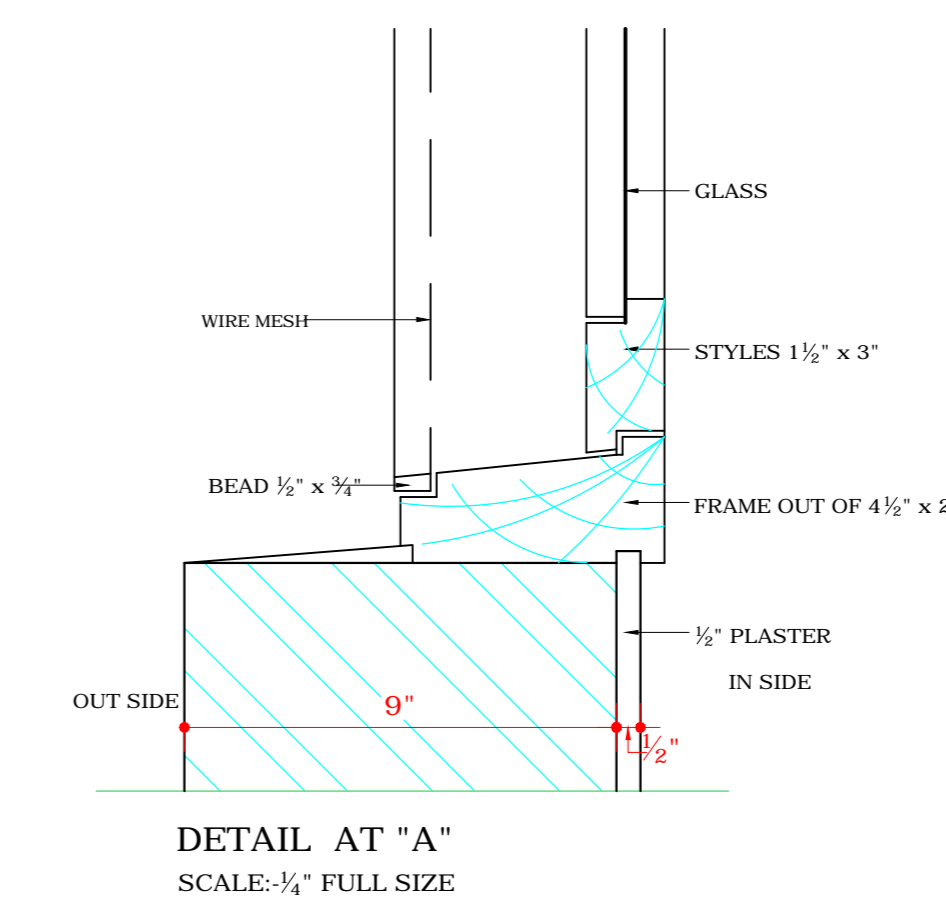

DETAIL AT "A"  
SCALE: 1/2" FULL SIZE

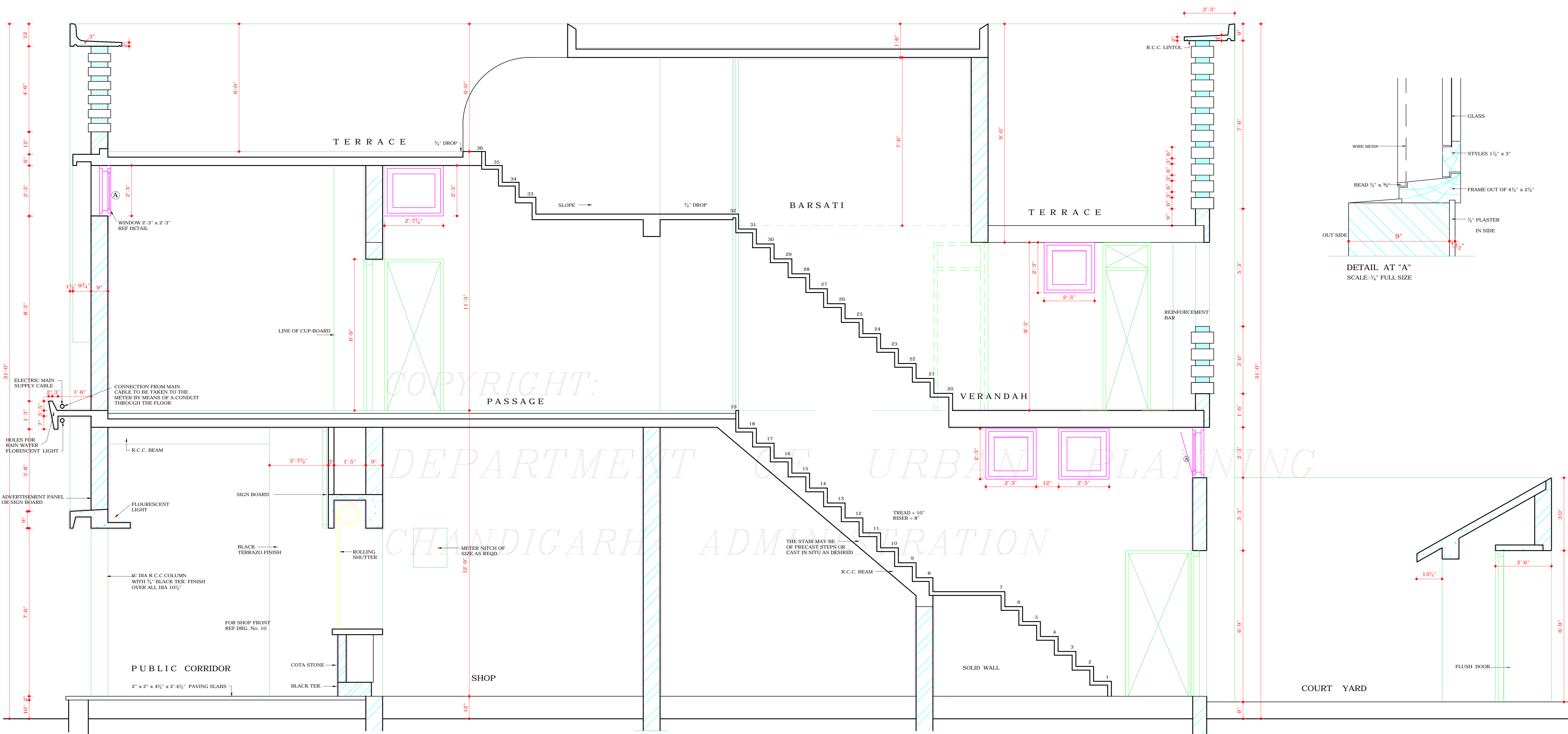

SECTION AT AA'

DISCLAIMER

THOUGH EVERY CARE HAS BEEN TAKEN TO PROVIDE THE CORRECT VERSION OF THE ARCHITECTURAL CONTROL ON THIS DIGITIZED (PDF) FORMAT, YET IN CASE OF ANY DISCREPANCY, THE MASTER COPY OF THE ARCHITECTURAL CONTROL APPLICABLE ON EACH SUCH SITE, AS AVAILABLE IN THE COMMERCIAL RECORDS OF THE OFFICE OF CHIEF ARCHITECT OR HERHIS INTERPRETATION WILL OVERRULE THE DIGITIZED FORMAT.

ATTESTED TRUE COPY  
SD/- KUREKAR  
9.7.73  
ASSTT. ARCHITECT.