

- | S.NO. | NOTES. |
|-------|---|
| 1. | THIS DRG. IS THE PROPERTY OF DEPTT. OF ARCHITECTURE, U.T. CHANDIGARH FORMERLY OF THE P.B. GOVT. AND MUST NOT BE ALTERED, COPIED OR USED IN WHOLE OR IN PART WITHOUT THE PERMISSION OF THIS DEPTT. IN WRITING. |
| 2. | ONLY QUALIFIED ARCHITECTS SHALL BE ALLOWED TO TAKE UP THE CONSTRUCTION WORK OF THESE REPAIR SHOPS. |
| 3. | INTERNAL PARTITION IN THE REPAIR WORK SHOP SHALL BE ALLOWED SUBJECT TO THE APPROVAL OF THE CHIEF ADMINISTRATOR CHANDIGARH. |
| 4. | THIS DRG. IS THE TRACING OF DRG. No. 1 OF JOB No. 492 |

NOTE:
THIS DRAWING HAS BEEN COMPUTERISED ON 21-01-09 FROM DRG. NO.1, JOB NO. 492.

S.NO.	DESCRIPTION
	REVISION

Sd/-
CHIEF ADMINISTRATOR

Sd/- M.N. SHARMA 27.1.07 CHIEF ARCHITECT	Sd/- J.S. DETHE 24.1.67 SENIOR ARCHITECT
--	--

Sd/- O.P. MEHTA 24-1-67 ARCHITECT	Sd/- IQBAL SINGH 24.1.67 ASSTT. ARCHITECT
---	---

OFFICE OF THE CHIEF
ARCHITECT CHANDIGARH.

SCALE:-FOUR FEET TO AN INCH	DATE: 07-01-67
--------------------------------	-------------------

DRAWN: Sd/- O.P. GARG	JOB No. 492	DRG. No. 1
CHECKED BY Sd/- IQBAL SINGH		

SCOOTER REPAIR
WORKSHOPS SECTOR - 7

PLAN.

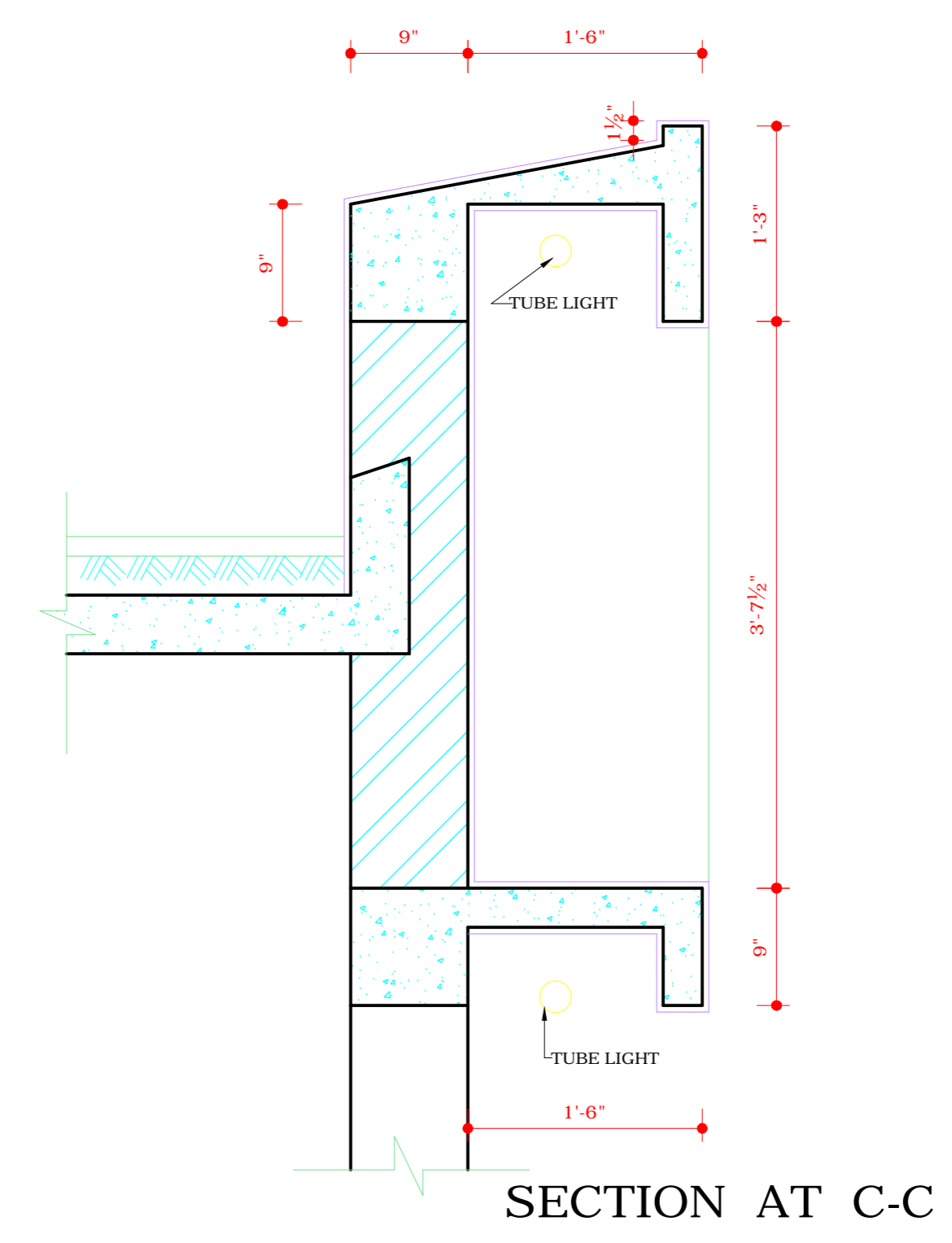
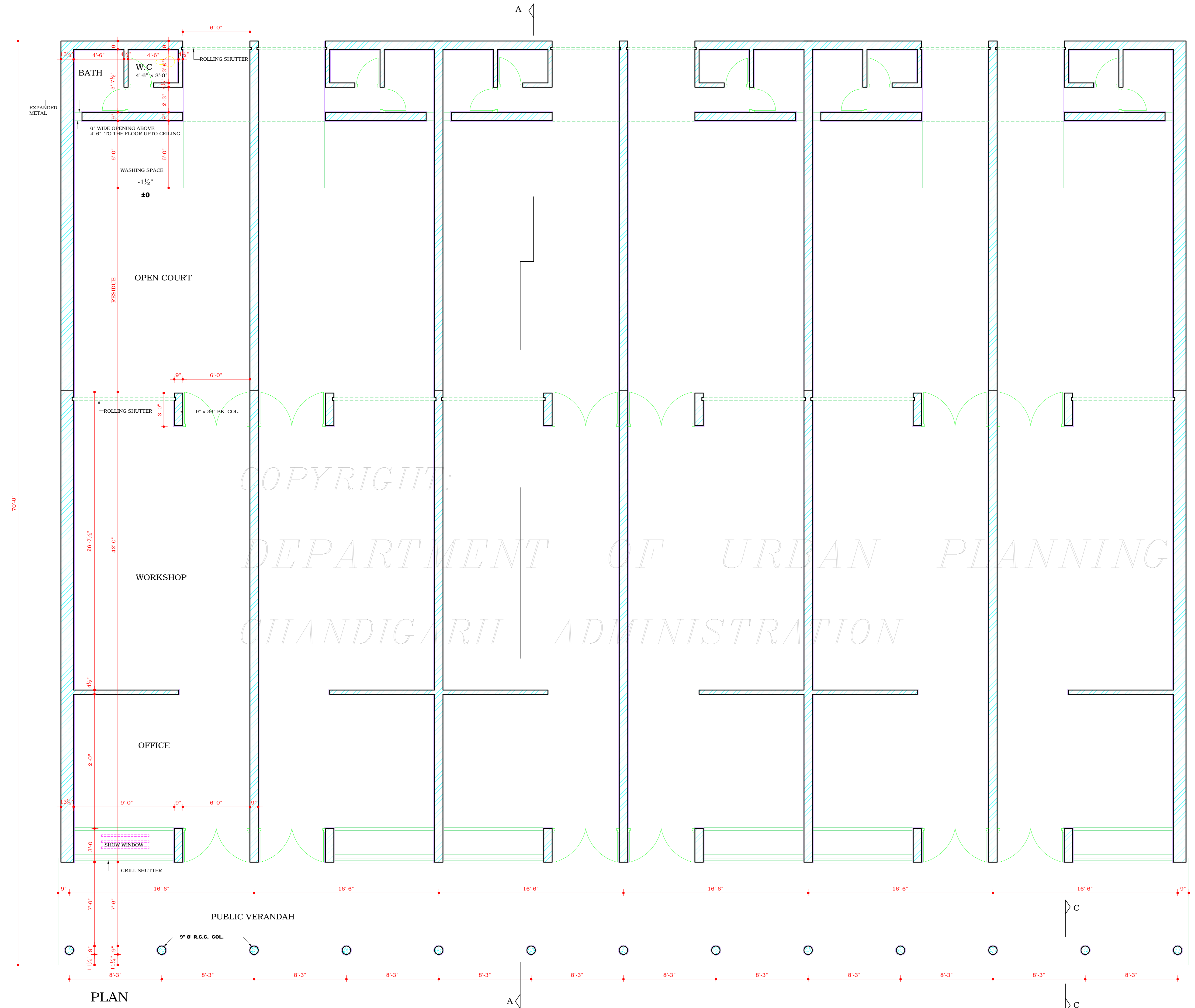

DISCLAIMER
THOUGH EVERY CARE HAS BEEN TAKEN TO PROVIDE THE CORRECT VERSION OF THE ARCHITECTURAL CONTROL ON THIS DIGITIZED (PDF) FORMAT, YET IN CASE OF ANY DISCREPANCY, THE MASTER COPY OF THE ARCHITECTURAL CONTROL APPLICABLE ON EACH SUCH SITE, AS AVAILABLE IN THE COMMERCIAL RECORD OF THE OFFICE OF CHIEF ARCHITECT OR HERHIS INTERPRETATION WILL OVERRULE THE DIGITIZED FORMAT.

ATTESTED
Sd/- KUREKAR
19.4.72
ASSTT. ARCHITECT.