

SECTIONAL ELEVATION CC'

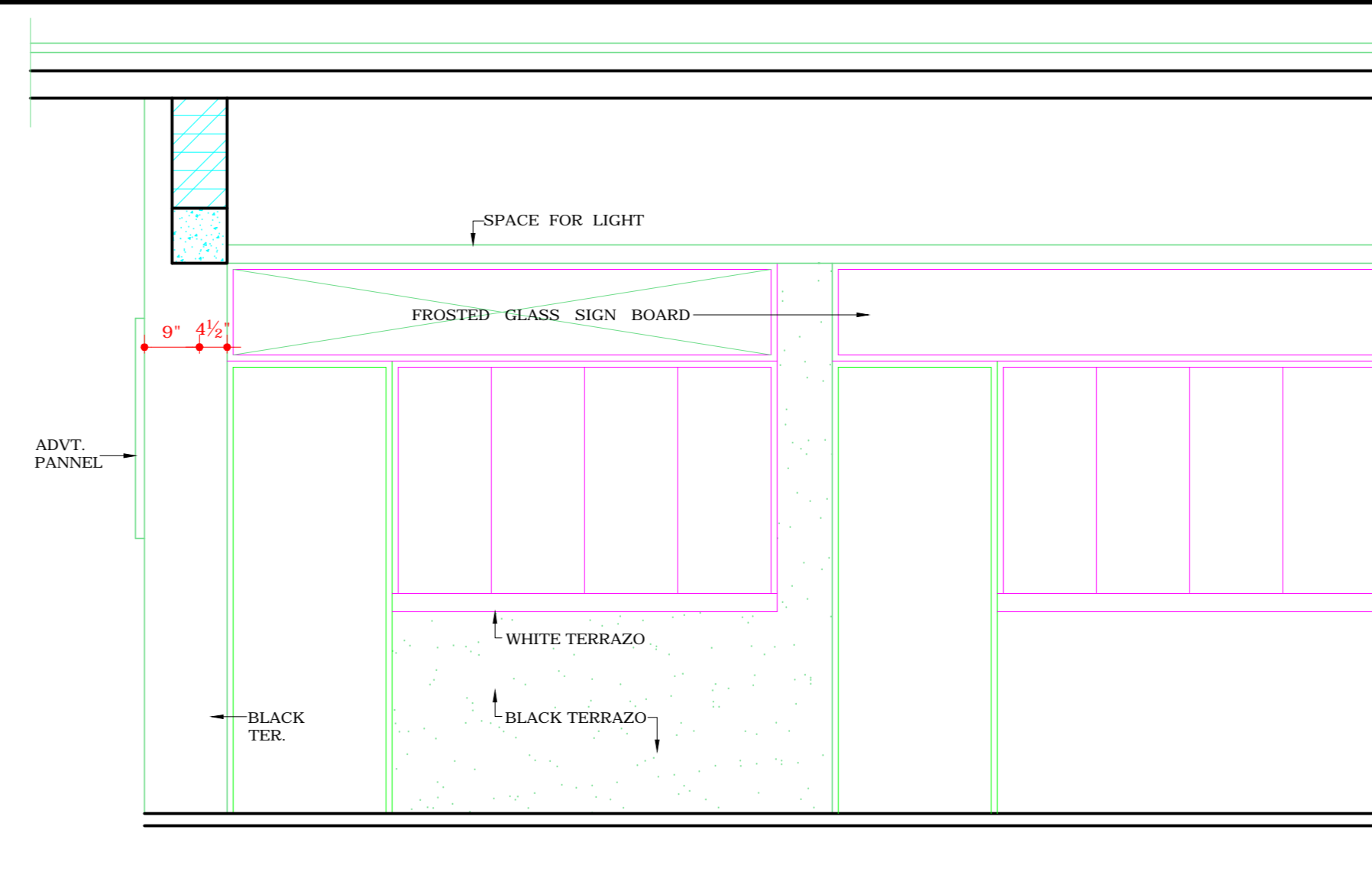

SECTIONAL ELEVATION DD'

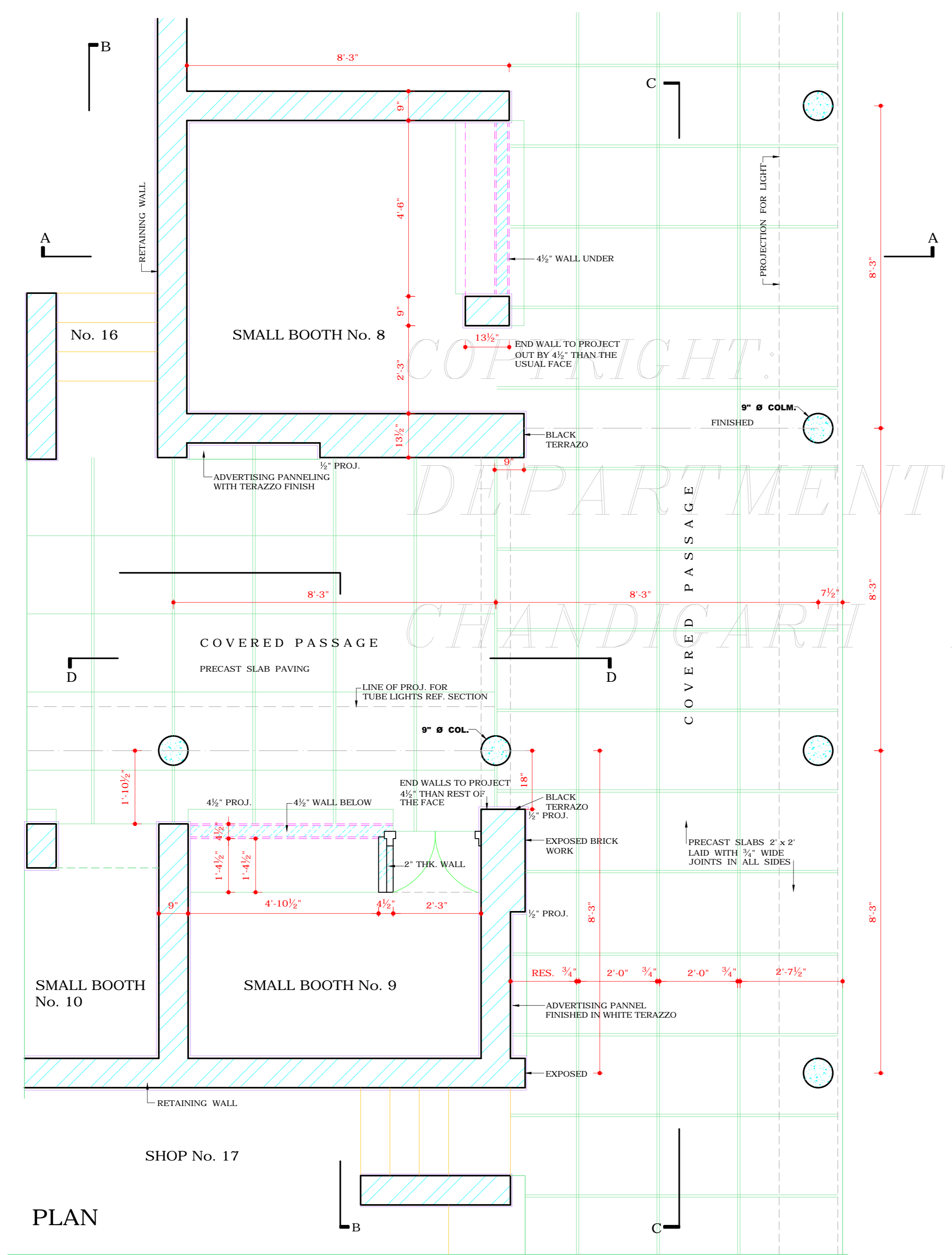

PLAN

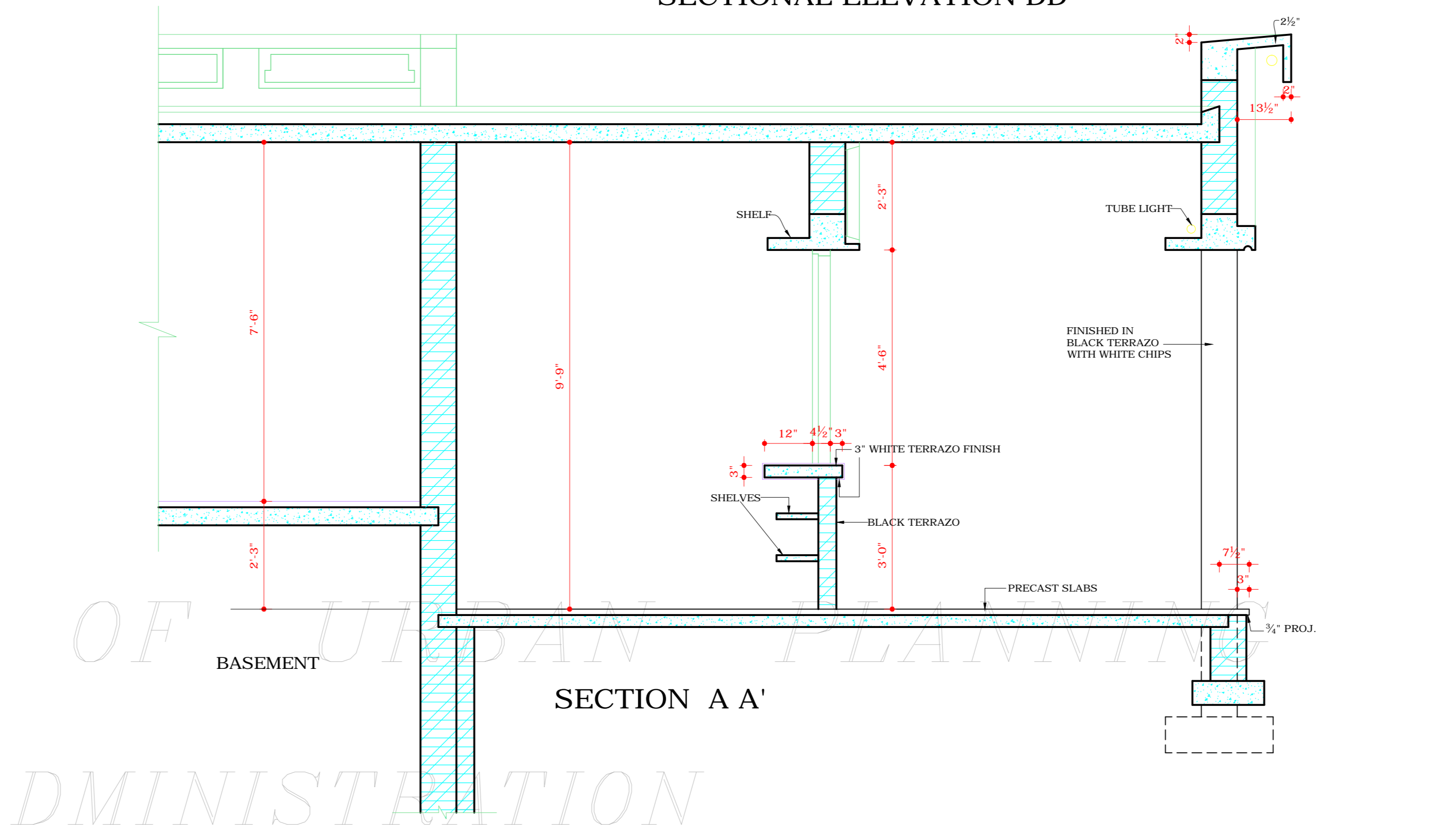

SECTION A A'

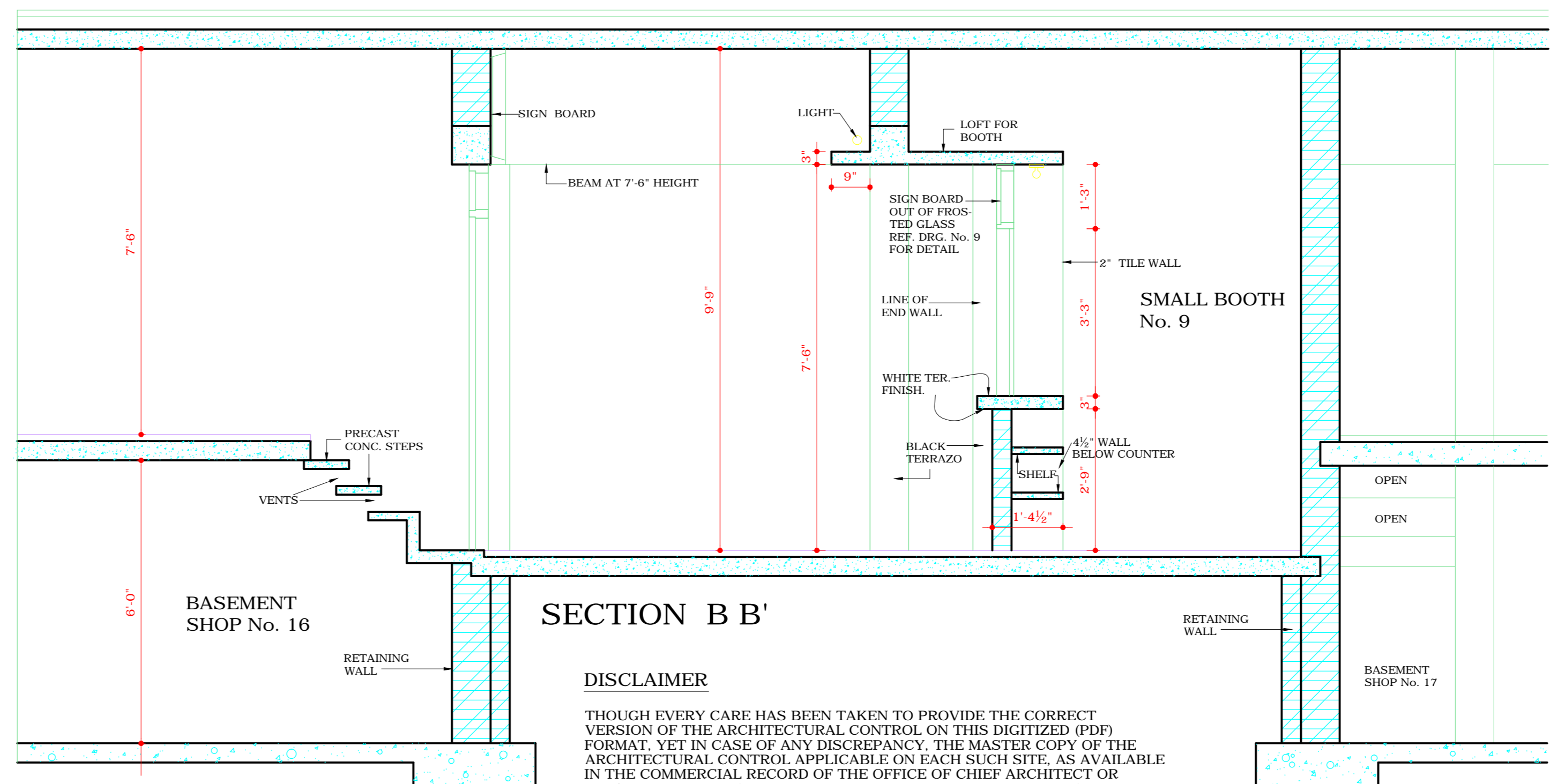

SECTION B B'

DISCLAIMER
 THOUGH EVERY CARE HAS BEEN TAKEN TO PROVIDE THE CORRECT VERSION OF THE ARCHITECTURAL CONTROL ON THIS DIGITIZED (PDF) FORMAT, YET IN CASE OF ANY DISCREPANCY, THE MASTER COPY OF THE ARCHITECTURAL CONTROL APPLICABLE ON EACH SUCH SITE, AS AVAILABLE IN THE COMMERCIAL RECORD OF THE OFFICE OF CHIEF ARCHITECT OR HER/HIS INTERPRETATION WILL OVERRULE THE DIGITIZED FORMAT.

DEPARTMENT OF ARCHITECTURE

NOTES

- THIS DRG. IS THE PROPERTY OF THE DEPTT. OF ARCHITECTURE CHD. U.T. AND FORMERLY OF THE GOVT. PUNJAB AND MUST NOT BE ALTERED, COPIED OR USED IN WHOLE OR IN PART WITHOUT THE PERMISSION OF THIS DEPTT. IN WRITING.
- THIS DRG. IS ACTUALLY TRACED FROM DRG. No. 11 OF JOB No. 126 ON DATED 6.1.73
 Sd: 6/11/73

NOTE:- THIS DRAWING IS THE COMPUTERISED REPRODUCTION OF ORIGINAL DRG. No.11 JOB No. 126 DATED- 18-05-09

Sd: S.L. VARMA
 28.X.70
 CHIEF ADMINISTRATOR

Sd: M.N. SHARMA
 26. X. 70
 CHIEF ARCHITECT

Sd: P. JEANNERET
 11.2.57
 SENIOR ARCHITECT

Sd: ADITYA PARKASH
 11.2.57
 JUNIOR ARCHITECT

Sd: KUREKAR
 15.3.73
 ASSTT. ARCHITECT

OFFICE OF THE CHIEF ARCHITECT CHANDIGARH. U.T.

SCALE = 1/2" = ONE FOOT

DRAWN MANDE Sd: JAN 1973

DRG. No. 11

JOB No. 126

VERY SMALL BOOTHS IN SECTOR -7
 1/2 DETAIL.
 REF. DRG. No. 9 WITH THIS DRG.