

COPYRIGHT:

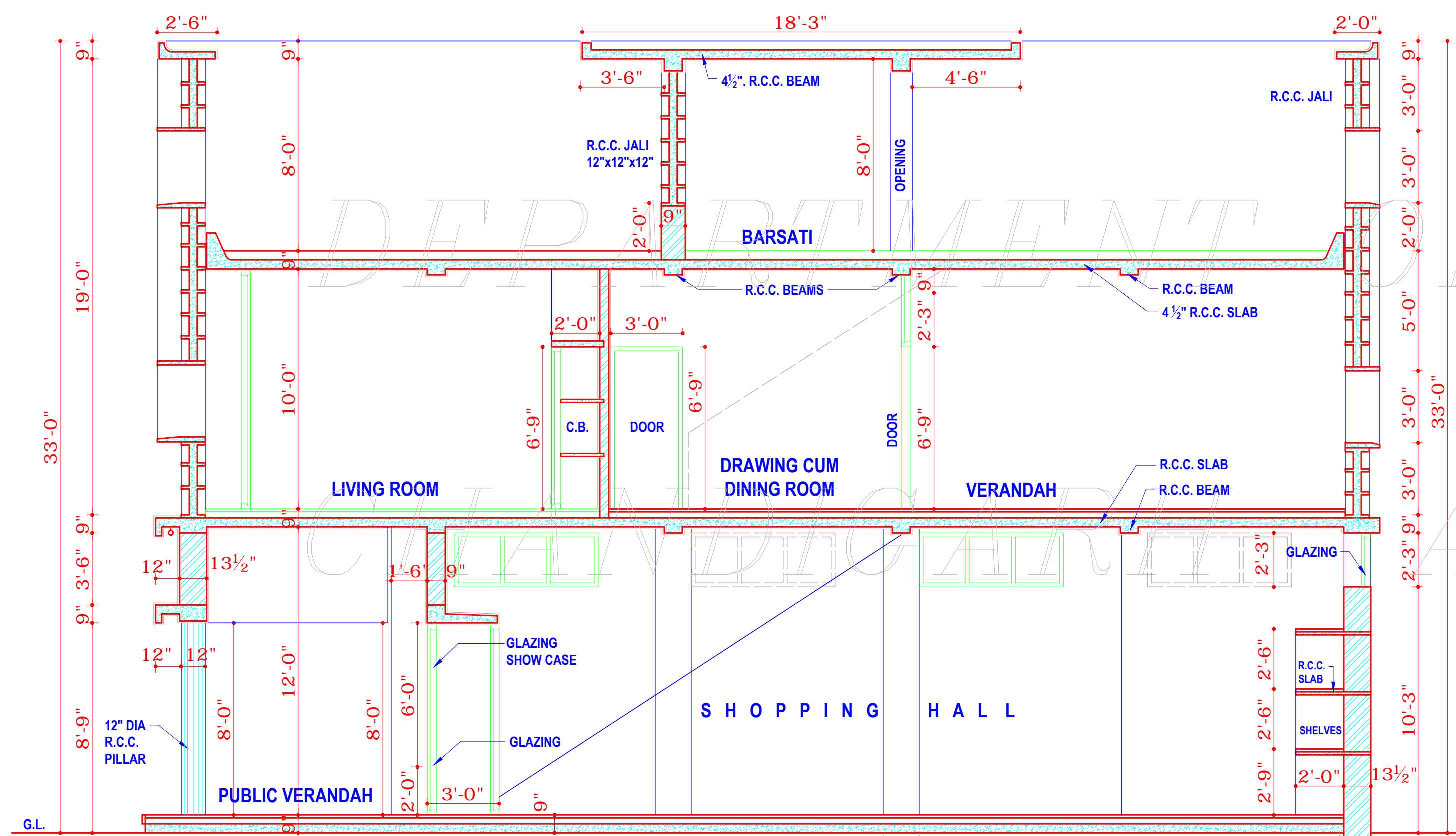

SECTION A.A.

BASEMENT ADJUSTMENT AT SITE ACCORDING TO DEPRESSION

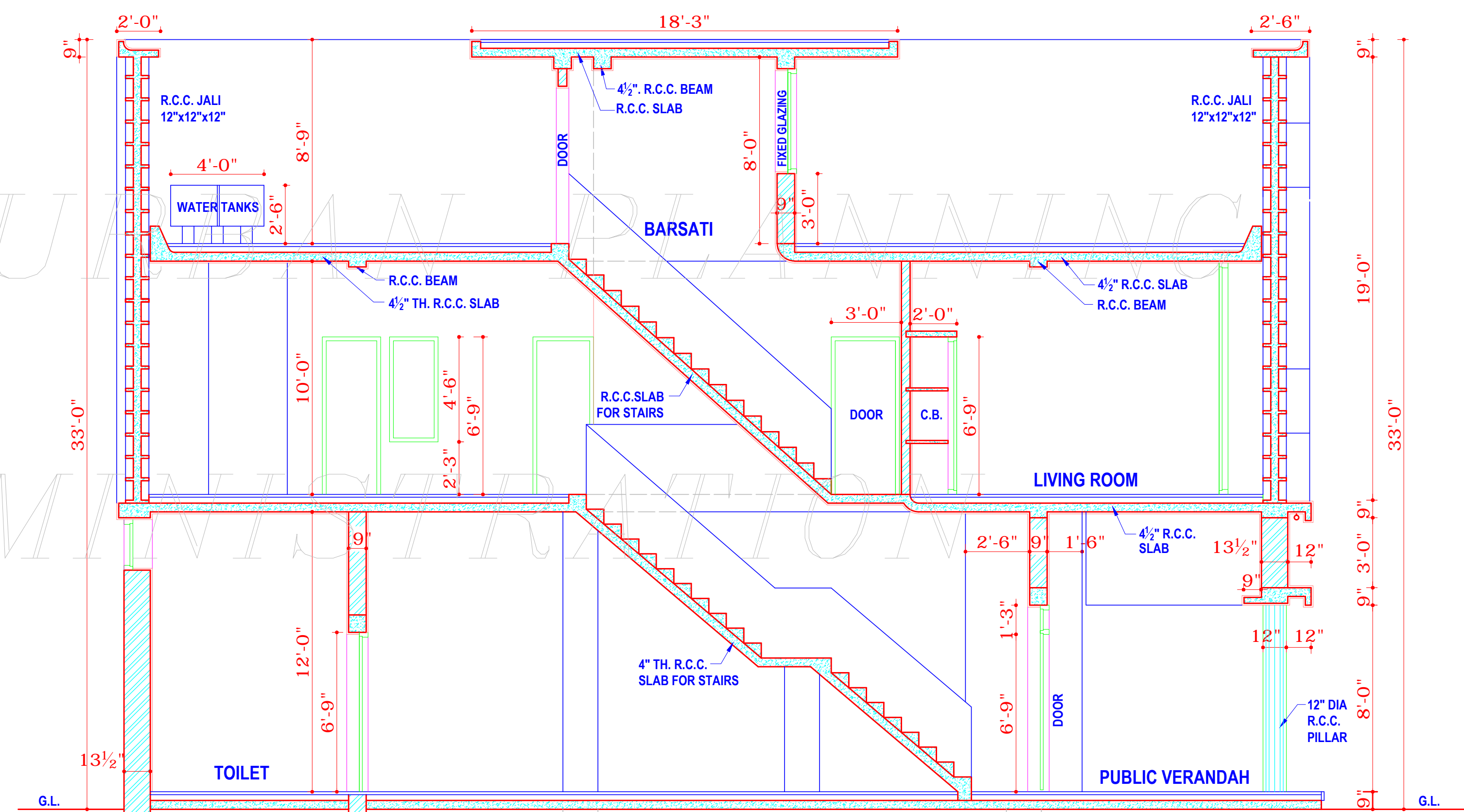

SECTION B.B.

BASEMENT ADJUSTABLE AT SITE AS PER DEPRESSION PERMITS

DISCLAIMER:-

THOUGH EVERY CARE HAS BEEN TAKEN TO PROVIDE THE CORRECT VERSION OF THE ARCHITECTURAL CONTROL ON THIS DIGITIZED (PDF) FORMAT, YET IN CASE OF ANY DISCREPANCY, THE MASTER COPY OF THE ARCHITECTURAL CONTROL APPLICABLE ON EACH SUCH SITE, AS AVAILABLE IN THE COMMERCIAL RECORD OF THE OFFICE OF CHIEF ARCHITECT OR HER/HIS INTERPRETATION WILL OVERRULE THE DIGITIZED FORMAT.

S.NO.	NOTES
1	THIS DRAWING IS THE PROPERTY OF THE ARCHITECTURE CHANDIGARH U.T. FORMERLY OF THE P.B. GOVT. & MUST NOT BE ALTERED, COPIED OR USED IN WHOLE OR IN PARTS WITHOUT THE PRIOR PERMISSION OF THIS DEPARTMENT IN WRITING.
2	THIS DRAWING IS ACTUALLY TRACED FROM DRG. NO. 3 JOB NO. 358 DATED 3.5.74.

S.NO.	DESCRIPTIONS
REVISIONS	

- sd - S.L. VERMA 5.10.70		
CHIEF ADMINISTRATOR		
- sd - M.N. SHARMA 28.9.70	- sd -	
CHIEF ARCHITECT	SENIOR ARCHITECT	
- sd - S.D. SHARMA ARCHITECT	- sd -	
ARCHITECT	ASSTT. ARCHITECT	

OFFICE OF THE CHIEF ARCHITECT CHANDIGARH.

SCALE :	DATE:
---------	-------

DRAWN BY	JOB NO.	DRG. NO.
K.L.	358	3

TWO BAY SHOP CUM FLATS SECTOR-16 D

SECTIONS