

DEPARTMENT OF  
ARCHITECTURE

- | S.NO. | NOTES.  |
|-------|---|
| 1.    | THIS DRAWING IS THE PROPERTY OF DEPTT. OF ARCHITECTURE CHANDIGARH AND MUST NOT BE COPIED, ALTERED OR USED IN PART OR IN WHOLE WITHOUT THE PRIOR APPROVAL OF THIS DEPARTMENT IN WRITING THERE OF.                    |
| 2.    | THE CONSTRUCTION OF THE BOOTHS BY INDIVIDUAL PLOT HOLDERS SHALL BE EXACTLY ACCORDING TO THE DRGS. SUPPLIED.   |
| 3.    | THE SPECIAL CARE MUST BE TAKEN TO ENSURE THAT THE FACIAS IN FRONT & THE REAR OF THE BOOTHS SHALL BE IN A STRAIGHT LINE AFTER THE COMPLETION OF TWO ANY ADJOINING BUILDINGS.   |
| 4.    | THE DIMENSIONS WRITTEN ON THE DRGS. SHALL BE CHECKED WITH THOSE OF ACTUAL CONSTRUCTION BY THE EXECUTIVE ENGINEER AND THE ARCHITECT AND ISSUE A CERTIFICATE BEFORE SANCTION OF THE ELECTRIC AND WATER CONSTRUCTIONS. |
| 5.    | THE CONSTRUCTION OF THESE SHOPPING BOOTHS SHALL BE SUPERVISED BY THE QUALIFIED ARCHITECT ONLY.  |

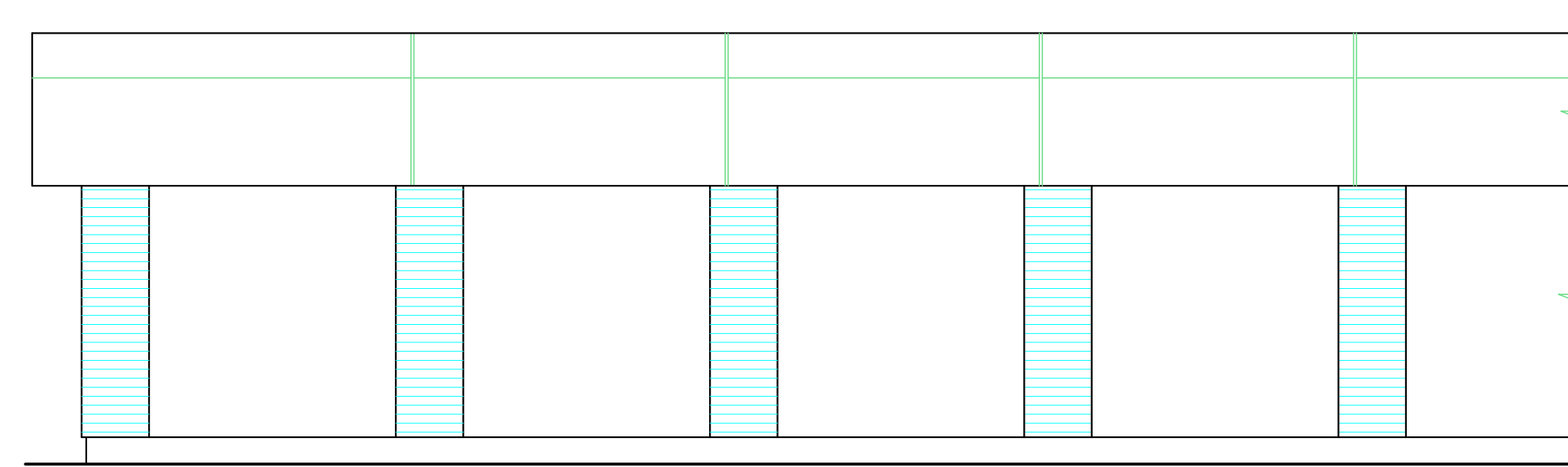

FRONT ELEVATION

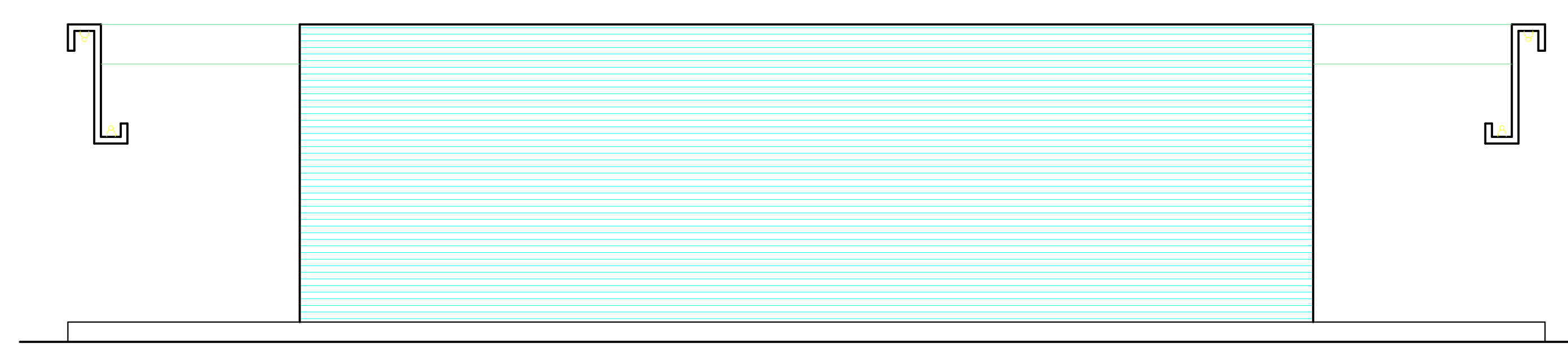

END ELEVATION

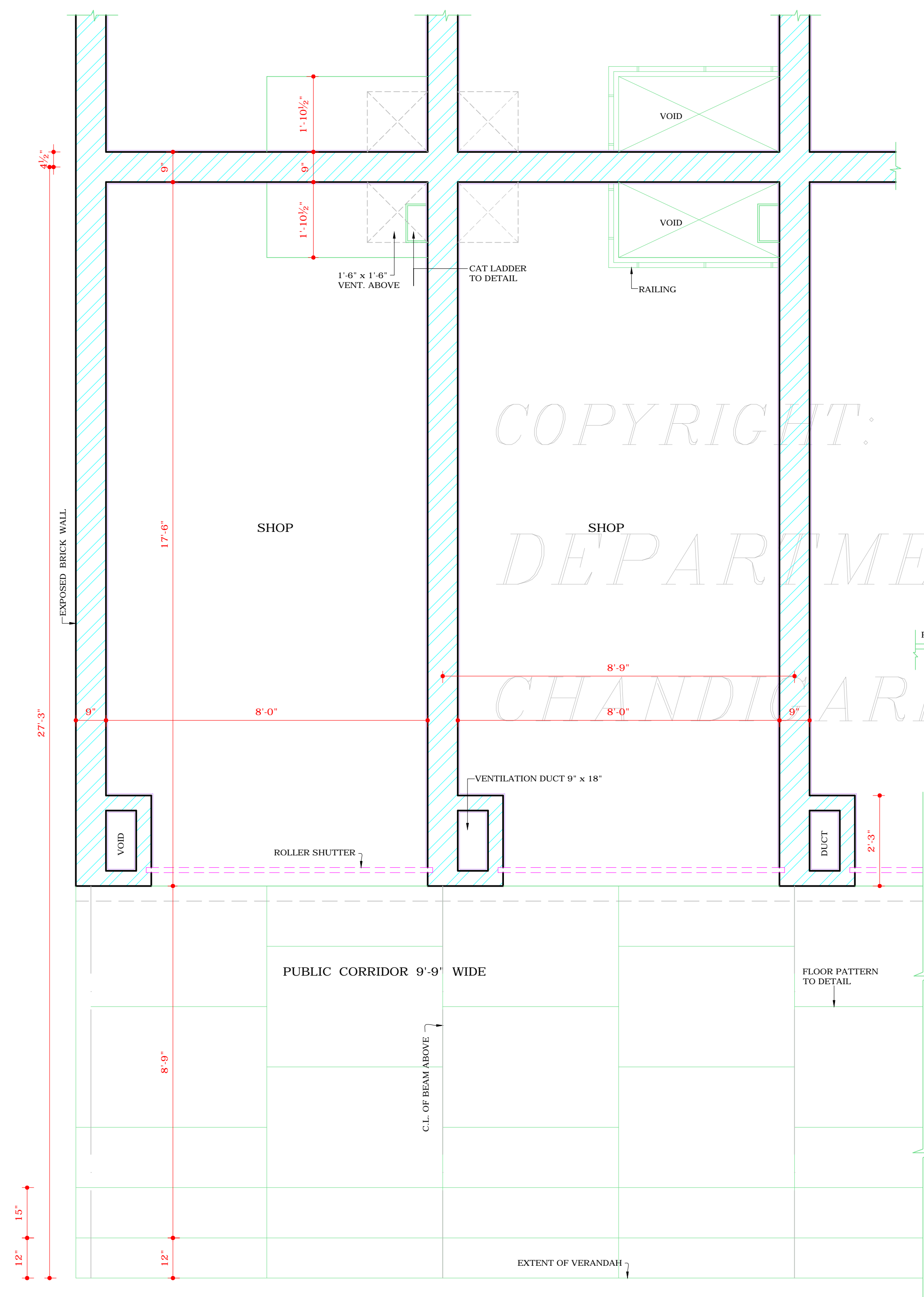

PLAN

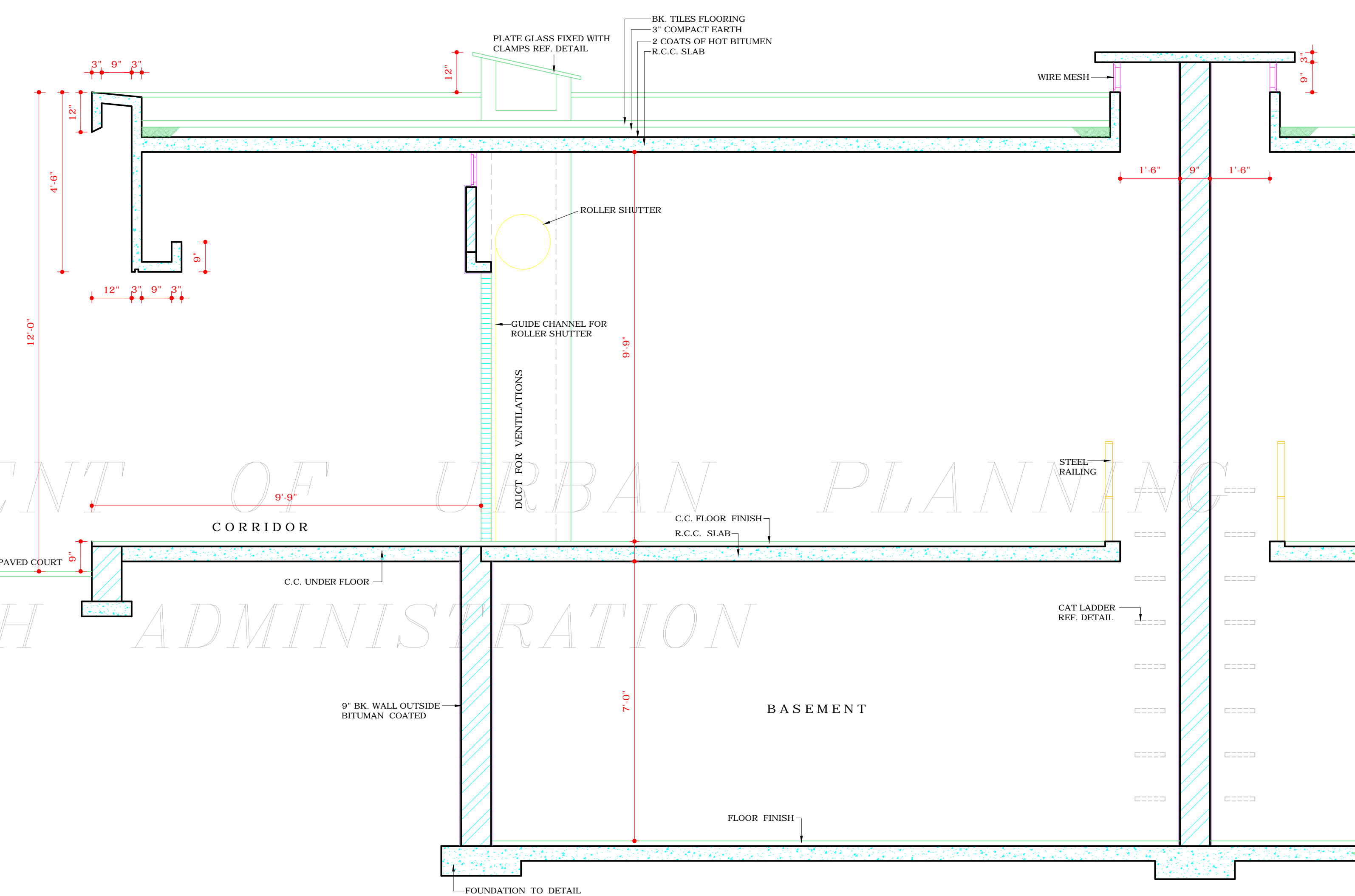

SECTION AT AA

**DISCLAIMER**  
THOUGH EVERY CARE HAS BEEN TAKEN TO PROVIDE THE CORRECT VERSION OF THE ARCHITECTURAL CONTROL ON THIS DIGITIZED (PDF) FORMAT, YET IN CASE OF ANY DISCREPANCY, THE MASTER COPY OF THE ARCHITECTURAL CONTROL APPLICABLE ON EACH SUCH SITE, AS AVAILABLE IN THE COMMERCIAL RECORD OF THE OFFICE OF CHIEF ARCHITECT OR HER/HIS INTERPRETATION WILL OVERRULE THE DIGITIZED FORMAT.

Sd/-  
S.L. VARMA  
24-9-70  
CHIEF ADMINISTRATOR

ATTESTED  
Sd/- IQBAL SINGH  
24-9-70

NOTE:-  
THIS DRAWING HAS BEEN COMPUTERISED ON  
25-02-09 FROM ORIGINAL DRG. NO.3, JOB NO. 440.

S.NO.	DESCRIPTION
	REVISED
Sd/- P. JENERET CHIEF ARCHITECT	Sd/- JEET MALHOTRA SENIOR ARCHITECT
Sd/- S.D. SHARMA ARCHITECT	Sd/- K.L. KUMAR ASSTT. ARCHITECT

OFFICE OF THE CHIEF  
ARCHITECT CHANDIGARH

SCALE :- 1/2" TO A FOOT  
1/4" TO A FOOT

DRAWN	DRG No.	JOB No.
REDRAWN V. KHANNA	3	440

SHOPPING CENTRE  
SECTOR - 16 D.

BOOTHS NOS. 45 TO 53  
62 TO 79