

NOTES

1. THIS DRG. IS THE PROPERTY OF THE DEPTT. OF URBAN PLANNING U.T. CHD. FORMERLY OF THE P.B. GOVT. AND MUST NOT BE ALTERED, COPIED OR USED IN WHOLE OR IN PART WITHOUT THE PRIOR PERMISSION OF THIS DEPTT. IN WRITING.
- PRELIMINARY
- a. THIS ZONING PLAN AND THE ARCHITECTURAL CONTROL SHEETS ARE ISSUED IN EXERCISE OF THE POWERS CONFERRED BY SECTION 4 OF THE CAPITAL OF P.B. (DEVELOPMENT & REGULATIONS) ACT, 1952 AND IS TO BE READ IN CONJUNCTION WITH THE BUILDING RULES MADE UNDER THE SAID ACT.
- b. THIS ZONING PLAN IS TO BE READ WITH THE LAYOUT PLAN DRG. No. 6, JOB No. 501.
- SITE COVERAGE
- a. THE MAXIMUM COVERED AREA ON ANY SITE SHALL NOT EXCEED THE AREA HATCHED AND CROSS HATCHED ON THIS PLAN FOR THAT PARTICULAR SITE.
- b. OPEN COURT OR COURTS OF ANY SHAPE AND SIZE WITHIN THE SINGLE STOREY ZONE ARE PERMISSIBLE PROVIDED THAT THE SHORTER SIDE OF SUCH COURT YARD IS NOT LESS THAN 15'-0" IN WIDTH.
- c. CANTILEVERED PORCH OF TWO BAY WIDTH AND PROJECTING NOT MORE THAN 12'-0" FROM THE FACE OF THE BUILDING MAY BE PERMITTED ALONG THE SOUTH FACADE OF THE SEVEN STOREY BLOCK AT ONE POINT ONLY.
- TYPE OF BUILDING PERMITTED
- TYPE OF BUILDINGS PERMITTED TO BE ERRECTED ON THE SITE SHALL BE BUILDINGS DESIGNED AND INTENDED TO BE USED FOR THE SPECIFIC PURPOSE OF A HOTEL FOR WHICH THE SITE IS LEASED OUT TO THE ALLOTTEE OR FOR USE AS MAY BE DEFINED OR EMPLOYED BY THE CHIEF ADMINISTRATOR & THEIR USE FOR ANY OTHER PURPOSE IS PROHIBITED. BUILDINGS PERMITTED TO BE ERRECTED OR RE-ERRECTED SHALL CONFORM TO THE FUNCTIONS OF THE INSTITUTION FOR WHICH THE SITE IS ALLOTTED AND SHALL INCLUDE ANY SUCH ANCLLARY OR COMPONENT BUILDINGS OR STRUCTURES AS ARE APPROVED BY THE CHIEF ARCHITECT / CHIEF ADMINISTRATOR.
- HEIGHTS
- a. THE PLINTH LEVEL SHALL BE AS DETERMINED BY THE CHIEF ARCHITECT FOR EACH BLOCK AND SHALL BE OBTAINED FROM HIM ON AN APPLICATION.
- b. EACH BLOCK SHALL BE ERRECTED TO ITS FULL HEIGHT IN ONE OPERATION AS IS STIPULATED IN THE TABLE BELOW.

S.No.	INDICATION	HT. ZONE	REMARKS
1.		SINGLE STOREY	OPTIONAL AND IF BUILT, IT SHALL BE BUILT, 15'-0" IN HT. INCLUSIVE OF PARAPET WHEN MEASURED ABOVE PLINTH.
		SEVEN STOREYS	COMPULSORY. IT SHALL BE BUILT TO A FULL VOLUME IN ONE OPERATION TO A HT. OF 85'-0" IN ACCORDANCE WITH DRG. No. 8 JOB No. 501.

CONTINUED ON DRG No. 8 JOB No. 501.

NOTE:- THIS DRAWING IS THE COMPUTERISED REPRODUCTION OF ORIGINAL DRG. NO.210 JOB NO. 501 DATED- 07-01-09

S.NO.	DESCRIPTION	SIGN	DATE
REVISIONS			

Sd/- S.K.MIDHA 3.8.95 CHIEF ARCHITECT	
Sd/- KANSIL 27.7.95 SENIOR ARCHITECT	Sd/- WADHAWAN 1.8.95 SENIOR TOWN PLANNER
Sd/- BALWINDER SAINI 27.7.95 ARCHITECT	Sd/- RASHIM GUPTA 26.7.95 ASSTT.ARCHITECT

OFFICE OF THE CHIEF ARCHITECT U.T. CHANDIGARH

SCALE = 32 FT. TO AN INCH DATE

Sd/- UMESH KAPOOR DRAWN	JOB NO. 501	DRG. NO. 210
----------------------------	----------------	-----------------

CHECKED BY  
ARCHITECTURAL CONTROL FOR THE HOTEL SITE (BLOCK No. 9) ALONG JAN MARG, SECTOR - 17.

SITE PLAN

SECTOR - 17

COPYRIGHT:

DEPARTMENT OF URBAN PLANNING

CHANDIGARH ADMINISTRATION

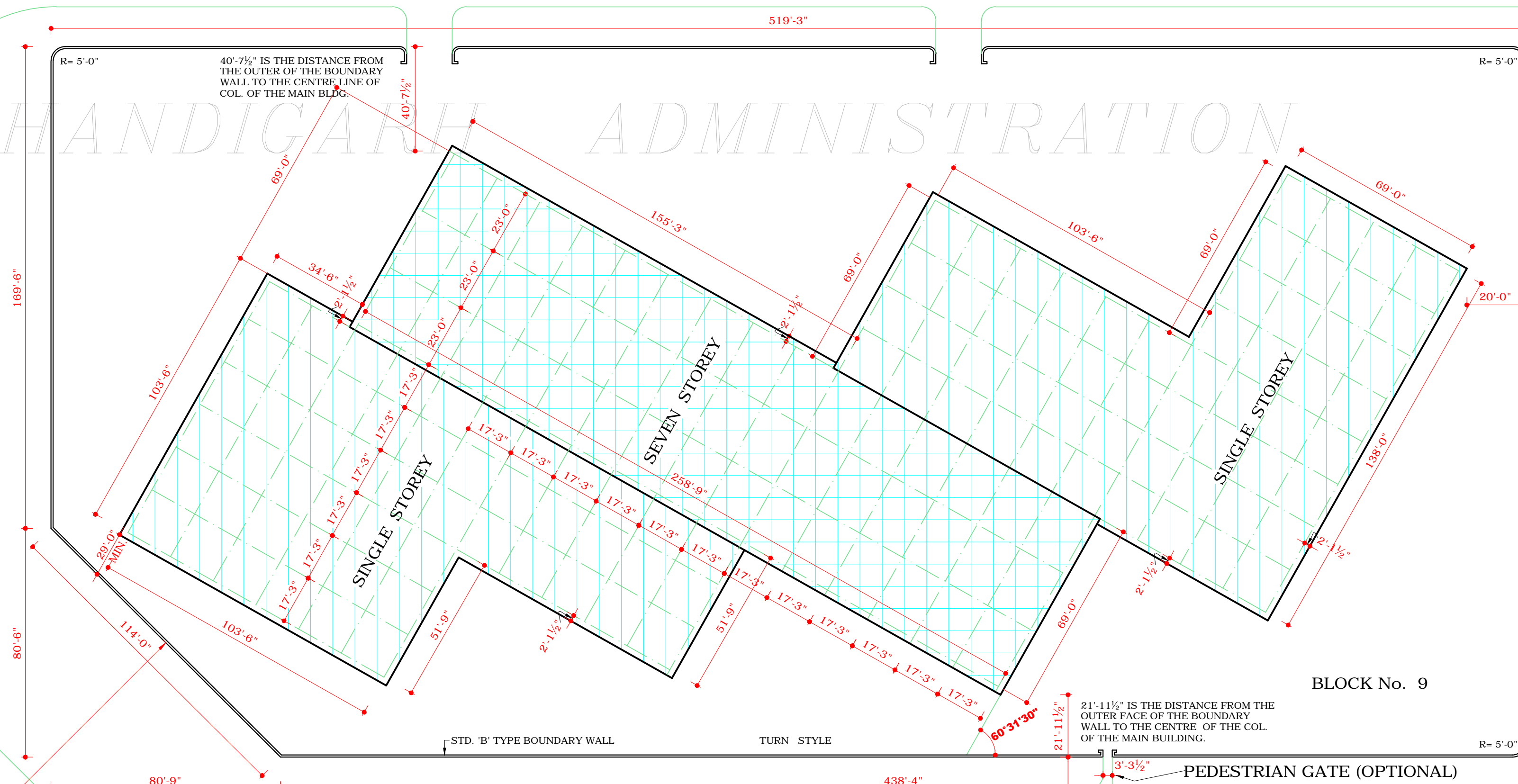

SLOW CARRIAGE WAY

GREEN VERGE

FAST CARRIAGE WAY

GREEN VERGE

FAST CARRIAGE WAY

ROSE GARDEN SECTOR - 16

DISCLAIMER  
THOUGH EVERY CARE HAS BEEN TAKEN TO PROVIDE THE CORRECT VERSION OF THE ARCHITECTURAL CONTROL ON THIS DIGITIZED (PDF) FORMAT, YET IN CASE OF ANY DISCREPANCY, THE MASTER COPY OF THE ARCHITECTURAL CONTROL APPLICABLE ON EACH SUCH SITE, AS AVAILABLE IN THE COMMERCIAL RECORD OF THE OFFICE OF CHIEF ARCHITECT OR HER/HIS INTERPRETATION WILL OVERRULE THE DIGITIZED FORMAT.

Sd/- CHIEF ADMINISTRATOR  
APPROVAL RECEIVED VIDE MEMO No. UTFI (4)- 96/10770 DATED 30-8-96

SECTOR - 9

C.L. OF MADHYA MARG

JN. No. 19

JAN MARG

C/L OF V2 CAPITAL

BLOCK No. 9