

S.No. NOTES

- THIS DRAWING IS THE PROPERTY OF THE DEPARTMENT OF ARCHITECTURE CHANDIGARH AND MUST NOT BE ALTERED, COPIED, OR USED IN WHOLE OR IN PART WITHOUT THE PERMISSION OF THE DEPARTMENT IN WRITING.
- THE CONSTRUCTION OF THESE SHOPPING BOOTHS SHALL BE SUPERVISED BY THE QUALIFIED ARCHITECT ONLY.
- THIS DRG. IS ACTUALLY TRACED FROM DRG. No. 1/R OF JOB No. 318 ON DATED 4-1-73

NIRMAL KUMARI  
4-1-73

NOTE:  
THIS DRAWING IS THE COMPUTERISED REPRODUCTION OF ORIGINAL DRG. No. 1/R OF JOB No. 318 DATED-08-04-09

REVISED

1-9-65

S.No. DESCRIPTION DATE SIGN

REVISIONS

SD. S.L. VARMA  
24-9-70  
CHIEF ADMINISTRATOR

SD- P.JENNRETT  
12-5-65  
CHIEF ARCHITECT

SD- J.S. DETHE  
10TH MAY.65  
SENIOR ARCHITECT

SD- O.P.MEHTA  
10-5-65  
ARCHITECT

ASSTT. ARCHITECT

OFFICE OF THE CHIEF ARCHITECT CHANDIGARH UNION TERRITORY.

SCALE = 1/8" = 1 FOOT

DATE:-

DRAWN SH. M.L. MADAN  
RE DRAWN NIRMAL KUMARI

JOB No. 318

DRG No. 1R

BOOTHS IN SECTOR 18-D

PLAN

DISCLAIMER

THOUGH EVERY CARE HAS BEEN TAKEN TO PROVIDE THE CORRECT VERSION OF THE ARCHITECTURAL CONTROL ON THIS DIGITIZED (PDF) FORMAT. YET IN CASE OF ANY DISCREPANCY, THE MASTER COPY OF THE ARCHITECTURAL CONTROL APPLICABLE ON EACH SUCH SITE, AS AVAILABLE IN THE COMMERCIAL RECORD OF THE OFFICE OF CHIEF ARCHITECT OR HER/HIS INTERPRETATION WILL OVERRULE THE DIGITIZED FORMAT.

ATTESTED AS TRUE COPY

Sd/ KUREKAR  
ASSIST. ARCHITECT

CENTRE LINE OF V4 STREET A

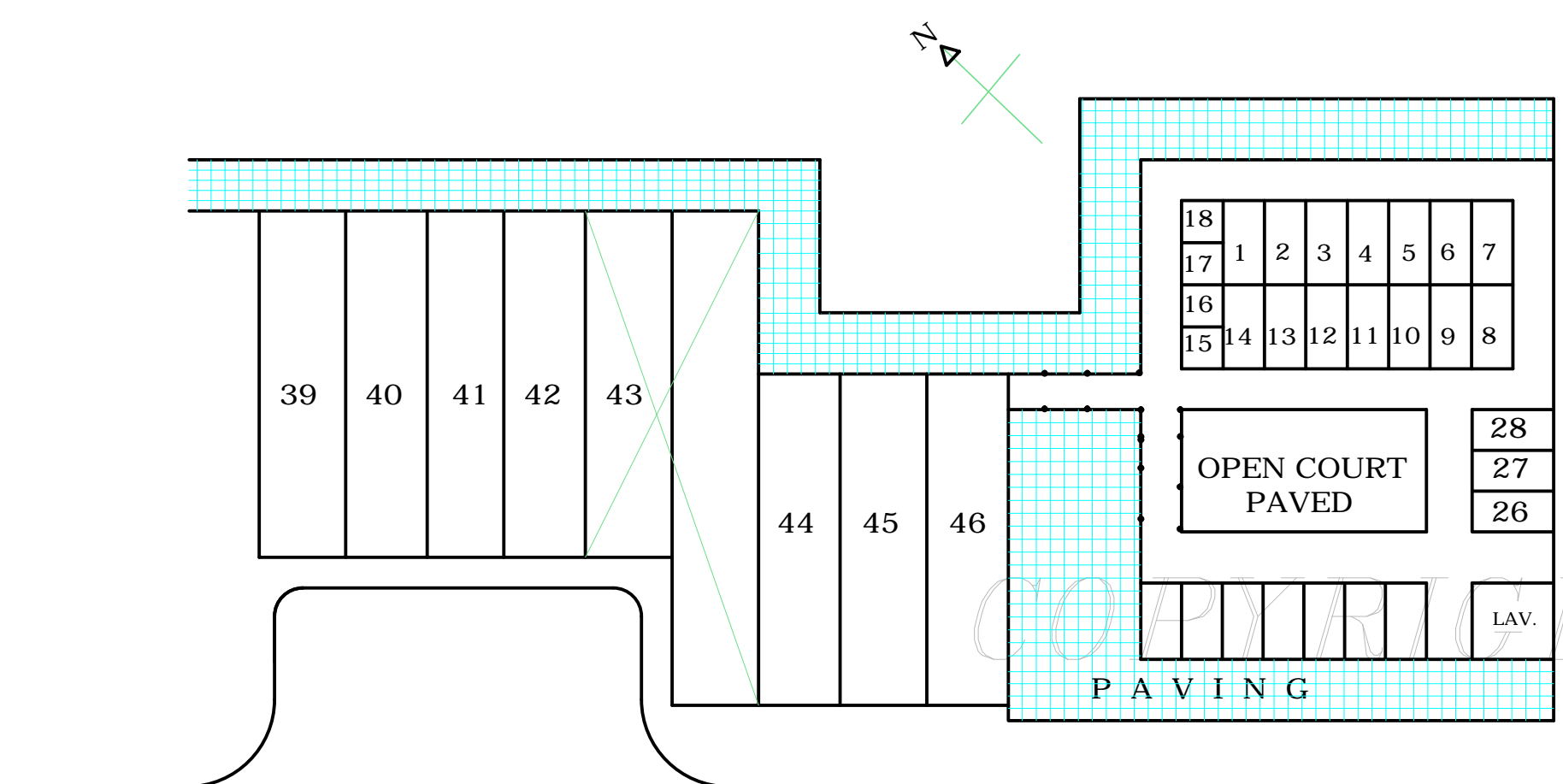

KEY PLAN  
SCALE 3/2" = 1 INCH

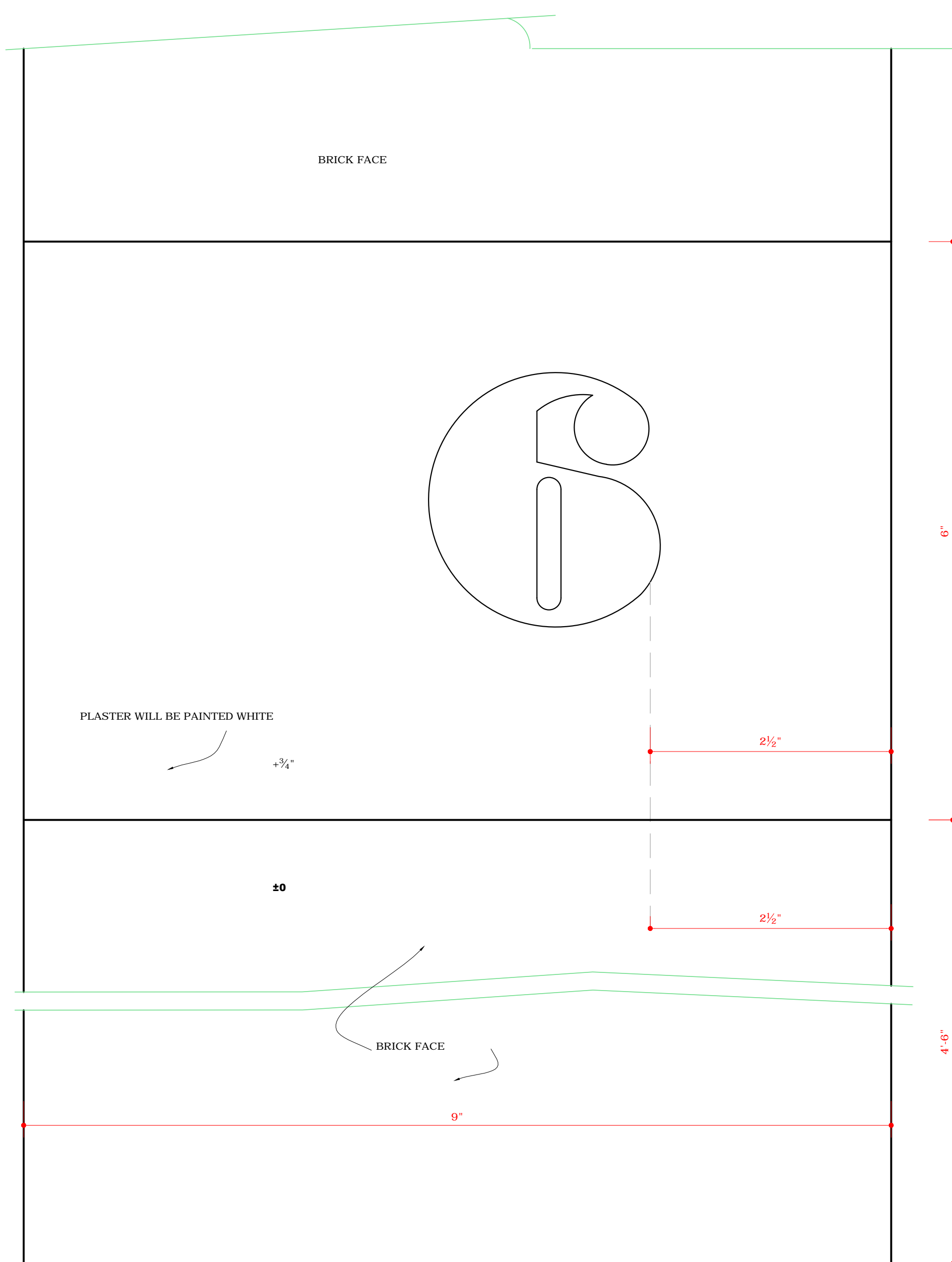

DEPARTMENT OF URBAN CHANDIGARH ADMINISTRATION

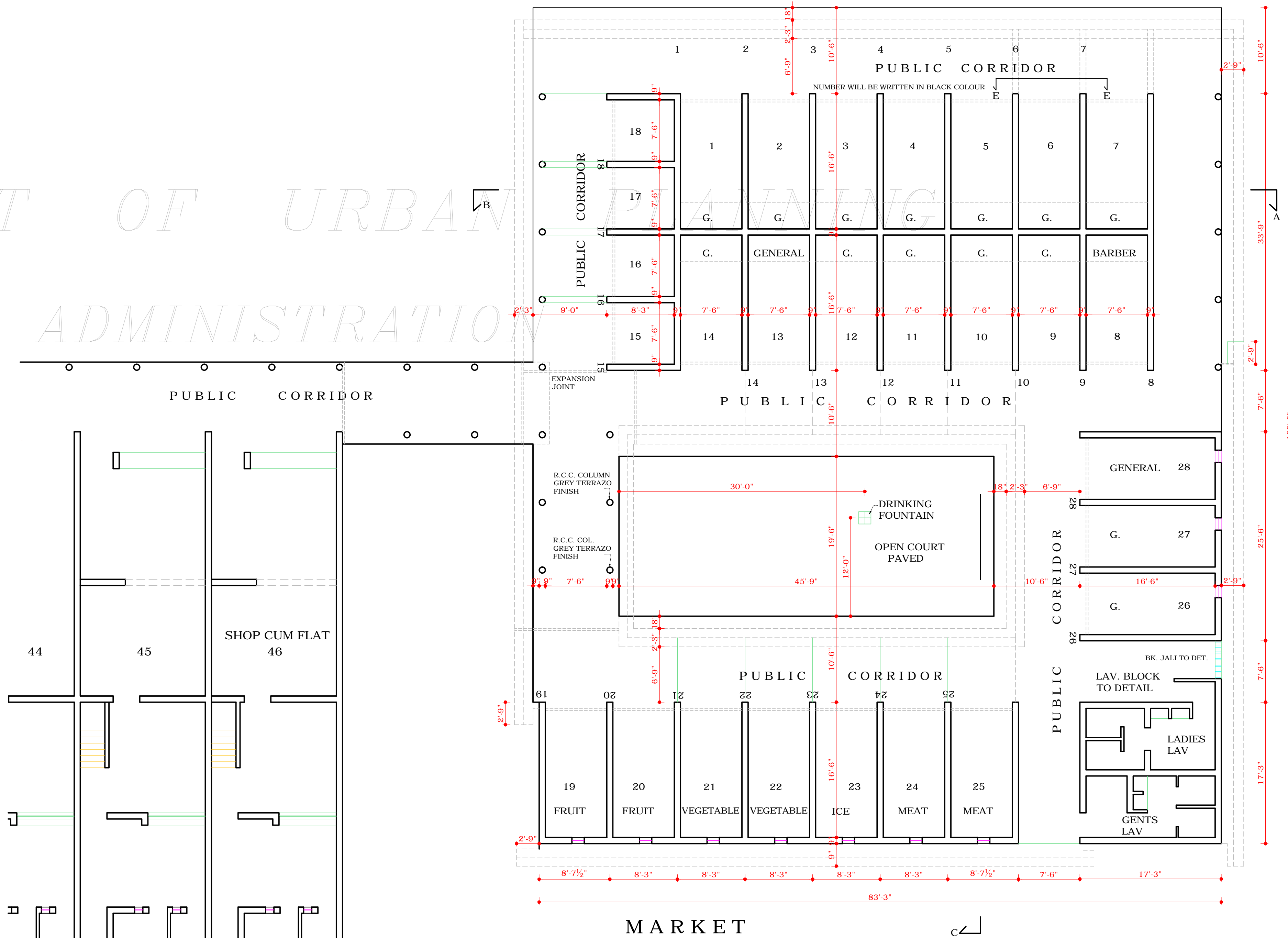

SHOP CUM FLATS

MARKET

DISCLAIMER

THOUGH EVERY CARE HAS BEEN TAKEN TO PROVIDE THE CORRECT VERSION OF THE ARCHITECTURAL CONTROL ON THIS DIGITIZED (PDF) FORMAT. YET IN CASE OF ANY DISCREPANCY, THE MASTER COPY OF THE ARCHITECTURAL CONTROL APPLICABLE ON EACH SUCH SITE, AS AVAILABLE IN THE COMMERCIAL RECORD OF THE OFFICE OF CHIEF ARCHITECT OR HER/HIS INTERPRETATION WILL OVERRULE THE DIGITIZED FORMAT.

ATTESTED AS TRUE COPY

Sd/ KUREKAR  
ASSIST. ARCHITECT