

DEPARTMENT OF ARCHITECTURE

ADDITIONAL SIGN BOARD
EXISTING ADVERTISEMENT PANEL
APPROVAL FOR ADDITIONAL SIGN BOARD SPACE

Sd/- SUNITA MONGA
CHIEF ARCHITECT.
Sd/- BALVINDER SAINI
SENIOR ARCHITECT.
Sd/- SANJEEV SHARMA
ARCHITECT.
Sd/- DAMINDER VIRDI
ASSTT. ARCHITECT.

S.No. NOTES.

- THIS DRG. IS THE PROPERTY OF THE DEPTT. OF ARCHITECTURE CHANDIGARH AND MUST NOT BE ALTERED, COPIED OR USED IN WHOLE OR IN PART WITHOUT THE PERMISSION OF THIS DEPTT. IN WRITING.
 - THIS DRG. IS TO BE READ WITH DRG. No. 48, 49, 50, 51, & 53 OF JOB No. 32-C.
 - THIS DRG. IS BASED & TRACED FROM DRG. No. 5 PREPARED IN 1959.
 - THIS DRG. SUPERCEDES DRG. No. 5 OF JOB 32-C. REVISIONS MADE VIDE FINANCE SECRETARY (CHANDIGARH ADMINISTRATION) MEMO No. 3967 U.T.F.I. (4) 89/780 DATED 25-7-89 FOR THE PROVISIONS OF TOILET FACILITIES.
 - Sd/- 2-8-89 ARCHITECT
- THE ADDITIONAL SIGN BOARDS SHALL BE ALLOWED ONLY SUBJECT TO THE PAYMENT OF CHARGES AS DECIDED BY THE ADMINISTRATION/ MUNICIPAL CORPORATION CHD.
 - THE ADDITIONAL ADVERTISEMENTS PANELS/SIGN BOARDS (A) & (D), ALLOWED ON PAYMENT BASIS SHALL NOT BE PAINTED ON THE EXPOSED BRICK SURFACE OR ON PLASTERED SURFACE, BUT SHALL BE PROVIDED AS SEPARATE FABRICATED PANELS IN METAL OR ACRYLIC ETC. THE STRUCTURAL STABILITY & FIXING OF THE SAME SHALL BE STRICTLY ENSURED AT SITE FOR THE PUBLIC SAFETY.
 - ALL EXISTING ADVERTISEMENT PANELS SHALL BE AS PER ARCHITECTURAL CONTROL SHEETS.
 - THE ADDITIONAL SIGN BOARDS MAY BE FABRICATED IN PARTS OR IN FULL SUBJECT TO THE STRUCTURAL STABILITY OF THE SIGN BOARD.
 - THE ADDITIONAL ADVERTISEMENT PANELS AS SHOWN IN THE DRG. ARE TO BE PROVIDED ONLY IN CASE OF S.C.O.S. OR SUCH SITES WHERE S.C.F.S ARE CONVERTED INTO S.C.O.S. IN ACCORDANCE WITH THE TERM & CONDITION OF NOTIFICATION No. 2722 UTTI (3)-88/7623 DATED 20-5-88.

IN PURSUANCE TO THE APPROVAL OF THE CHIEF ADMINISTRATOR ON FILE DATED 25-7-07.
Sd/- (SUNITA MONGA) 30.7.07
CHIEF, ARCHITECT.
EXERCISING THE POWERS OF THE CHIEF ADMINISTRATOR
CHIEF ADMINISTRATOR
CHANDIGARH ADMINISTRATION

DETAIL OF SIZES & AREAS OF ADVERTISEMENT PANELS/SIGN BOARDS

SR.No.	WIDTH	HEIGHT	MAXIMUM THICKNESS	DISTANCE FROM BUILDING LINE	AREA	NUMBER OF PANELS FRONT REAR
(A)	13'-0"	3'-9"	0'-4"	NIL	48.75	1 NIL
(B)	13'-0" EXISTING	AS PER EXISTING	0'-4"	NIL	AS PER EXISTING	1 NIL
(D)	4'-0"	4'-0"	0'-4"	NIL	16.0	1 NIL
(D1)	8'-3"	2'-3"	0'-4"	NIL	18.562	1 NIL

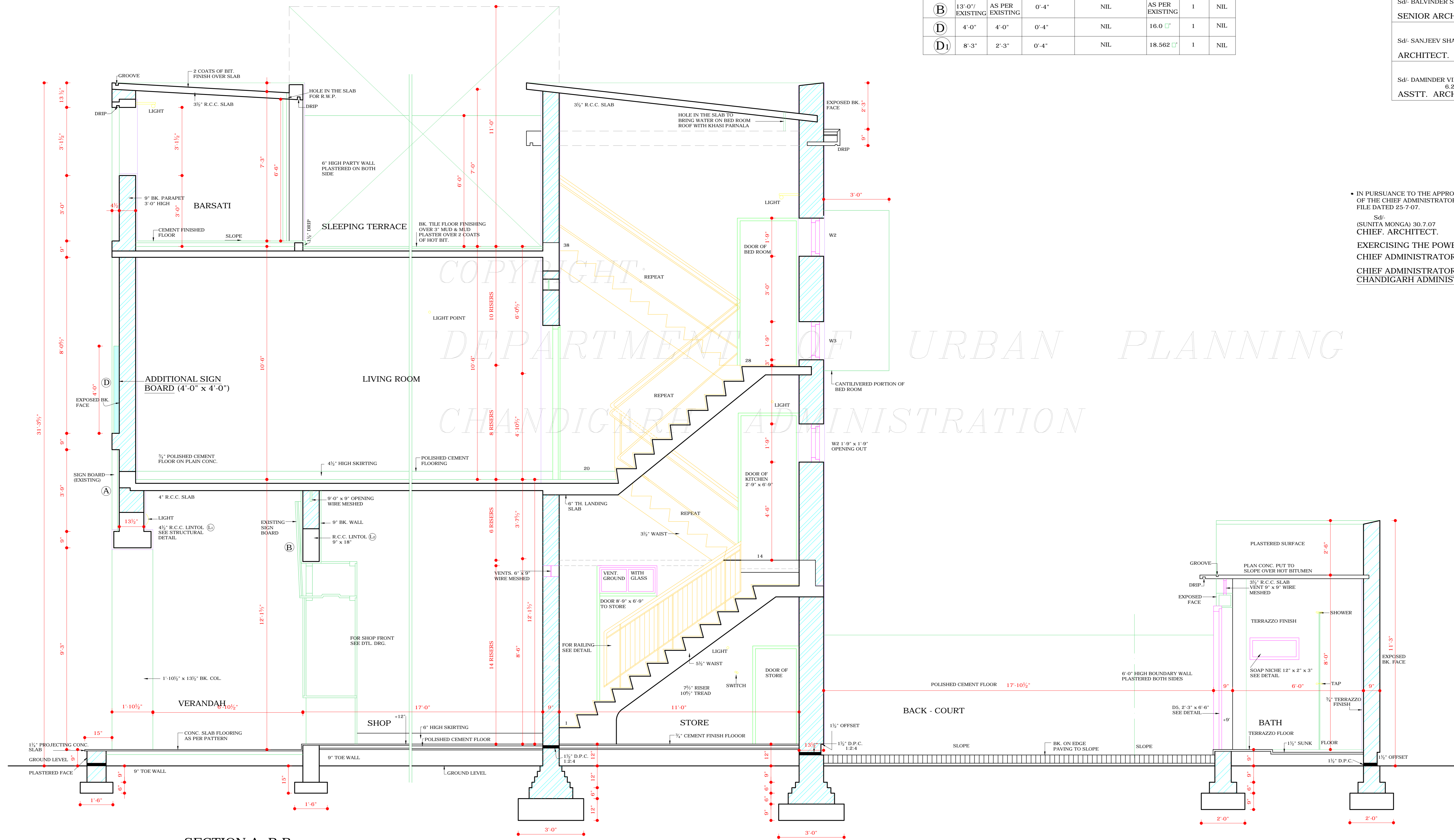

SECTION A: B-B

NOTE:- THIS DRAWING IS THE COMPUTERISED REPRODUCTION OF ORIGINAL DRG. NO. 52 JOB No. 32-C DATED- 08-04-09

S.No. DESCRIPTION

REVISIONS

CHIEF ARCHITECT. SENIOR ARCHITECT.

Sd/- R.S. LAL ARCHITECT. Sd/- JADISH SINGH ARCHITECT.

OFFICE OF THE CHIEF ARCHITECT CHANDIGARH

SCALE = 1/2" INCH TO A FOOT DATE -
DRAWN DRG. No. 52 JOB No. 32-C
Sd/- CHECKED

REVISED SCHEME FOR SHOPPING CENTRES IN SECTORS 8, 9, 18, 19 STD, SHOPS & FLATS.

SECTION B-B

DISCLAIMER

THOUGH EVERY CARE HAS BEEN TAKEN TO PROVIDE THE CORRECT VERSION OF THE ARCHITECTURAL CONTROL ON THIS DIGITIZED (PDF) FORMAT, YET IN CASE OF ANY DISCREPANCY, THE MASTER COPY OF THE ARCHITECTURAL CONTROL APPLICABLE ON EACH SUCH SITE, AS AVAILABLE IN THE COMMERCIAL RECORD OF THE OFFICE OF CHIEF ARCHITECT OR HERHIS INTERPRETATION WILL OVERRULE THE DIGITIZED FORMAT.

Sd/- JUNIOR ARCHITECT

ATTESTED
Sd/- KUREKAR 24.4.72
ASSTT. ARCHITECT.

Sd/- P.L. VERMA
S.L.C. & CHIEF ENGINEER