



SECOND FLOOR PLAN

IN PURSUANCE TO THE APPROVAL OF THE CHIEF ADMN. ON FILE DT. 5.11.07
SD: SUNITA MONGA
CHIEF ARCHITECT
CHIEF ADMINISTRATOR
CHANDIGARH ADMN.

APPROVAL OF THE CHIEF ADMINISTRATOR FOR THE REVISION OF CLAUSE 21. RECEIVED VIDE HIS OFFICE. MEMO NO. 1842, U.T.F.I (4)-89/6012 DATED. 9. 6. 89. Sd: 7. 8. 89 CHIEF ADMINISTRATOR.

APPROVAL OF THE CHIEF ADMINISTRATOR RECEIVED VIDE HIS OFFICE MEMO NO. 235 UTFI (2) 87 / DATED 11. 2. 87.

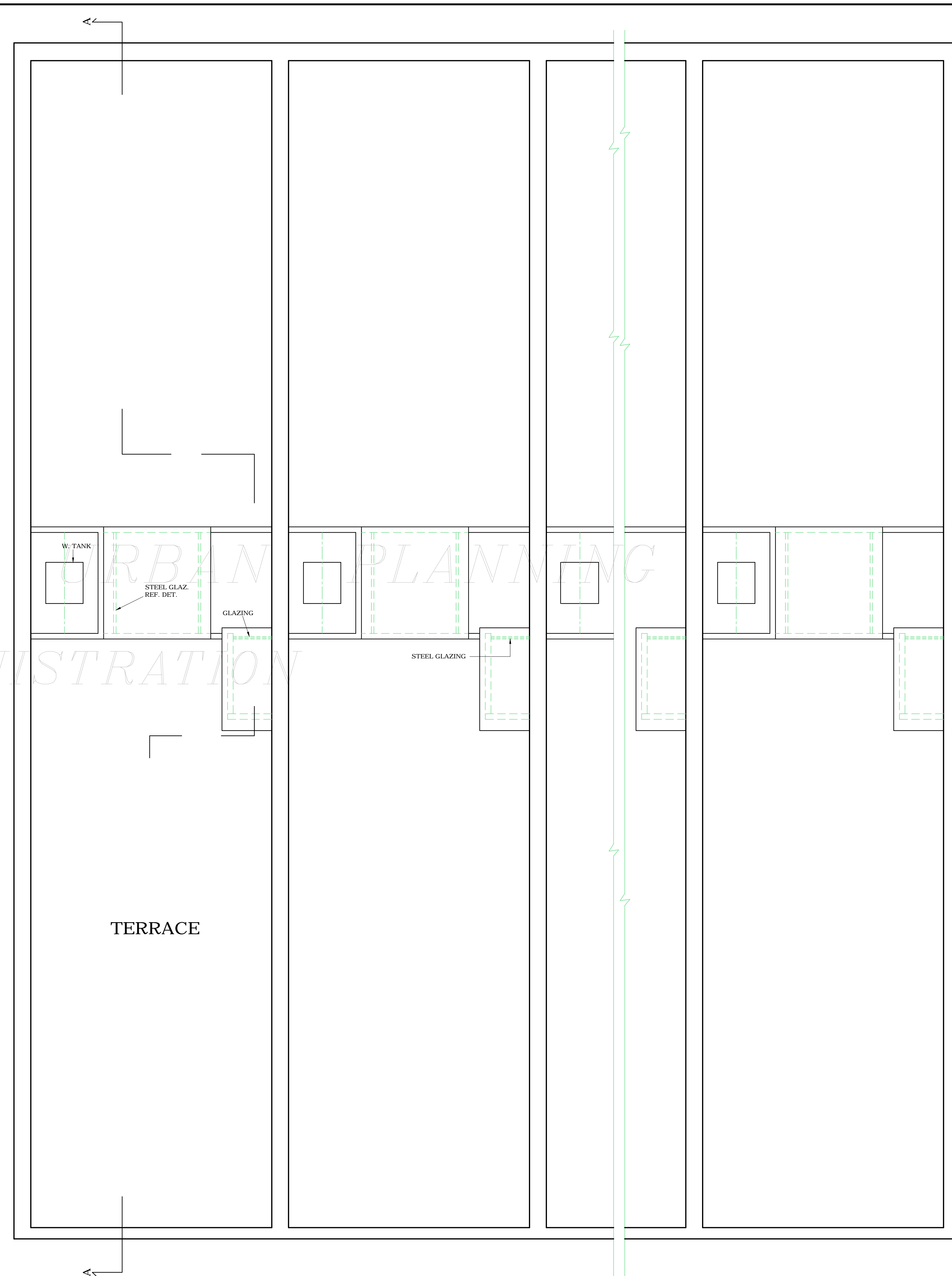

TERRACE FLOOR PLAN

DISCLAIMER
THOUGH EVERY CARE HAS BEEN TAKEN TO PROVIDE THE CORRECT VERSION OF THE ARCHITECTURAL CONTROL ON THIS DIGITIZED (PDF) FORMAT. YET IN CASE OF ANY DISCREPANCY, THE MASTER COPY OF THE ARCHITECTURAL CONTROL APPLICABLE ON EACH SUCH SITE, AS AVAILABLE IN THE COMMERCIAL RECORD OF THE OFFICE OF CHIEF ARCHITECT OR HER/HIS INTERPRETATION WILL OVERRULE THE DIGITIZED FORMAT.

APPROVAL OF THE CHIEF ADMINISTRATOR RECEIVED VIDE HIS OFFICE MEMO NO. 9597-UTFI (2) 78/713 DATED 12-1-79

ATTESTED
Sd: PRAN NATH
2.3.79
ASSTT ARCHITECT
THIS DRG. IS TRACING OF
DRG.NO. 2 JOB NO 1062

DEPARTMENT OF ARCHITECTURE U.T.

- | S.NO. | NOTES. |
|---|--|
| 1. | THIS DRAWING IS THE PROPERTY OF DEPARTMENT OF ARCHITECTURE U.T. CHANDIGARH AND MUST NOT BE ALTERED COPIED OR USED IN WHOLE OR IN PART WITHOUT THE PERMISSION OF THIS DEPTT. IN WRITING. |
| 2. | THIS DRAWING IS TO BE READ WITH DRAWING NOS. 1 TO 4 OF JOB NO. 1062. |
| CONT. FROM DRG.NO. 1 | |
| 9. | NO RAIN WATER, SOIL VENTILATING OR ANY OTHER PIPE SHALL BE PERMITTED ON THE EXTERNAL FACADE OF THE BUILDING ALL SUCH PIPES IN THE BUILDING OTHER THAN THE FACADE SHALL BE PROPERLY ENCASED. |
| 10. | (A) ELECTRIC TELEPHONE AND OTHER SUCH CONNECTIONS SHALL BE TAKEN FROM THE PUBLIC SUPPLY LINE FROM UNDER THE GROUND AND SHALL BE SHOWN ON THE DRGS. FOR APPROVAL. (B) ALL ELECTRIC WIRING SHALL BE THROUGH CONDUIT IN THE WALLS & SLABS. NO SURFACE WIRING SHALL BE PERMITTED AT ANY PLACE. |
| 11. | NO SUB DIVISION OF SHOP IS ALLOWED. |
| 12. | NO ADVERTISEMENT SHALL BE ALLOWED IN SPACES OTHER THAN THE ONE STIPULATED IN THE DRAWING. |
| 13. | THE STRUCTURAL SIZES ARE INDICATIVE AND THE FINAL RESPONSIBILITY FOR THE STABILITY OF THE STRUCTURE IS THAT OF THE OWNER. |
| 14. | EXTERNAL DOORS, WINDOWS, GRILL, SHUTTERS ETC. SHALL BE PAINTED IN GREY COLOUR OF I.S.I 683 ONLY.
CONT. ON DRG.NO. 3 |
| NOTE:- THIS DRAWING IS THE COMPUTERISED REPRODUCTION OF ORIGINAL DRG. NO.2 JOB NO. 1062 DATE: 19-8-08 | |

S.NO.	DESCRIPTION	SIGN	DATE
REVISIONS			
Sd: ON 8-1-79 CHIEF ADMINISTRATOR CHANDIGARH U.T.			
Sd: M.N.SHARMA CHIEF ARCHITECT.	Sd: H.S.CHOPRA SENIOR ARCHITECT.		
Sd: S.N.KOHLI ARCHITECT.	Sd: P.N. SEKHRI ASSTT. ARCHITECT.		

OFFICE OF THE CHIEF ARCHITECT CHANDIGARH

SCALE = 1/4 INCH TO A FOOT DATE : 11.9.78

TARVINDER CHECKED BY DRAWN BY P.S.SACHIDANA TRACED BY SURINDER	JOB NO. 1062	DRG NO. 2
--	-----------------	--------------

WHOLE - SALE CLOTH MARKET ON DAKHNA MARG, SECTOR 20

SECOND FLOOR AND TERRACE FLOOR PLAN