

DEPARTMENT OF ARCHITECTURE

1. THIS DRG. IS THE PROPERTY OF THE DEPTT. OF ARCHITECTURE, CHANDIGARH U.T. AND FORMERLY OF THE GOVT. OF PUNJAB AND MUST NOT BE ALTERED, COPIED OR USED IN WHOLE OR IN PART WITHOUT THE PERMISSION OF THIS DEPTT. IN WRITING.
2. THIS DRG. IS ACTUALLY TRACED FROM DRG. No. 3 OF JOB No. 247 ON DATED 4.X.72

Sd/-
4.X.72

NOTE:
THIS DRAWING IS THE COMPUTERISED REPRODUCTION OF ORIGINAL DRG. No. 3 OF JOB No. 247 DATED: 19-05-09

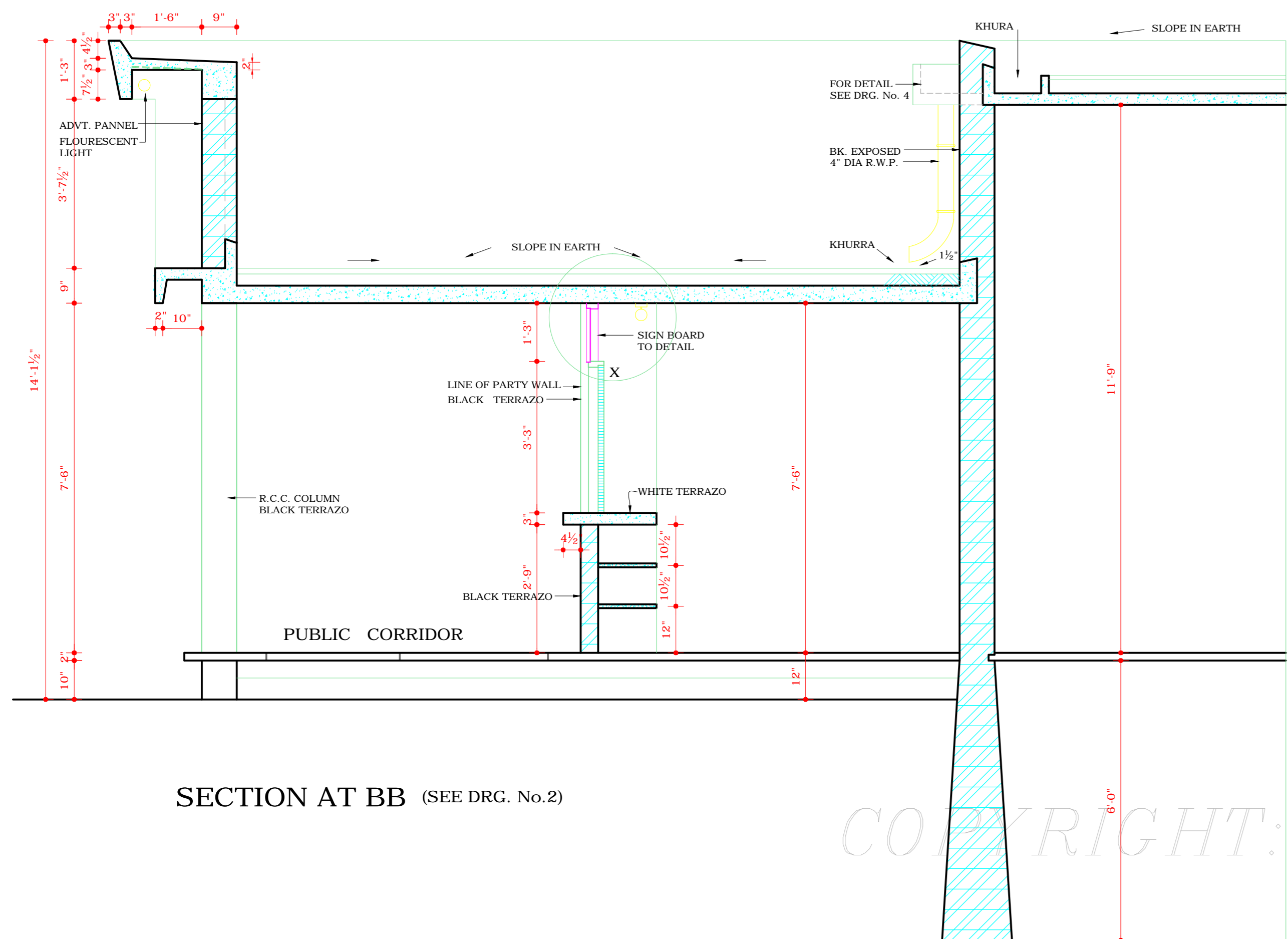

SECTION AT BB (SEE DRG. No.2)

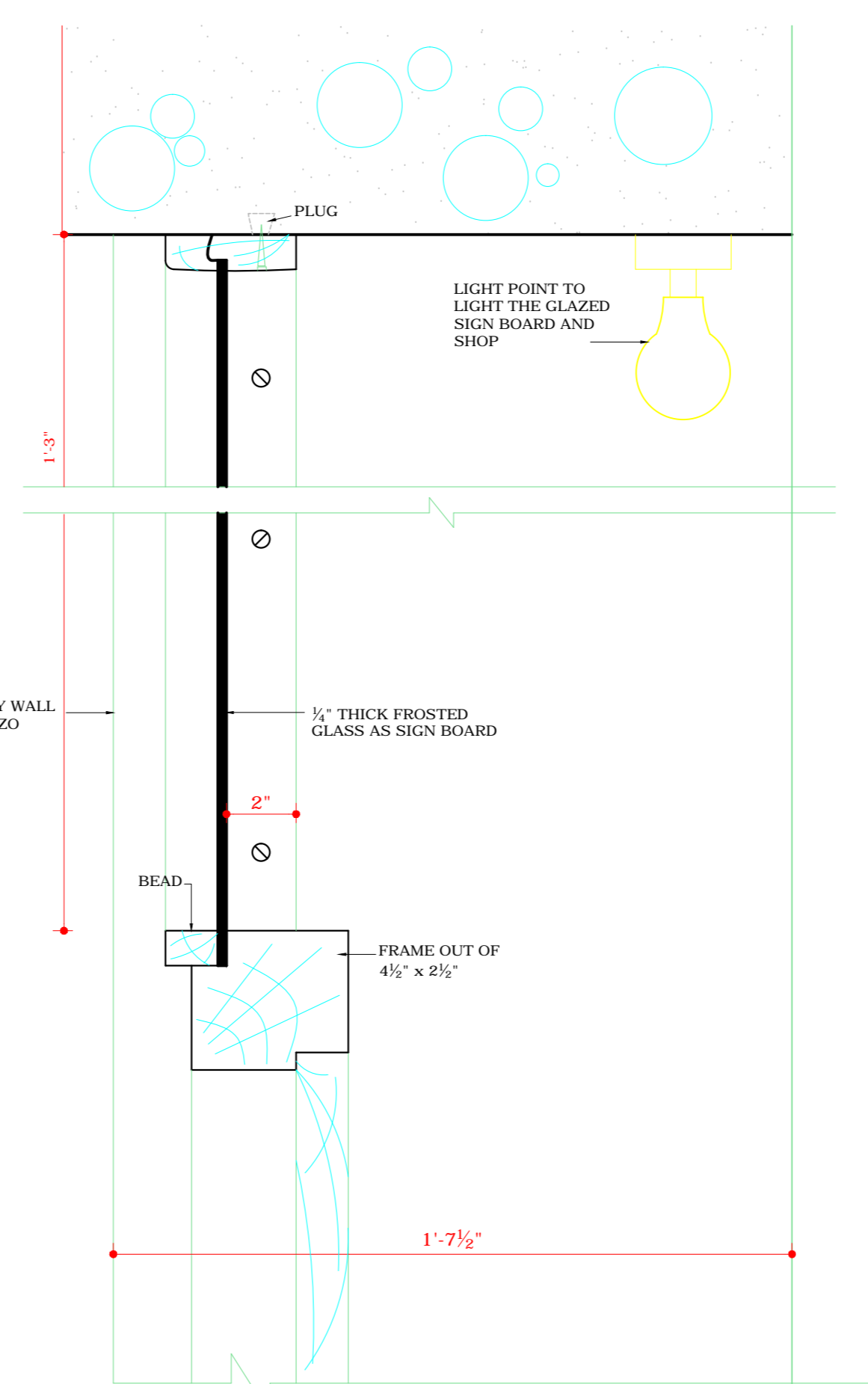

1/4" F.S. DETAIL AT X

COPYRIGHT:
DEPARTMENT OF URBAN PLANNING
CHANDIGARH ADMINISTRATION

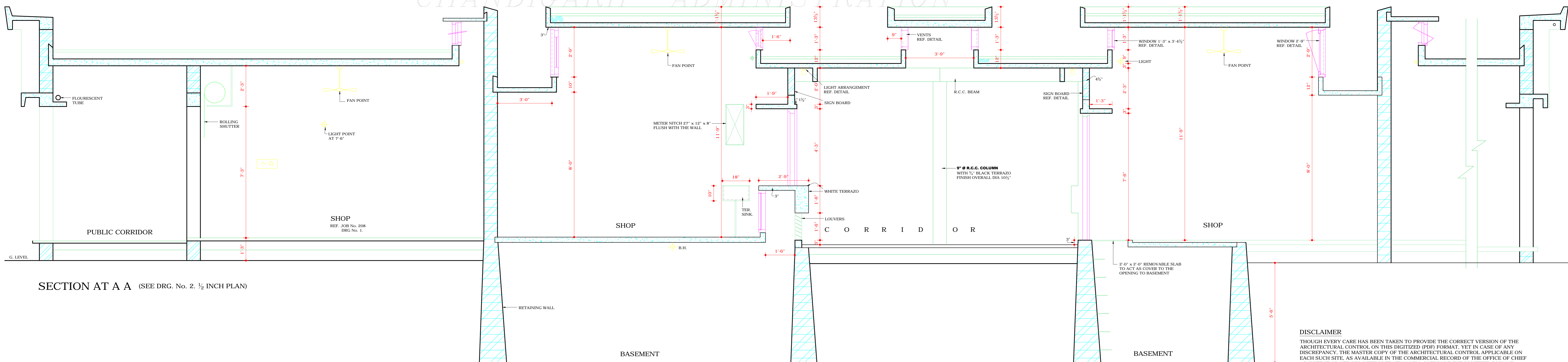

SECTION AT A A (SEE DRG. No. 2. 1/2 INCH PLAN)

DISCLAIMER
THOUGH EVERY CARE HAS BEEN TAKEN TO PROVIDE THE CORRECT VERSION OF THE ARCHITECTURAL CONTROL ON THIS DIGITIZED (PDF) FORMAT. YET IN CASE OF ANY DISCREPANCY, THE MASTER COPY OF THE ARCHITECTURAL CONTROL APPLICABLE ON EACH SUCH SITE, AS AVAILABLE IN THE COMMERCIAL RECORD OF THE OFFICE OF CHIEF ARCHITECT OR HER/HIS INTERPRETATION WILL OVERRULE THE DIGITIZED FORMAT.

S.L.VERMA
19-9-70
CHIEF ADMINISTRATOR

P. JEANERET
2-6-60
CHIEF ARCHITECT & CHIEF TOWN PLANNER
ATTESTED
Sd/- KUREKAR
10.10.72
ARCHITECT

OFFICE OF THE CHIEF ARCHITECT CHANDIGARH. U.T.

SCALE - 1/2 INCH TO A FOOT DATE

DRAWN Sd/- 3rd oct. 1972
SADRU SINGH

DRG. No. 3
JOB No. 247

BOOTHS SECTOR - 21 SECTIONS.