

DEPARTMENT OF ARCHITECTURE, U.T.

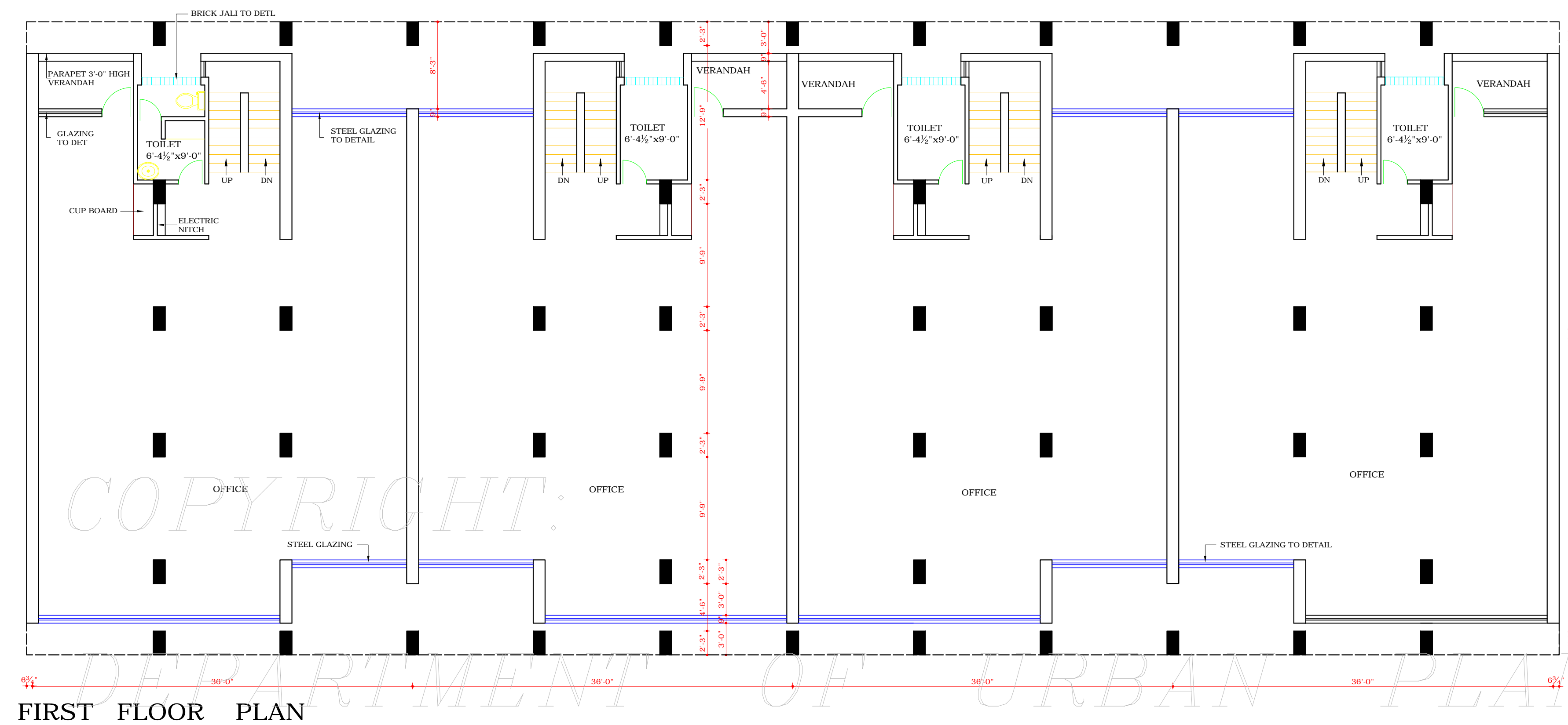

FIRST FLOOR PLAN

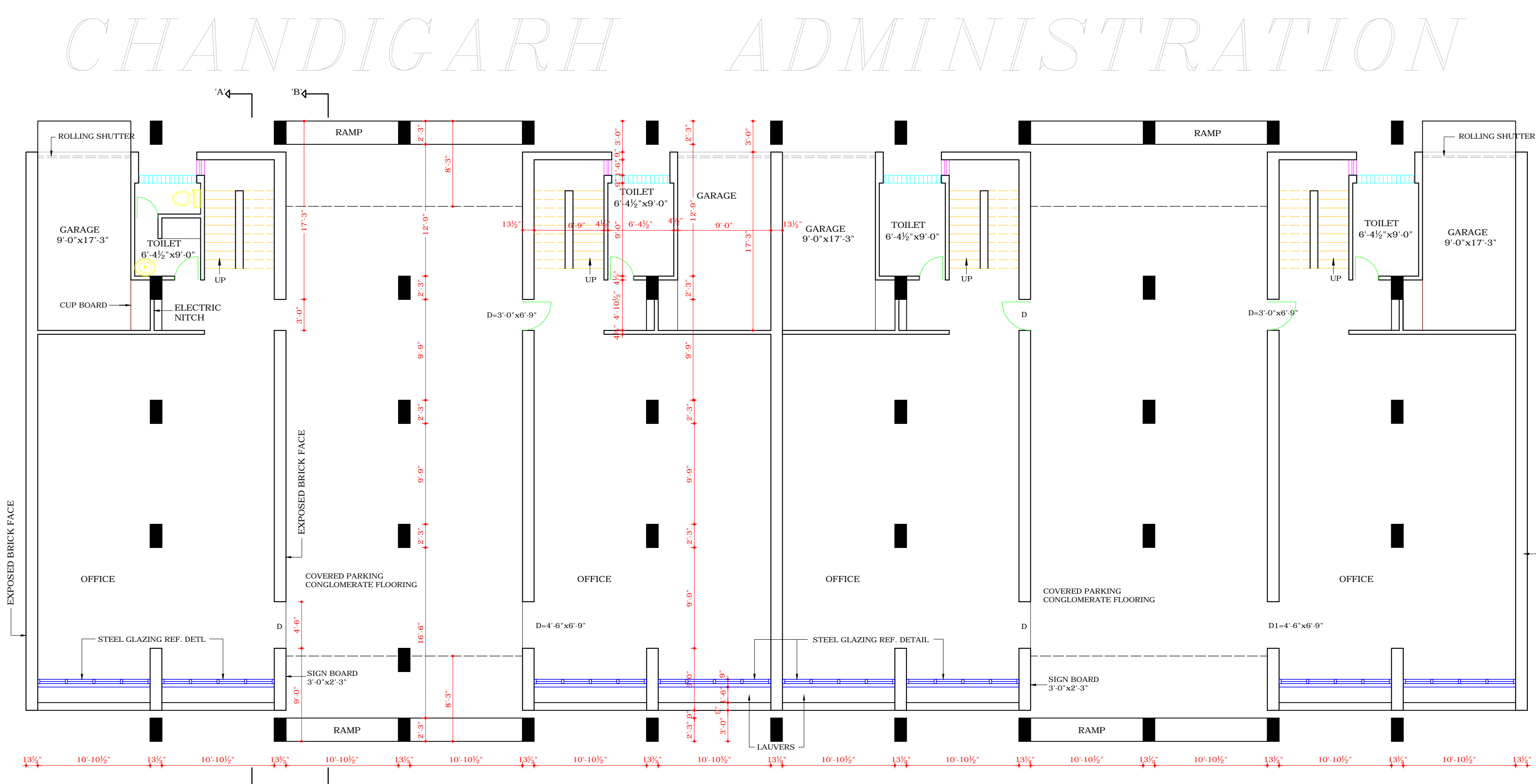
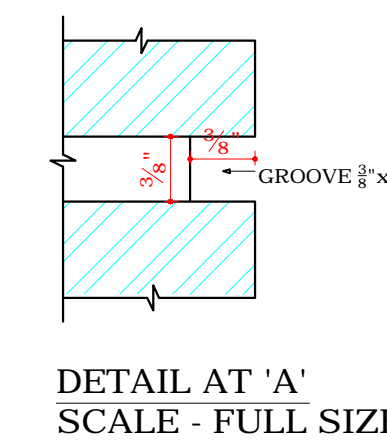

GROUND FLOOR PLAN

DISCLAIMER
 THOUGH EVERY CARE HAS BEEN TAKEN TO PROVIDE THE CORRECT VERSION OF THE ARCHITECTURAL CONTROL ON THIS DIGITIZED (PDF) FORMAT, YET IN CASE OF ANY DISCREPANCY, THE MASTER COPY OF THE ARCHITECTURAL CONTROL APPLICABLE ON EACH SUCH SITE, AS AVAILABLE IN THE COMMERCIAL RECORD OF THE OFFICE OF CHIEF ARCHITECT OR HER/HIS INTERPRETATION WILL OVERRULE THE DIGITIZED FORMAT.

SD/ RAM GOPAL (12.1.79)
 CHIEF ADMINISTRATOR
 SD/ M.N. SHARMA (11.12.78)
 CHIEF ARCHITECT
 SD/ H.S. CHOPRA (08.12.78)
 SENIOR ARCHITECT
 SD/ J.N. SETH
 ARCHITECT
 SD/
 CHIEF ADMINISTRATOR
 25.7.75

- | S.No. | NOTES |
|-------|---|
| 1. | THIS DRAWING IS THE PROPERTY OF THE DEPTT. OF ARCHITECTURE, CHD. FORMERLY OF PB. GOVT. AND MUST NOT BE ALTERED, COPIED OR USED IN WHOLE OR IN PARTS WITHOUT THE PERMISSION OF THIS DEPTT. IN WRITING. |
| 2. | RESTRICTIONS CONTAINED IN THESE ARCHITECTURAL CONTROL SHEETS ARE IN ADDITION AND ARE THE SUPPLEMENTARY TO THE PB. CAPITAL (DEVELOPMENT AND REGULATION) BUILDING RULES 1952 AND AS AMENDED UP TO DATE. |
| 3. | THIS DRG. IS TO BE READ WITH DRG. NO. 3& 4 OF JOB 799. |
| 4. | PLINTH LEVEL IS TO BE OBTAINED BEFORE COMMENCEMENT OF CONST. FROM THE OFFICE OF THE CHIEF ARCHITECT CHANDIGARH ADMINISTRATION. |
| 5. | NO DEVIATION IN THE EXTERNAL FACADE OR FACADES THROUGH COVERED PARKING SHALL BE ALLOWED. |
| 6. | INTERNAL PARTITIONS AND INTERNAL MINOR CHANGES MAY BE ALLOWED SUBJECT TO THE PRIOR APPROVAL OF THE CHIEF ADMINISTRATOR. |
| 7. | EXPOSED BRICK WORK SHALL MEAN FAIR FACE BRICK WORK WITHOUT ANY PAINT OR COLOUR WASH EXCEPT DEEP RAKED FINISHING AS SHOWN AT 'A'. |
| 8. | THE COVERED PARKING SHALL BE KEPT FREE OF ANY OBSTRUCTION. |
| 9. | THE FLOORING PATTERN AND THE SPECIFICATION OF THE MATERIAL IN COVERED PARKING SHALL BE STRICTLY ADHERED TO AS SHOWN IN THE DRG. |
| 10. | NO ADVERTISEMENT SHALL ALLOWED IN SPACES OTHER THAN THE ONES STIPULATED IN THE DRG. |
| 11. | NO PORTION OF THE BUILDING PERMANENT OR TEMPORARY OR WATER STORAGE TANK OR ANY OTHER FEATURES SHALL PROJECT BEYOND THE GSKY LINE) TOP OF PRESCRIBED HEIGHT. |
| 12. | NO RAIN WATER, SOIL VENT OR ANY OTHER PIPE SHALL BE ALLOWED ON THE EXTERNAL FACADES OF THE BUILDING (PIPES ARE ENCASED IN MASONRY PROPERLY). |
| 13. | THE ELECTRICAL & TELEPHONE CONNECTIONS TO BE UNDERGROUND. |
| 14. | ALL FACADES OF THE BUILDING TO BE COMPLETED UP TO FULL HEIGHT IN FIRST PHASE. HOWEVER REST OF THE INTERNAL CONSTRUCTION FOR SECOND FLOOR ONLY MAY BE COMPLETED IN SECOND PHASE. |
| 15. | NO CHANGE SHALL BE ALLOWED WITHOUT THE PRIOR APPROVAL OF THE CHIEF ADMINISTRATOR (CONTINUED ON DRG NO. 3 JOB NO 799) |

APPROVAL OF THE CHIEF ADMINISTRATOR CHANDIGARH U.T. OFFICE MEMO NO. U.T. 3135-F2-75/11750 DATED 7.8.1975
 APPROVAL OF THE CHIEF ADM RECEIVED VIDE HIS OFFICE MEMO NO. 10217-UT(FG) 78/1017 DT. 17.1.79.
 NOTE THIS COMPUTER DRAWING IS BASED UPON ORIGINAL DRAWING NO.2 JOB NO 799.

S. NO.	DESCRIPTION	SIGN	DATE
REVISIONS			
	SD/ (M.N. SHARMA, 17.6.75) CHIEF ARCHITECT	SD/ (H.S. CHOPRA, 16.6.75) SENIOR ARCHITECT	
	SD/ (G.P. MEHTA, 16.6.75) ARCHITECT	SD/ (PRAN NATH) ASSTT. ARCHITECT	
OFFICE OF THE CHIEF ARCHITECT & SECY. CHANDIGARH			
SCALE: 8 FEET TO AN INCH		DATE: 05.09.2006	
REDRAWN BY	JOB NO.	DRG NO.	
CHECKED BY	799	2	
ARCHITECTURAL CONTROL FOR OFFICES OF SPECIFIED PROFESSIONS ON V4 ROADS IN SECOND PHASE SECTORS			
GROUND FLOOR PLAN & FIRST FLOOR PLAN			