

NOTES

THIS DRG. IS THE PROPERTY OF THE DEPTT. OF ARCHITECTURE, CHANDIGARH ADMN. AND FORMERLY THE GOVT. OF PUNJAB AND MUST NOT BE ALTERED, COPIED OR USED IN WHOLE OR IN PART WITHOUT THE PERMISSION OF THIS DEPTT. IN WRITING.

THIS DRG. IS TRACED FROM DRG. No. 5 JOB No. 220 ON DATED 27.4.73

SD: 27th APRIL 1973

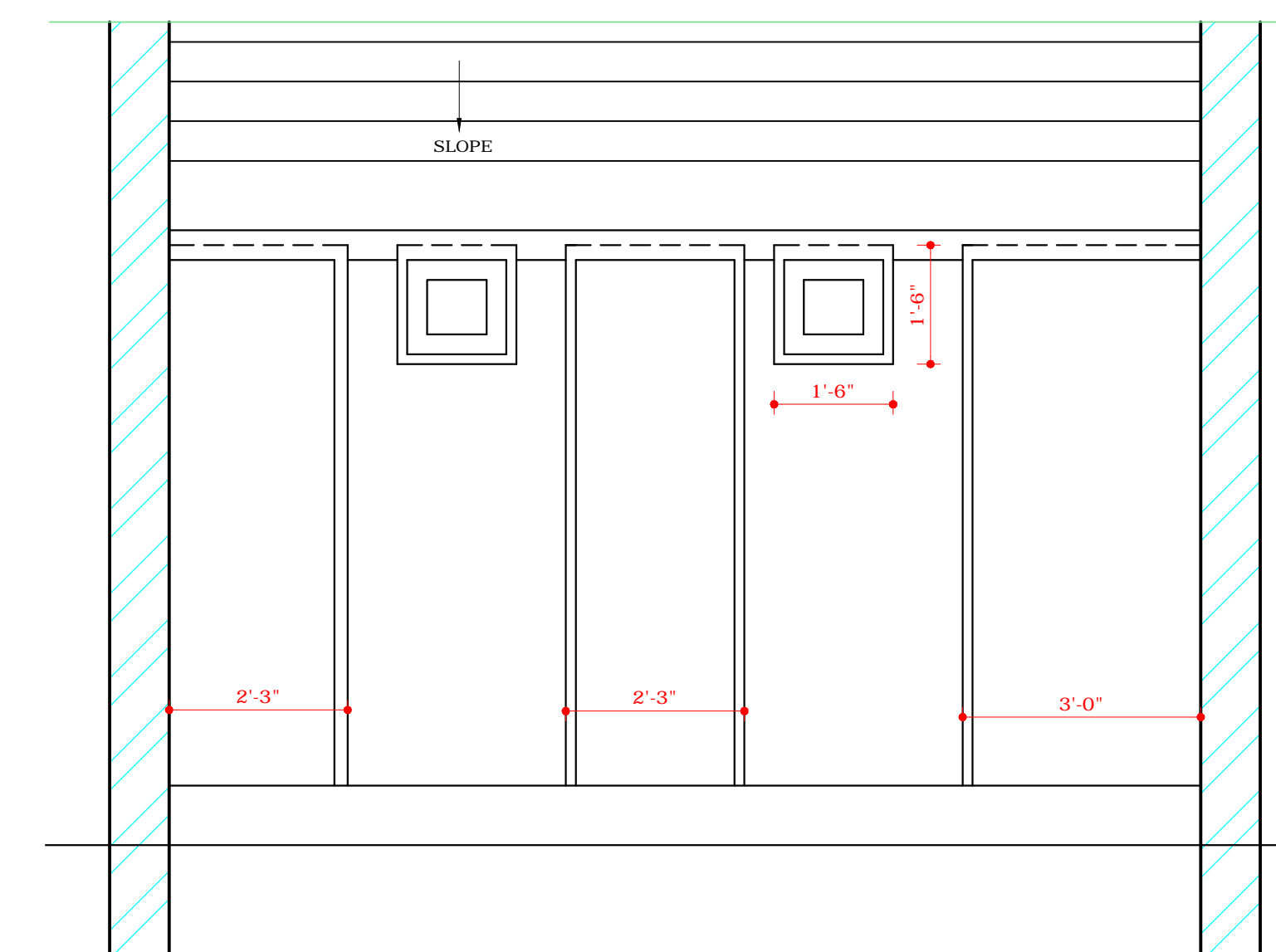

SECTIONAL ELEVATION AT CC'

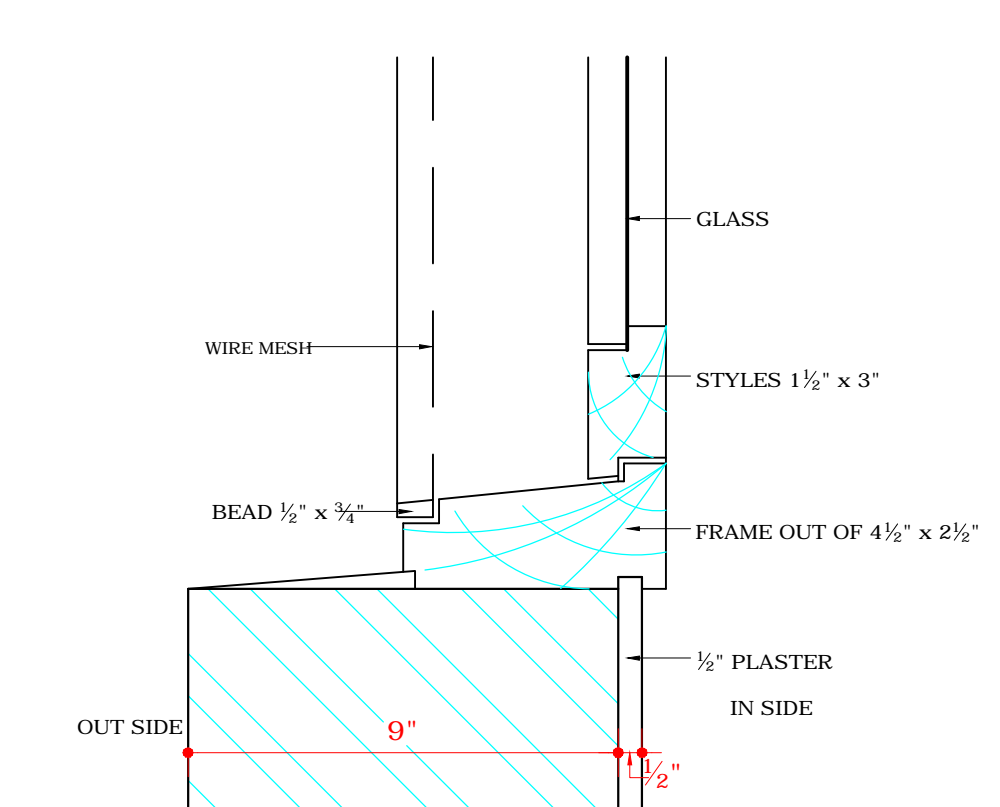

DETAIL AT "A"
SCALE: 1/2" FULL SIZE

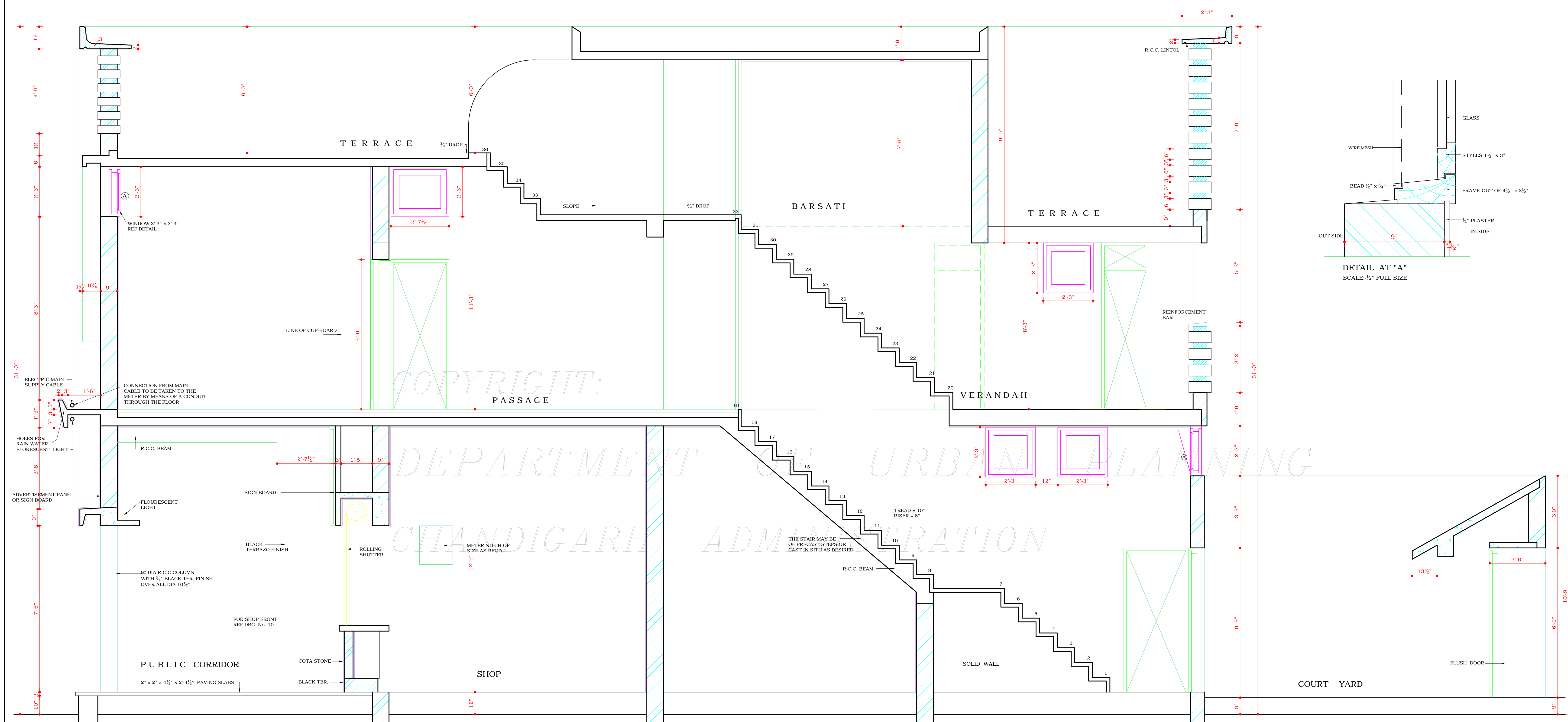

SECTION AT AA'

DESCRIPTION	DATE	SIGN
REVISIONS		
Sd/- S.L. VARMA CHIEF ADMINISTRATOR	Sd/- M.N. SHARMA CHIEF ARCHITECT	
Sd/- P. JEANNERET SENIOR ARCHITECT	Sd/- ADITYA PARKASH 22.X.99 JUNIOR ARCHITECT	

OFFICE OF THE CHIEF ARCHITECT CHANDIGARH U.T.

SCALE = 1/2" TO A FOOT	DATE
DRAWN SIGN Sd/- 27th APRIL 1983	DRG No. 5 JOB No. 220

DISCLAIMER
THOUGH EVERY CARE HAS BEEN TAKEN TO PROVIDE THE CORRECT VERSION OF THE ARCHITECTURAL CONTROL ON THIS DIGITIZED (PDF) FORMAT. YET IN CASE OF ANY DISCREPANCY, THE MASTER COPY OF THE ARCHITECTURAL CONTROL APPLICABLE ON EACH SUCH SITE, AS AVAILABLE IN THE COMMERCIAL RECORD OF THE OFFICE OF CHIEF ARCHITECT OR HER/HIS INTERPRETATION WILL OVERRULE THE DIGITIZED FORMAT.

ATTENDED TRUE COPY
Sd/- KUREKAR
9.7.73
ASSTT. ARCHITECT.