

DEPARTMENT OF ARCHITECTURE, U.T. CHANDIGARH.

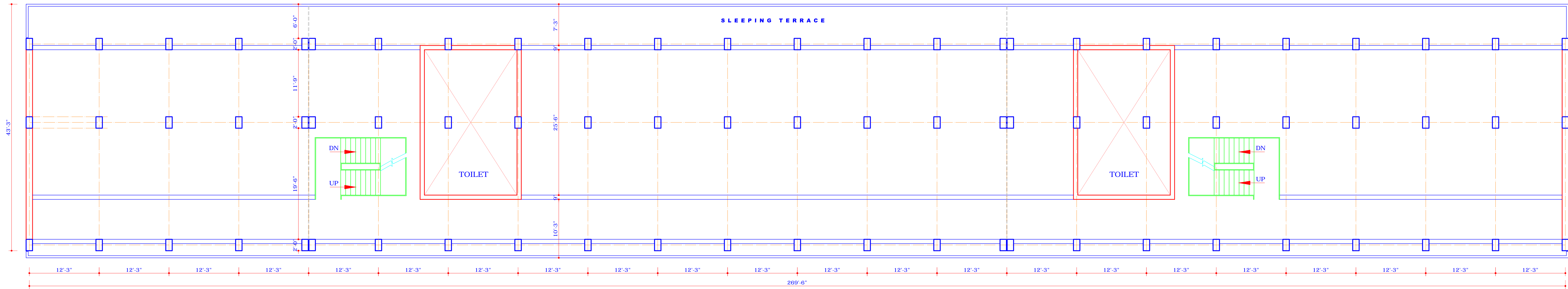

FIRST FLOOR PLAN

COPYRIGHT:

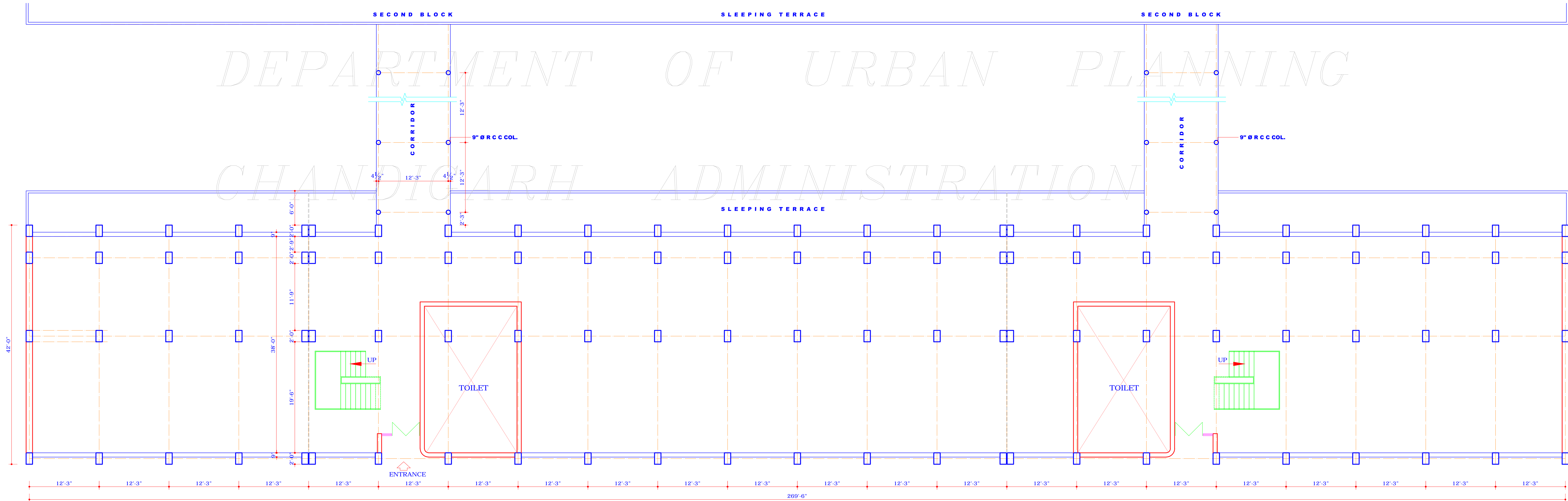

GROUND FLOOR PLAN

NOTE : CHIEF ADMINISTRATOR HAS APPROVED ARCHITECTURAL CONTROL FOR HOSTEL COMPLEX WEST OF SECTOR 25, CHD. VIDE HIS OFFICE MEMO, NO. 7034-UT/FG-85/1403, DATED : 29.01.86

DISCLAIMER : THOUGH EVERY CARE HAS BEEN TAKEN TO PROVIDE THE CORRECT VERSION OF THE ARCHITECTURAL CONTROL ON THIS DIGITIZED (PDF) FORMAT, YET, IN CASE OF ANY DISCREPANCY, THE MASTER COPY OF THE ARCHITECTURAL CONTROL APPLICABLE ON EACH SUCH SITE AS AVAILABLE IN THE COMMERCIAL RECORD OF THE OFFICE OF THE CHIEF ARCHITECT OR HERHIS INTERPRETATION WILL OVERRULE THE DIGITIZED FORMAT.

S.NO.	NOTES :-
1.	THIS DRG. IS THE PROPERTY OF THE DEPTT. OF ARCHITECTURE U.T. CHD FORMERLY OF PB. GOVT. AND MUST NOT BE ALTERED, COPIED OR USED IN WHOLE OR IN PART WITHOUT THE PERMISSION IN WRITING OF THIS DEPTT.
2.	2. PRELIMINARY THESE ARCHITECTURE CONTROL SHEETS NO.2 TO 8 JOB NO.2226 ARE ISSUED IN EXERCISE OF THE POWERS CONFERRED BY SECTION 4 OF THE CAPITAL OF PUNJAB (DEVELOPMENT AND REGULATIONS) ACT, 1952 AND IS TO BE READ IN CONJUNCTION WITH THE BUILDING RULES BYELAWS UNDER THE SAID ACT. THESE DRAWINGS ARE TO BE READ WITH THE LAYOUT PLAN DRG. NO.8 JOB NO.2226
3.	TYPE OF THE BUILDING PERMITTED TYPE OF BUILDINGS PERMITTED TO BE ERECTED ON THE SITE SHALL BE BUILDINGS DESIGNED AND INTENDED TO BE USED FOR THE SPECIFIC PURPOSES FOR WHICH THE SITE IS LEASED OUT TO THE ALLOTTEE OR FOR USE, AS MAY BE DEFINED OR EMPLOYED BY THE CHIEF ADMINISTRATOR AND THEIR USE FOR ANY OTHER PURPOSE IS PROHIBITED. BUILDING PERMITTED TO BE ERECTED OR RE-ERECTED SHALL CONFORM TO THE FUNCTIONS OF THE INSTITUTION FOR WHICH THIS SITE IS ALLOTTED AND SHALL INCLUDE ANY SUCH ANCILLARY OR COMPONENT BUILDINGS OR STRUCTURES AS ARE APPROVED BY THE CHIEF ARCHITECT/CHIEF ADMINISTRATOR.
4.	HEIGHT COMPULSORY. IT SHALL BE BUILT TO A FULL VOLUME IN ONE OPERATION TO A HEIGHT OF 48'-6" IN ACCORDANCE WITH THE ELEVATIONS & SECTION OF THE ARCHITECTURAL CONTROL. a) THE PLINTH LEVEL SHALL BE AS DETERMINED BY THE CHIEF ARCHITECT FOR EACH BLOCK AND SHALL BE OBTAINED FROM HIS OFFICE. b) ALL THE BUILDINGS WITH RESTRICTED HEIGHT ZONE SHALL BE COMPULSORILY ABUT ON THE BUILDING LINES INDICATED ON THIS PLAN.
5.	BUILDING LINES/ARCHITECTURAL CONTROL a) BUILDING LINES SHOWN IN THIS PLAN AND HEIGHT ARE COMPULSORY AND THE BUILDING MUST ABUT THESE LINES. b) FACADES OF BUILDING ALONG THE COMPULSORY BUILDING LINES SHALL BE IN ACCORDANCE WITH THE CONTD. ON DRG. NO.3

S.NO.	DESCRIPTION	SIGN	DATE
REVISIONS			

-sd- 29.01.86 CHIEF ADMINISTRATOR			
-sd- W.C.MALHOTRA 04.11.85 CHIEF ARCHITECT	-sd- V.P.ARORA SENIOR ARCHITECT		
-sd- ARCHITECT	-sd- INDERJIT MAJITHIA ASST. ARCHITECT		

OFFICE OF THE CHIEF ARCHITECT & SECY. CHANDIGARH, U.T.

SCALE : 1/8" TO A FOOT DATE:

DEALT BY	JOB NO. 2226	DRG. NO. 2
CHECKED BY		

ARCHITECTURAL CONTROL FOR HOSTEL COMPLEX WEST OF SECTOR - 25, CHANDIGARH.

GROUND & FIRST FLOOR PLAN