

DEPARTMENT OF ARCHITECTURE, U.T. CHANDIGARH.

- S.NO. NOTES :-
- CONTD. FROM DRG. NO.2 ARCHITECTURAL CONTROL AS IS ILLUSTRATED ON DRG. NO.4. JOB NO.2226.
- c) ANY DEVIATION OR MODIFICATION OR ALTERATION IN THE FACADE MAY BE CONSIDERED BY THE CHIEF ADMINISTRATOR IN CONSULTATION WITH THE CHIEF ARCHITECT. SUCH DISPENSATION MUST BE OBTAINED PRIOR TO STARTING CONSTRUCTION AT SITE.
- BOUNDARY WALL
- a) WALLS OF SPECIFICATION AND DESIGN 'B' AS SHOWN ON DRG. NO.5/1 SHALL BE BUILT ALONG BOUNDARY NOT COVERED BY BUILDINGS.
- b) THE CURVATURE OF BOUNDARY WALL ALONG CORNER OF THE SITE SHALL BE IN ACCORDANCE WITH THE RADII INDICATED ON THIS PLAN AND ILLUSTRATED IN DRG. NO.5/1.
- c) THE HEIGHT AS APPLIED TO BOUNDARY WALL SHALL BE THE VERTICAL MANAGEMENT OF THE WALL FROM CENTER OF THE FINISHED LEVEL OF THE ROAD TO WHICH THE SITE HAS AN ACCESS.
- DESIGN AND SUPERVISION
- a) THE DESIGN SHALL BE PREPARED BY DULY QUALIFIED ARCHITECT IN CONSULTATION WITH THE CHIEF ARCHITECT AND THE WORK EXECUTED UNDER THE SUPERVISION OF THE SAME OR ANY OTHER DULY QUALIFIED ARCHITECT.
- b) THE BUILDING PLANS FOR ANY SITES SHOWN ON THIS PLAN SHALL BE PREPARED TO A SCALE 8 FT. TO AN INCH AND SHALL INCORPORATE ELEVATION AND SECTIONS.
- c) SOIL AND WATER PIPE, VENT PIPE, WATER STORAGE TANKS ON TERRACE OR ANY PLUMBING SHALL BE EXPOSED TO VIEW ON THE FACE OF THE BUILDING AND SHALL BE SUITABLY ENCASED.
- d) MACHINE ROOM FOR LIFT.
- e) THE END WALLS SHALL BE FINISHED IN RCC STEEL SHUTTERING PATTERN AS ILLUSTRATED IN DRG. NO.4. JOB NO.2226.
- f) FOR DISPLAY OF ANY SIGN/BOARD, A SEPARATE APPLICATION UNDER THE ADVERTISEMENT CONTROL ORDER SHALL BE MADE TO THE ESTATE OFFICE/CHIEF ADMINISTRATOR.
- g) THE CILL HEIGHT FOR GLAZING SHALL BE 2'9" HIGH FROM THE FINISHED FLOOR LEVEL.
- ELEVATIONS AND SECTIONS
- a) THIS DRAWING IS TO BE READ WITH DRG. NO.1, 2, 4 & 5 OF JOB NO.2226.
- b) THE ELEVATIONS AND SECTIONS OF TYPICAL BLOCK SHOWN IN THIS DRAWING ARE ONLY ILLUSTRATED AND MAY NOT BE TAKEN AS WORKING DRAWING.
- CONTD. ON DRG. NO.4.

S.NO.	DESCRIPTION	SIGN	DATE
REVISIONS			

-sd/ 29.01.86 CHIEF ADMINISTRATOR	
-sd/ W.C.MALHOTRA 04.11.85 CHIEF ARCHITECT	-sd/ V.P.ARORA SENIOR ARCHITECT
-sd/ ARCHITECT	-sd/ INDERJIT MAJITHIA ASST. ARCHITECT

OFFICE OF THE CHIEF ARCHITECT & SECY. CHANDIGARH, U.T.

SCALE: 1/8" TO A FOOT		DATE:
DEALT BY	JOB NO. 2226	DRG. NO. 3
CHECKED BY		

ARCHITECTURAL CONTROL FOR HOSTEL COMPLEX WEST OF SECTOR - 25, CHANDIGARH.

SECOND & THIRD FLOOR PLAN

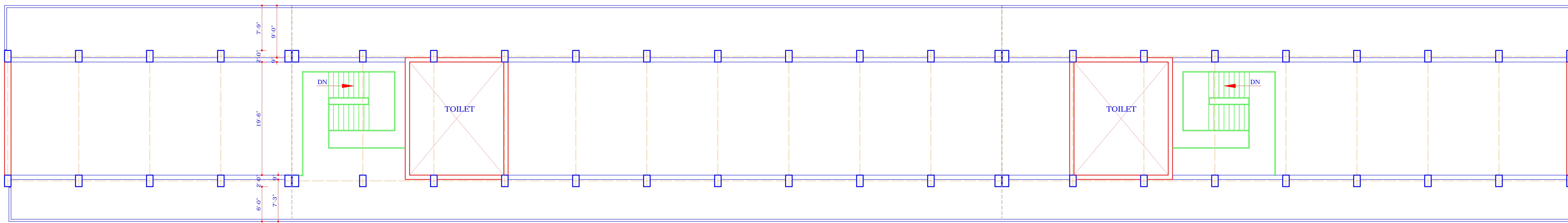

THIRD FLOOR PLAN

COPYRIGHT: DEPARTMENT OF URBAN PLANNING

CHANDIGARH ADMINISTRATION

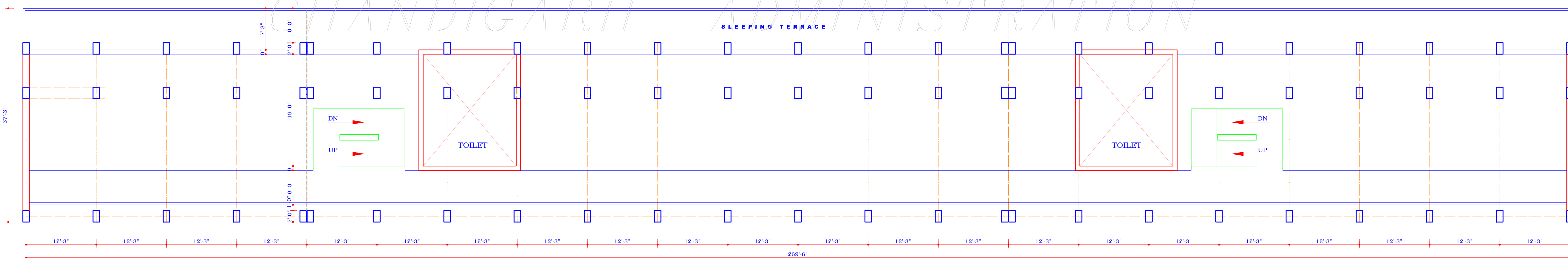

SECOND FLOOR PLAN

NOTE : CHIEF ADMINISTRATOR HAS APPROVED ARCHITECTURAL CONTROL FOR HOSTEL COMPLEX WEST OF SECTOR 25, CHD. VIDE HIS OFFICE MEMO. NO. 7034-UTP(2)-85/1493, DATED : 29.01.86

DISCLAIMER : THOUGH EVERY CARE HAS BEEN TAKEN TO PROVIDE THE CORRECT VERSION OF THE ARCHITECTURAL CONTROL ON THIS DIGITIZED (PDF) FORMAT, YET IN CASE OF ANY DISCREPANCY, THE MASTER COPY OF THE ARCHITECTURAL CONTROL APPLICABLE ON EACH SUCH SITE, AS AVAILABLE IN THE COMMERCIAL RECORD OF THE OFFICE OF THE CHIEF ARCHITECT OR HER/HIS INTERPRETATION WILL OVERRULE THE DIGITIZED FORMAT.