

S.NO. NOTES

THIS DRAWING IS THE PROPERTY OF THE DEPTT. OF ARCHITECTURE U.T. CHD. FORMERLY OF THE P.B. GOVT. MUST NOT BE ALTERED, COPIED OR USED IN WHOLE OR IN PARTS WITHOUT THE PERMISSION OF THIS DEPTT. IN WRITING.

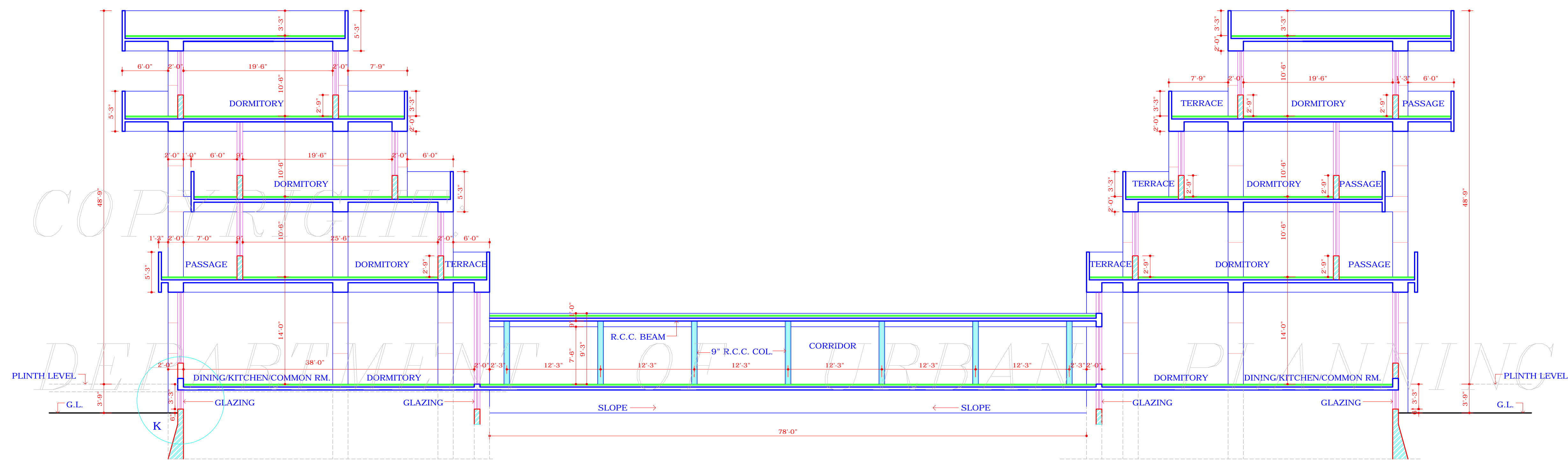

SECTION THROUGH CORRIDOR

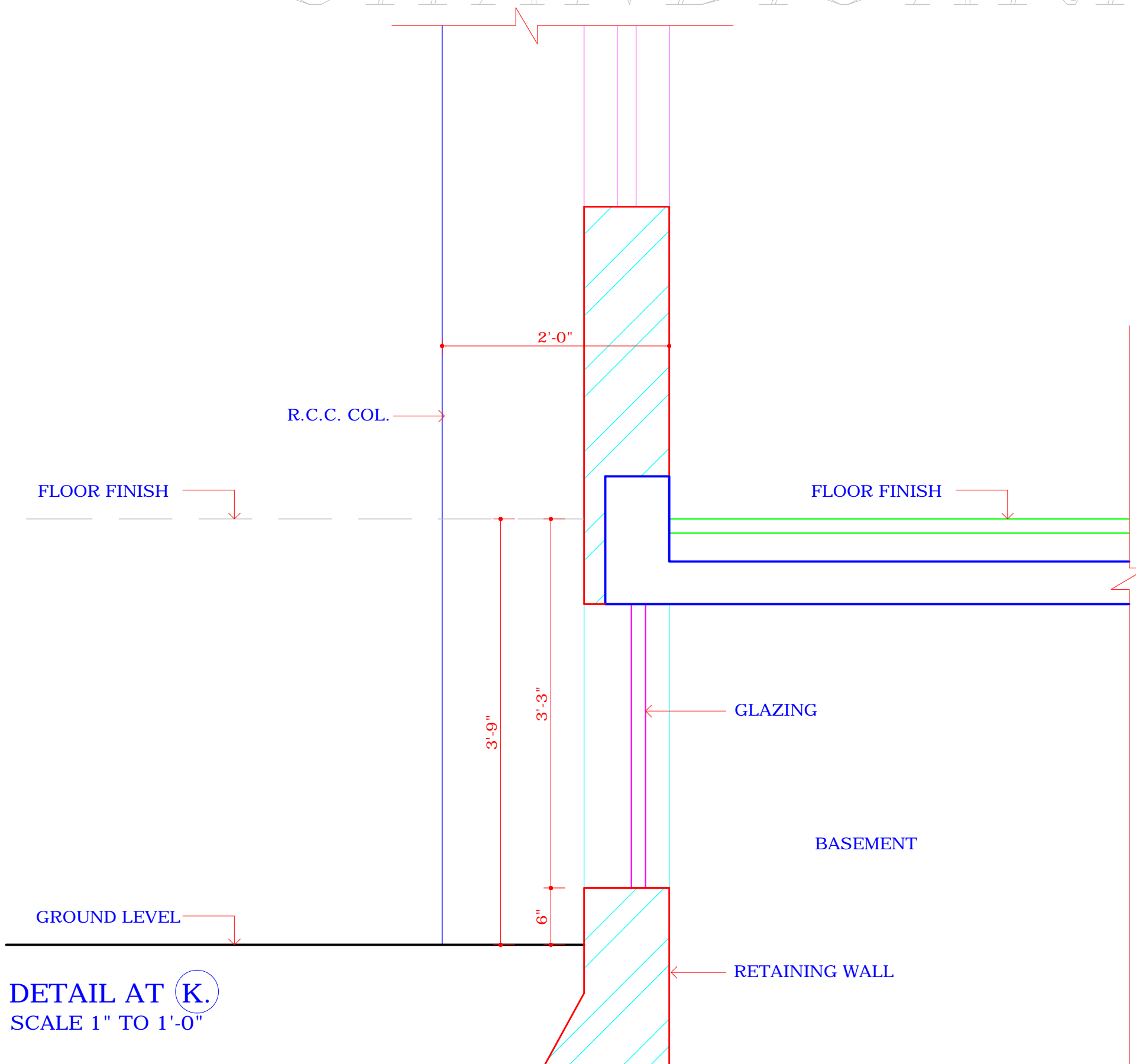

DETAIL AT (K) SCALE 1" TO 1'-0"

NOTE
CHIEF ADMINISTRATOR HAS APPROVED ARCHITECT CONTROL FOR HOSTEL COMPLEX, WEST OF SECTOR 25, CHD. VIDE HIS OFFICE MEMO. NO-7034-UTFI(2)-85/1493 DATED 29-01-86.

DISCLAIMER
THOUGH EVERY CARE HAS BEEN TAKEN TO PROVIDE THE CORRECT VERSION OF THE ARCHITECTURAL CONTROL ON THIS DIGITIZED (PDF) FORMAT, YET IN CASE OF ANY DISCREPANCY, THE MASTER COPY OF THE ARCHITECTURAL CONTROL APPLICABLE ON EACH SUCH SITE, AS AVAILABLE IN THE COMMERCIAL RECORD OF THE OFFICE OF THE CHIEF ARCHITECT OR HER/HIS INTERPRETATION WILL OVERRULE THE DIGITIZED FORMAT.

S.NO. DESCRIPTION SIGN DATE

REVISIONS

-SD- 29.01.86 CHIEF ADMINISTRATOR	
-sd- (W.C. MALHOTRA) 04.11.85 CHIEF ARCHITECT	-sd- (V.P. ARORA) SENIOR ARCHITECT
-sd- 23.04.85 ARCHITECT	ASST. ARCHITECT

OFFICE OF THE CHIEF ARCHITECT, U.T., CHANDIGARH

SCALE: 8 FEET TO AN INCH DATE:

DRAWN BY	JOB NO. 2226	DRG. NO. 5
CHECKED BY		

HOSTEL COMPLEX IN WEST OF SECTOR - 25

SECTION THROUGH CORRIDOR