

DEPARTMENT OF ARCHITECTURE

- NOTES:
- THIS DRG. IS THE PROPERTY OF THE DEPTT. OF ARCHITECTURE U.T. OF CHD. & MUST NOT BE ALTERED, COPIED OR USED IN WHOLE OR IN PART WITHOUT THE PERMISSION OF THE DEPTT. IN WRITING.
 - ONLY QUALIFIED ARCHITECTS ARE ALLOWED TO SUBMIT PLANS, SUPERVISE CONSTRUCTION & ISSUE COMPLETION CERTIFICATES FOR THESE BUILDINGS.
 - THIS DRG. IS TO BE READ TOGETHER WITH THE DRG. NO. 36 JOB NO. 39 SHOWING PLOT NO. 142, TO PLOT NO. 154.
 - PLINTH LEVEL SHALL BE OBTAINED FROM THE OFFICE OF THE CHIEF ARCHITECT & SECY. DEPTT. OF ARCHITECTURE CHD.
 - EXPOSED BRICK WORK SHALL MEAN FAIR FACED BRICK WORK WITHOUT ANY PAINT, COLOUR WASH OR POINTING.
 - PLASTERED FACE WHERE EVER SHOWN ON THE DRAWING SHALL BE WHITE WASHED, UNLESS OTHERWISE SPECIFIED.
 - INTERNAL CHANGES MAY BE ALLOWED SUBJECT TO THE PRIOR APPROVAL OF THE CHIEF ADMINISTRATOR.
 - NO DEVIATION IN EXTERNAL FACADE OR FACADES THRU VERANDAH SHALL BE ALLOWED.
 - EXTERNAL DOORS, WINDOWS, SHUTTERS & JOINERY WORK IN STEEL OR IN WOOD AS SPECIFIED IN THE DRAWING SHALL BE PAINTED IN GREY COLOUR OF 1:1 SHADE NO. 693 ONLY.
 - NO ADVERTISEMENT SHALL BE ALLOWED ON THE SPACES OTHER THAN STIPULATED.
 - NO RAIN WATER SOIL VENTILATING OR ANY OTHER PIPE SHALL BE PERMITTED ON THE EXTERNAL FACES OF THE BUILDING.
 - THE MEANS OF TAKING ELECTRICAL TELEPHONES OR ANY OTHER CONNECTIONS FROM THE PUBLIC SUPPLY LINES SHALL BE SHOWN ON THE BUILDING PLANS & SHALL BE SUBJECT TO THE APPROVAL OF THE CHIEF ADMINISTRATOR.
 - ELECTRIC INSTALLATIONS AS FAR AS LIGHT FITTINGS ARE CONCERNED SHALL BE FOLLOWED AS SHOWN IN THE PLAN.
 - NO WATER STORAGE TANK OR CHIMNEY ETC. SHALL PROJECT BEYOND THE HEIGHT OF PARAPET OF PARTY WALL NO AS TO BE VISIBLE TO THE PUBLIC.
 - THIS DRG. IS ALSO APPLICABLE IN CASE OF SHOPPING CENTRE SECTOR 35 PLOT NO. 84 TO 97 & 200 TO 270. FOR LAYOUT REF. DRG. NO. 16 JOB NO. 68 Sd/- IQBAL SINGH 4. 2. 70 DRG. NO. 15
 - AS PER CHIEF COMMISSIONERS ORDER DATED 15. 3. 71. REVISION MADE ON 6. 7. 71 REAR COURTYARD COVERAGE OPTIONAL PROVIDED IT IS IN CONFORMITY WITH BUILDING BY-LAWS. Sd/- IQBAL SINGH 4. 2. 70
 - THIS DRG. IS ACTUALLY TRACED FROM DRG. NO. 1 OF JOB NO. 649 ON DATED 18. 8. 72. THIS DRG. IS ALSO APPLICABLE TO S.C.O. NOS. 68, 68 A, 70 AND 70 A SEC. 31-C. Sd/- 14-3-05
- ATTESTED TRUE COPY
Sd/- KUREKAM ASSTT. ARCHITECT.
Sd/- S. L. VERMA CHIEF ADMINISTRATOR. 19. 9. 70.

Sd/- M.N. SHARMA 6. 2. 70 CHIEF ARCHITECT.
Sd/- R.R. HANDA 5. 2. 70 SENIOR ARCHITECT.
Sd/- O.P. MEHTA 4. 2. 70 ARCHITECT.
Sd/- IQBAL SINGH 4. 2. 70 ASSTT. ARCHITECT.

OFFICE OF THE CHIEF - ARCHITECT CHANDIGARH

SCALE = 1/4" TO A FOOT	DATE -
RE-DRAWN Sd/- GURCHARAN SINGH	JOB NO. 649
CHECKED	DRG. NO. 1

SHOP - CUM - OFFICES IN SECTORS 28-D & 35, 31-C

GROUND, FIRST & SECOND FLOOR PLANS.

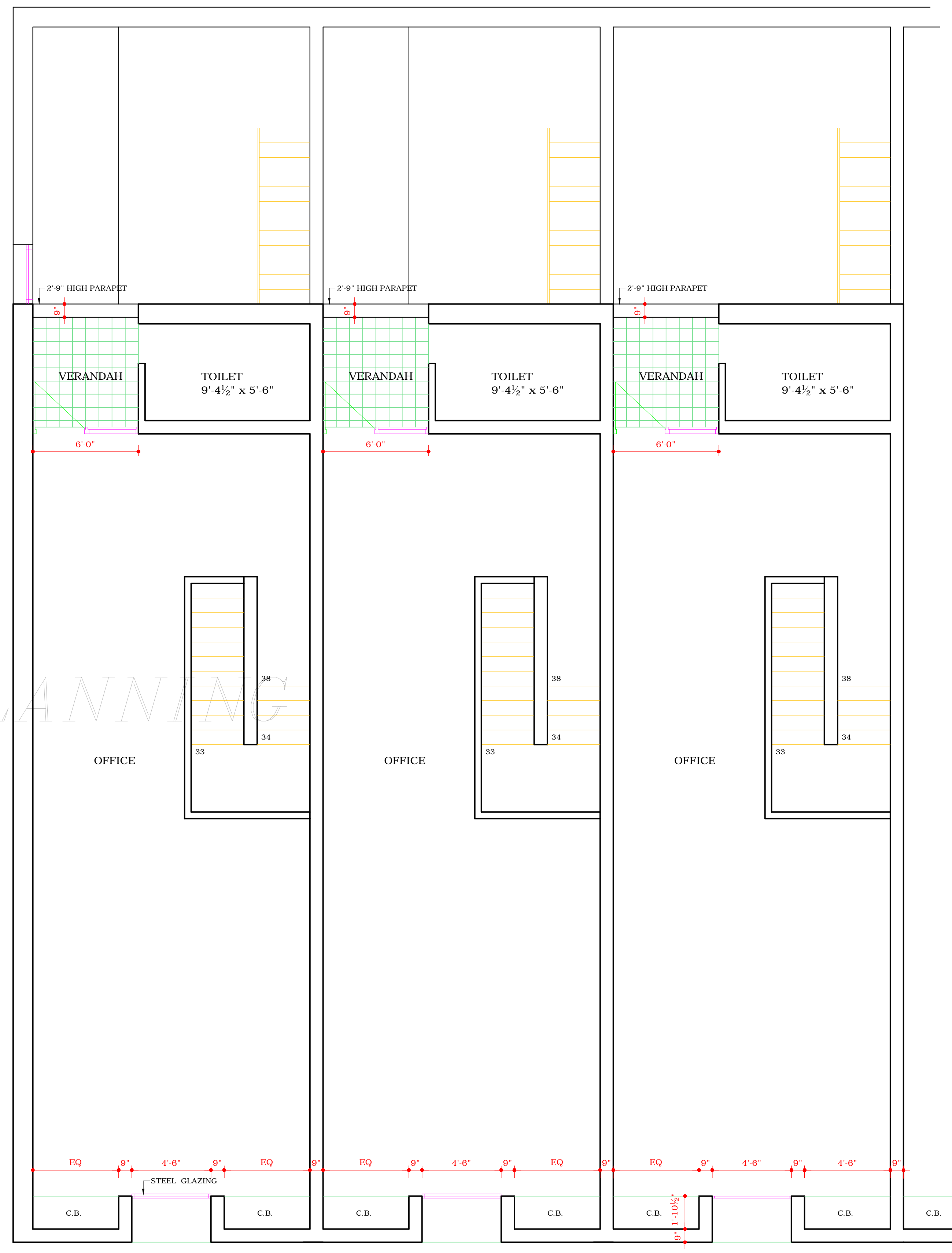
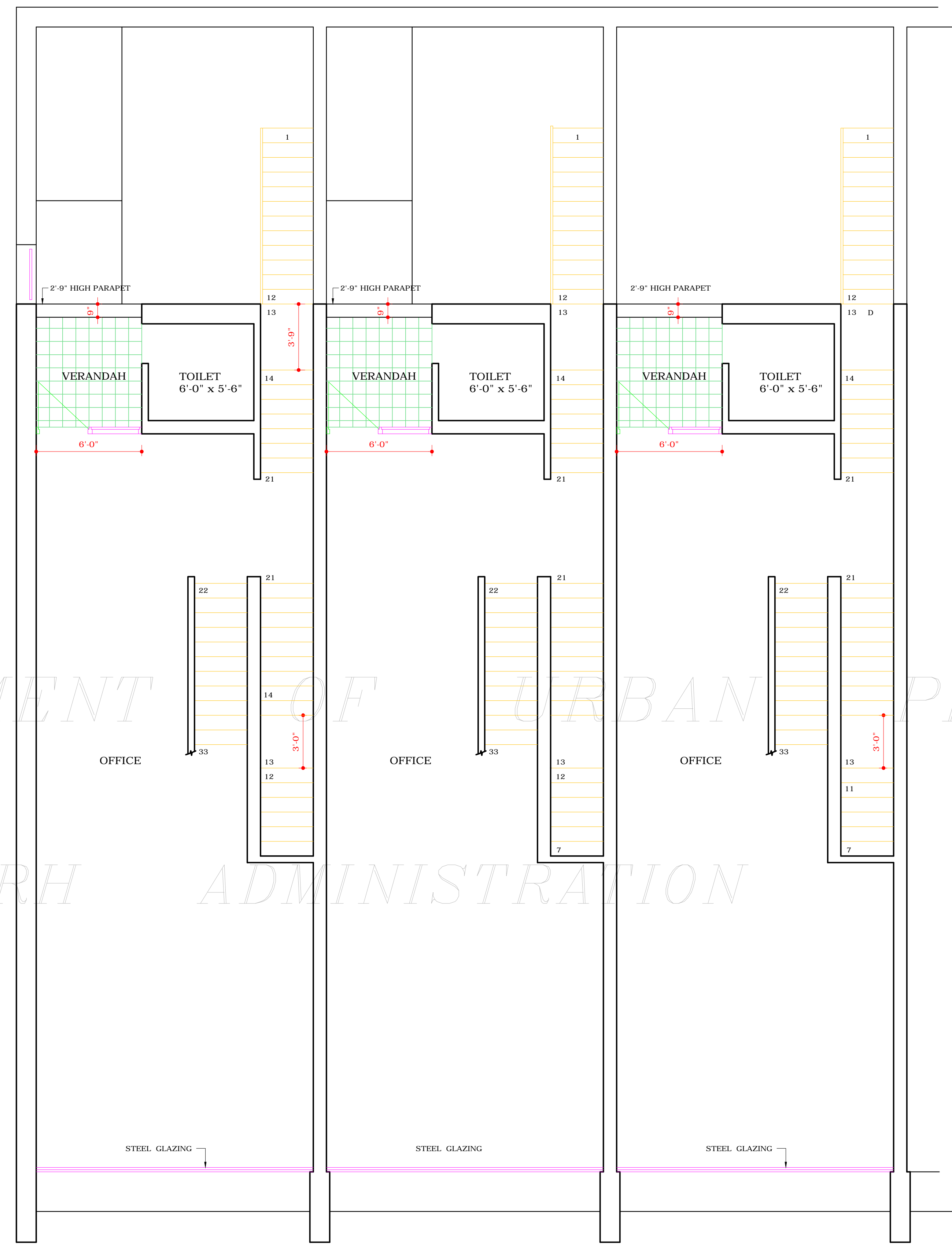
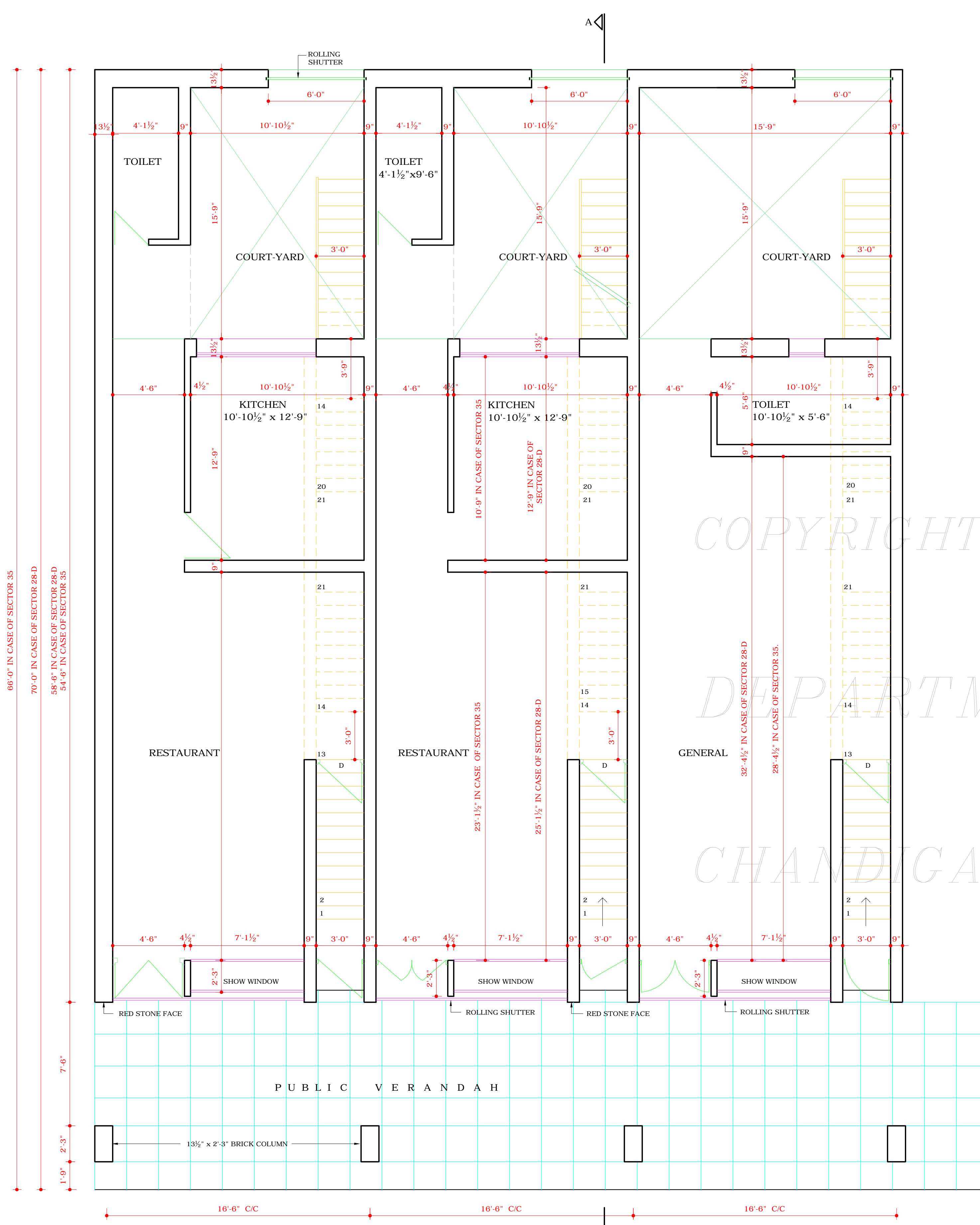

NOTE:
THIS DRAWING HAS BEEN COMPUTERISED ON 22-8-08 FROM DRG. NO. 1, JOB NO. 649.
DISCLAIMER
THOUGH EVERY CARE HAS BEEN TAKEN TO PROVIDE THE CORRECT VERSION OF THE ARCHITECTURAL CONTROL ON THIS DIGITIZED (PDF) FORMAT, YET IN CASE OF ANY DISCREPANCY, THE MASTER COPY OF THE ARCHITECTURAL CONTROL APPLICABLE ON EACH SUCH SITE, AS AVAILABLE IN THE COMMERCIAL RECORD OF THE OFFICE OF CHIEF ARCHITECT OR HER/HIS INTERPRETATION WILL OVERRULE THE DIGITIZED FORMAT.