

**DEPARTMENT OF
ARCHITECTURE U.T.**

S.NO.	NOTES
1.	THIS DRAWING IS THE PROPERTY OF THE DEPT. OF ARCH. CND. U.T. FORMERLY OF THE P.G. GOVT. & MUST NOT BE ALTERED, COPIED OR USED IN ANY MANNER WITHOUT THE PERMISSION OF THIS DEPT. IN WRITING.

S.NO.	REVISIONS	DESCRIPTION	SIGN	DATE
1.	APPROVAL OF THE CHIEF ADMINISTRATOR RECEIVED		K.K.	18.8.23
	UTRI ID: 83 12/112			

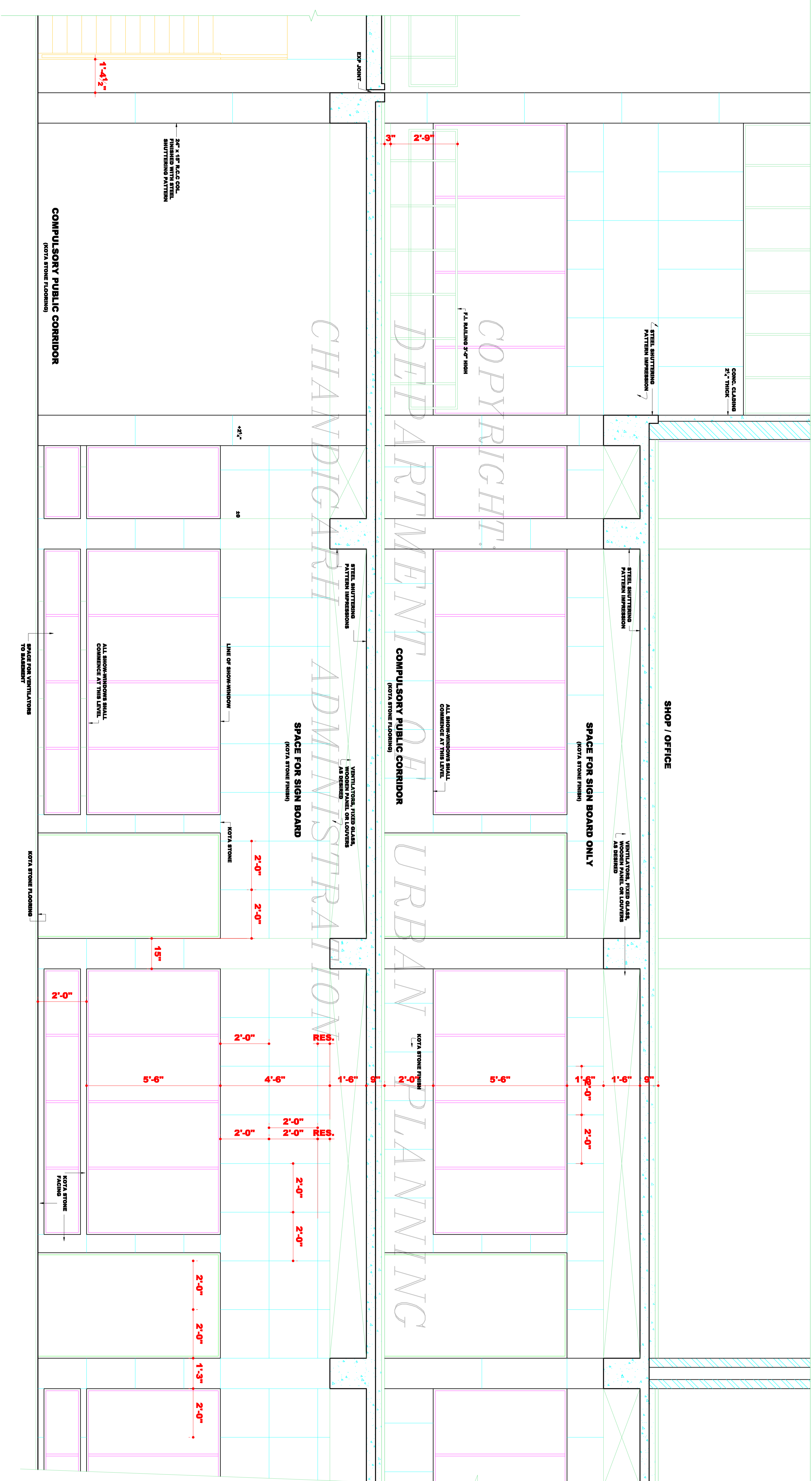

DISCLAIMER
 CARE HAS BEEN TAKEN TO PROVIDE THE CORRECT VERSION OF THE ARCHITECTURAL CONTROL ON THIS DIGITIZED (PDF) DRAWING. THE ORIGINAL DRAWING IS THE PROPERTY OF THE ARCHITECTURE DEPARTMENT OF THE GOVT. OF ANDHRA PRADESH. ANY ALTERATION OR MODIFICATION TO THIS DRAWING IS THE RESPONSIBILITY OF THE USER. THE ARCHITECTURE DEPARTMENT OF THE GOVT. OF ANDHRA PRADESH WILL NOT BE RESPONSIBLE FOR ANY ERRORS OR OMISSIONS IN THIS DIGITIZED DRAWING. THE ORIGINAL DRAWING IS AVAILABLE IN THE COMMERCIAL RECORD OF THE OFFICE OF CHIEF ARCHITECT, U.T. IN HYDRABAD. THE DIGITIZED DRAWING IS FOR REFERENCE ONLY.

SCALE: 1" = 10' 0" 00"	DATE: 4-5-23
DESIGNED BY: HANMANT KANU	JOB NO. 1048
CHECKED BY: A. S. SATTA	DRG. NO. 30
ARCH. CONTROL FOR S.C.O. IN NEW CITY CENTRE SECTOR. 34 BLOCK I	
DETAIL OF STEEL SHUTTERING & PATTERN	