

ELEVATION AT A

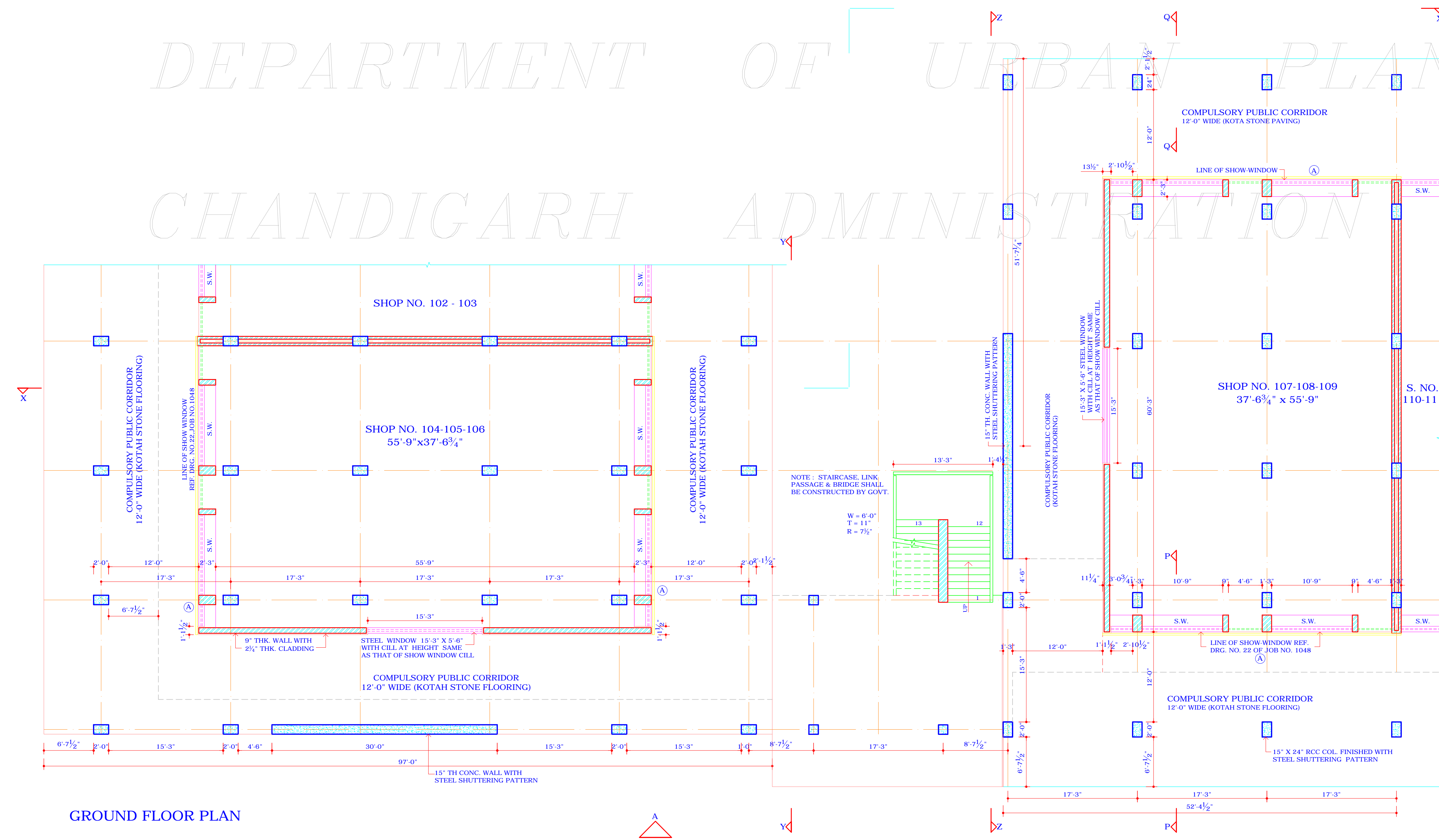

GROUND FLOOR PLAN

THE ADDITIONAL ADVERTISEMENT PANELS AS SHOWN 'C' ALLOWED ON PAYMENT BASIS SHALL BE PROVIDED AS SEPARATE FABRICATED PANEL IN METAL OR ACRYLIC. THE STRUCTURAL STABILITY AND FIXING OF THE SAME SHALL BE STRICTLY ENSURED AT SITE FOR PUBLIC SAFETY.

THE ADDITIONAL ADVERTISEMENT PANELS SHALL BE ALLOWED ONLY SUBJECT TO THE PAYMENT OF CHARGES AS DECIDED BY THE ADMINISTRATION/M.C. CHD.

IN PURSUANCE TO THE APPROVAL OF THE CHIEF ADMINISTRATOR ON FILE DATED 16.08.2017

SD- (SUNITA MONGA) CHIEF ARCHITECT

DISCLAIMER  
THOUGH EVERY CARE HAS BEEN TAKEN TO PROVIDE THE CORRECT VERSION OF THE ARCHITECTURAL CONTROL ON THIS DIGITIZED PDF FORMAT, YET IN CASE OF ANY DISCREPANCY, THE MASTER COPY OF THE ARCHITECTURAL CONTROL APPLICABLE ON EACH SUCH SITE, AS AVAILABLE IN THE COMMERCIAL RECORD OF THE OFFICE OF THE CHIEF ARCHITECT OR HER/HIS INTERPRETATION WILL OVERRULE THE DIGITIZED FORMAT.

S.NO.	NOTES
1.	THIS DRAWING IS THE PROPERTY OF THE DEPARTMENT OF ARCH. CHD. UT AND MUST NOT BE ALTERED, COPIED OR USED IN WHOLE OR IN PART WITHOUT THE PERMISSION OF THIS DEPARTMENT IN WRITING. (CONT. FROM DRG. NO.25) SLAB & T SHALL NOT BE HIGHER THAN THE LINE OF TOP OF THE PARADET.
10.	NO RAIN WATER, SOIL, VENTILATING OF ANY OTHER PIPE SHALL BE PERMITTED ON THE EXTERNAL FACADE OF THE BLDG. ALL SUCH PIPES IN THE BLDG. OTHER THAN FACADE SHALL BE PROPERLY ENCASED.
11.	THE MEANS OF TAKING ELECTRICAL, TELEPHONE OR OTHER CONNECTIONS FROM THE PUBLIC SUPPLY LINE SHALL BE SHOWN ON THE BLDG. PLANS AND SHALL BE SUBJECT TO THE APPROVAL OF THE CHIEF ADMINISTRATOR.
12.	THE EXTERNAL DOORS, WINDOWS, GRILL SHUTTERS ETC. SHALL BE PAINTED IN GREY COLOUR OF I.S.I.693 ONLY.
13.	NO SUB-DIVISION OF SHOP IS ALLOWED.
14.	INTERNAL PLANNING ON ALL FLOORS EXCEPT GROUND & FIRST FLOOR IS LEFT TO THE DISCRETION OF THE OWNER BUT SUBJECT TO THE PRIOR APPROVAL OF THE CHIEF ADMINISTRATOR.
15.	THE CONST. OF THE BASEMENT BELOW THE SHOP (I.E. EXCLUDING THE PUBLIC VER.) IS COMPULSORY.
16.	THE BASEMENT SHALL BE USED FOR MACHINE ROOMS, LIFTS, STORES, RECORD, GODOWNS & STRONG ROOMS. THE ONLY ACCESSORIES TO THE PRINCIPAL USE OF THE SITE AND FOR NO OTHER PURPOSE.
17.	THE DEPTH OF THE BASEMENT SHALL BE STRICTLY AS PER CONTROL SHEETS.
18.	NO ADVERTISEMENT SHALL BE ALLOWED IN SPACES OTHER THAN THOSE STIPULATED IN THE DRGS.
19.	THE STRUCTURAL SIZES ARE INDICATIVE AND THE FINAL RESPONSIBILITY FOR THE STABILITY OF THE STRUCTURE IS THAT OF THE OWNER.
20.	THE WHOLE BUILDING IS TO BE (CONTD. ON DRG. NO.27)

1.	APPROVAL OF THE CHIEF ADMINISTRATOR RECEIVED VIDE HIS MEMO. NO. 3613-UT/F(2), 83/12112.	K.K.	18/08
----	---	------	-------

S.NO.	DESCRIPTION	SIGN	DATE
-------	-------------	------	------

REVISIONS

APPROVAL FOR ADDITIONAL SIGN BOARD SPACE		
SD- (P.D. VASHISHT) 08-08-83 CHIEF ADMINISTRATOR	SD- (SURJIT SINGH) 24.01.83 CHIEF ARCHITECT	SD- (R.S. LAL) 24.01.83 SENIOR ARCHITECT
SD- (SUNITA MONGA) CHIEF ARCHITECT	SD- (J.N. SEFB) 17.01.83 ARCHITECT	SD- (S.S. VIRDD) 17.01.83 ASST. ARCHITECT
OFFICE OF THE CHIEF ARCHITECT, U.T., CHANDIGARH		
SD- (SANJEEV KUMAR) ARCHITECT	SCALE: 1/8" TO A FEET SD- (HARINDER KAUR) DRAWN BY SD- (A.S.R.) CHECKED BY	DATE: 04.05.83 JOB NO. 1048 DRG. NO. 26
ARCH. CONTROL FOR S.C.O. IN NEW CITY CENTRE SECTOR 34		
SD- (DAMINDER VIRDI) ASST. ARCHITECT		

GROUND FLOOR PLAN & FRONT ELEVATION