

DEPARTMENT OF
ARCHITECTURE U.T.

S.No. NOTES.

1. THIS DRG. IS THE PROPERTY OF THE DEPTT. OF ARCH. CHD. UT. FORMERLY OF THE PR. GOVT & MUST NOT BE ALTERED COPIED OR USED IN WHOLE OR IN PARTS WITHOUT THE PERMISSION OF THE DEPTT IN WRITING.
 4. C. NOTES CONTINUED FROM DRG. No. 11 THE FACADES OF THREE & FIVE STOREYED BUILDINGS SHALL BE OF NATURAL REINFORCED CONCRETE WITH THE PATTERN OF STEEL SHUTTERING AS INDICATED ON THE ELEVATION ON ARCHITECTURAL CONTROL SHEET No. 14 JOB No. 2183. IN NO CASE SHALL THE CONCRETE ON FACADES BE PLASTERED, PAINTED OR TREATED IN ANY OTHER WAY.
 5. NUMBER OF FLOORS No. OF FLOORS SHALL BE RESTRICTED TO THE No. SHOWN IN SECTION. THEIR LEVELS SHALL BE IN ACCORDANCE WITH THE LEVELS SHOWN IN SECTION. A FLOOR OR ANY PART THERE OFF, MAY BE OMITTED TO GIVE DOUBLE HEIGHT TO THE FLOOR BELOW. IN NO CASE WILL ADDITIONAL INTERMEDIATE OR MEZZANINE FLOORS BE PERMITTED NOT WITH STANDING ANYTHING IN CLAUSE No. 23 OF BUILDING BYE-LAWS.
 6. OPEN COURTS COURT YARDS OPEN TO SKY AS SHOWN ON ARCH CONTROL SHEETS ARE COMPULSORY. ADDITIONAL COURTYARDS MAY BE PROVIDED BUT IN NO CASE THESE SHALL BE LESS THAN 12' 0" WIDE PROVIDED THE ELEVATIONS SHALL NOT BE CHANGED.
 7. ELECTRICAL CONNECTIONS ELECTRICAL CONNECTIONS FOR TELEPHONE OR ANY OTHER PURPOSE SHALL BE TAKEN IN UNDER GROUND CONDUITS FROM THE PUBLIC LINES.
 8. DESIGN & SUPERVISION DESIGN SHALL BE PREPARED BY A DULY QUALIFIED ARCHITECT IN CONSULTATION WITH CHIEF ADMINISTRATOR/ CHIEF ARCHITECT & SECY. DEPARTMENT OF ARCHITECTURE, CHANDIGARH ADMINISTRATION & THE WORK SUPERVISED BY THE SAME OR BY ANOTHER QUALIFIED ARCHITECT.
 - A THE BUILDING PLANS FOR A BUILDING TO BE ERRECTED OR RE ERRECTED ON ANY OF THE SITES SHOWN ON SITE PLAN SHALL BE PREPARED TO A SCALE OF EIGHT FEET TO AN INCH & SHALL BE SHOWN IN DETAIL WITH FULL ELEVATIONS AND TYPICAL SECTION OF THE FACADES ALONG THE COMPULSORY BUILDING LINES.
 - B (CONTINUED ON DRG No. 13)
- APPROVAL RECEIVED FROM THE CHIEF ADMINISTRATOR, CHD. ADMIN. VIDE MEMO No. 4269-U.T.F.1(4)-89/1304, DATED 8-9-89

S.No.	DESCRIPTION	SIGN	DATE
-------	-------------	------	------

REVISIONS

Sd/ O.P. MEHTA
10.7.89
CHIEF ARCHITECT

Sd/ S.K. MIDHA
7.7.89
SENIOR ARCHITECT

Sd/ SARBJEET SINGH
7-7-89
ARCHITECT

Sd/ RAKESH GUPTA
ASSTT. ARCHITECT

OFFICE OF
THE CHIEF ARCHITECT & SECY.
CHANDIGARH

SCALE = 1/8" = 1' TO A FOOT DATE - 7.7.89

DEALT BY KANTA KUMARI	JOB No. 2183	DRG. No. 12
CHECKED BY ROMESH MAHAJAN		

ARCHITECTURAL CONTROL FOR
SPECIAL BLOCKS ALONG
V2B ROAD SECTOR 34

FIRST AND SECOND
FLOOR PLAN

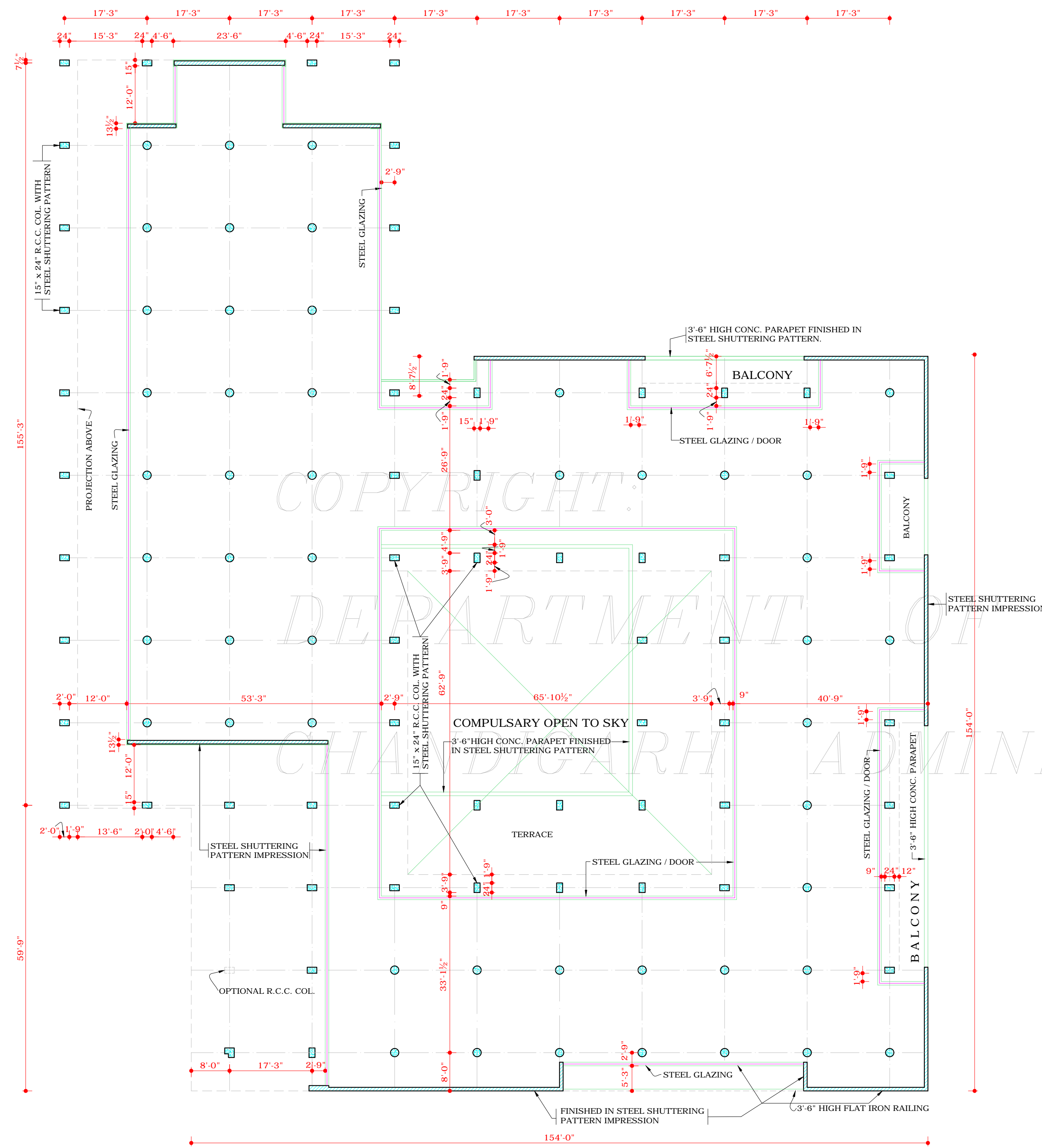

FIRST FLOOR PLAN

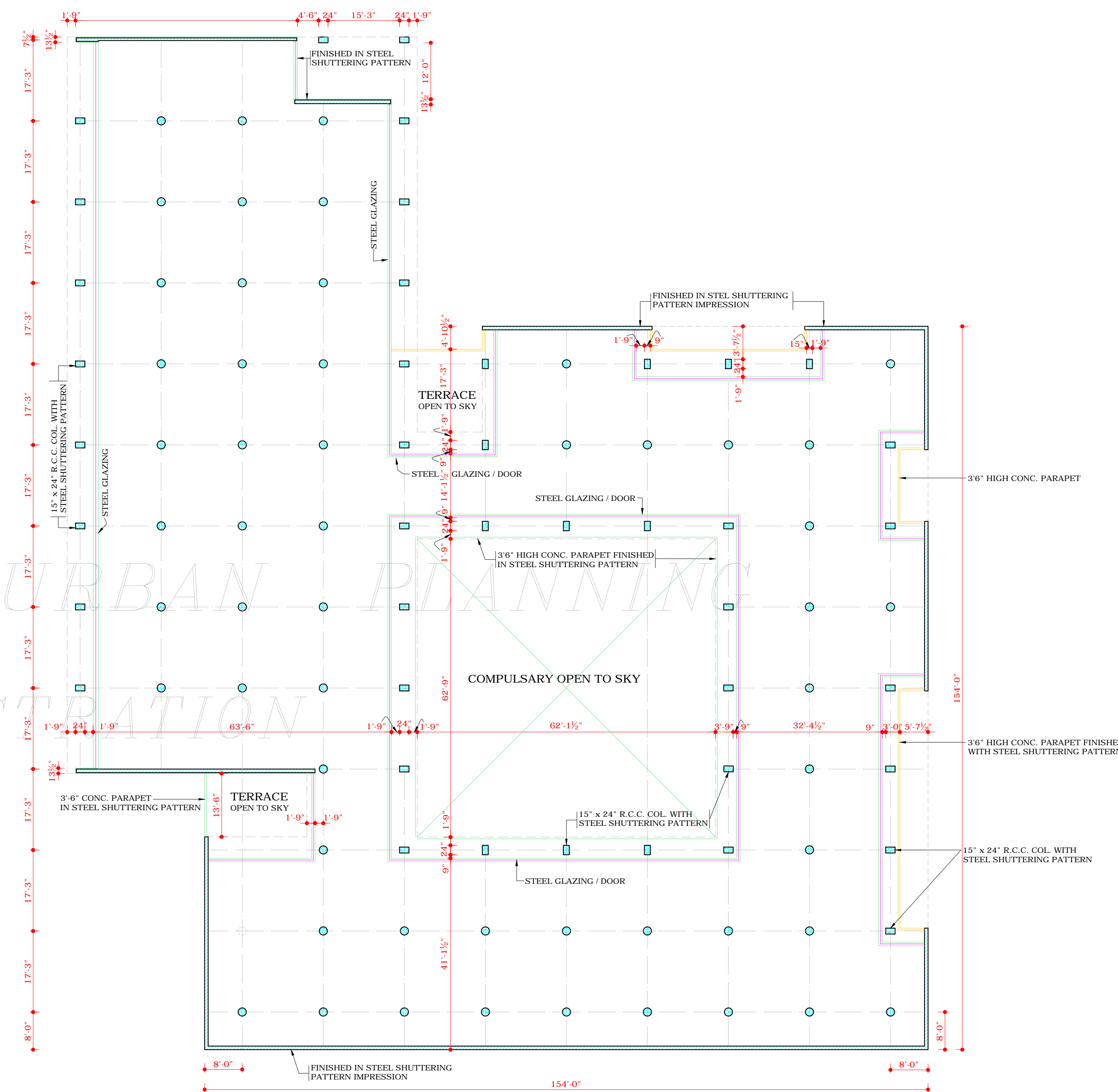

SECOND FLOOR PLAN

DISCLAIMER

THOUGH EVERY CARE HAS BEEN TAKEN TO PROVIDE THE CORRECT VERSION OF THE ARCHITECTURAL CONTROL ON THIS DIGITIZED (PDF) FORMAT, YET IN CASE OF ANY DISCREPANCY, THE MASTER COPY OF THE ARCHITECTURAL CONTROL APPLICABLE ON EACH SUCH SITE, AS AVAILABLE IN THE COMMERCIAL RECORD OF THE OFFICE OF CHIEF ARCHITECT OR HER/HIS INTERPRETATION WILL OVERRULE THE DIGITIZED FORMAT.

NOTE:-
THIS DRAWING HAS BEEN COMPUTERISED ON 06-09-10
FROM DRG. No. 12 JOB No. 2183

Sd/
CHIEF ADMINISTRATOR