

DEPARTMENT OF ARCHITECTURE

- NOTES:
- THIS DRG. IS THE PROPERTY OF THE DEPTT. OF ARCHITECTURE U.T. OF CHD & MUST NOT BE ALTERED, COPIED OR USED IN WHOLE OR IN PART WITHOUT THE PERMISSION OF THE DEPTT. IN WRITING.
 - ONLY QUALIFIED ARCHITECTS ARE ALLOWED TO SUBMIT PLANS, SUPERVISE CONSTRUCTION & ISSUE COMPLETION CERTIFICATES FOR THESE BUILDINGS.
 - THIS DRG. IS TO BE READ TOGETHER WITH THE DRG. NO. 36 JOB NO. 28 SHOWING PLOT NO. 142, TO PLOT NO. 154.
 - FLOOR LEVEL SHALL BE OBTAINED FROM THE OFFICE OF THE CHIEF ARCHITECT & SECY. DEPTT. OF ARCHITECTURE CHD.
 - EXPOSED BRICK WORK SHALL MEAN FAIR FACED BRICK WORK WITHOUT ANY PAINT, COLOUR WASH OR POINTING.
 - PLASTERED FACE WHERE EVER SHOWN ON THE DRAWING SHALL BE WHITE WASH UNLESS OTHERWISE SPECIFIED.
 - INTERNAL CHANGES MAY BE ALLOWED SUBJECT TO THE PRIOR APPROVAL OF THE CHIEF ADMINISTRATOR.
 - NO DEVIATION IN EXTERNAL FACADE OR FACADES THESE VERANDAH SHALL BE ALLOWED.
 - EXTERNAL DOORS, WINDOWS, SHUTTERS & JOINERY WORK IN STEEL OR IN WOOD AS SPECIFIED IN THE DRAWING SHALL BE PAINTED IN GREY COLOUR OF ISI GRADE NO. 600 ONLY.
 - NO ADVERTISEMENT SHALL BE ALLOWED ON THE SPACES OTHER THAN STIPULATED.
 - NO RAIN WATER SOIL VENTILATING OR ANY OTHER PIPE SHALL BE PERMITTED ON THE EXTERNAL FACES OF THE BUILDING.
 - THE MEANS OF TAKING ELECTRICAL TELEPHONES OR ANY OTHER CONNECTIONS FROM THE PUBLIC SUPPLY LINES SHALL BE SHOWN ON THE BUILDING PLANS & SHALL BE SUBJECT TO THE APPROVAL OF THE CHIEF ADMINISTRATOR.
 - ELECTRIC INSTALLATIONS AS FAR AS LIGHT FITTINGS ARE CONCERNED SHALL BE FOLLOWED AS SHOWN IN THE PLAN.
 - NO WATER STORAGE TANK OR CHIMNEY ETC. SHALL PROJECT BEYOND THE HEIGHT OF PARAPET OF PARTY WALL SO AS TO BE VISIBLE TO THE PUBLIC.
 - THIS DRG. IS ALSO APPLICABLE IN CASE OF SHOPPING CENTRE SECTOR 35 (PLOT NO. 84 TO 97 & 200 TO 270). FOR LAYOUT REF. DRG. NO. 16 JOB NO. 58 Sd/- IQBAL SINGH 4. 2. 70
 - THIS DRG. SHALL ALSO APPLY IN THE CASE OF SHOPPING CENTRE IN SECTOR 31-C PLOT NO. 69 TO 78 AS PER LAY-OUT REF. PLAN OF JOB NO. 45 DRG. NO. 15. Sd/- IQBAL SINGH 7. 5. 70
 - AS PER CHIEF COMMISSIONERS ORDER DATED 15. 3. 71 REVISION MADE ON 6. 7. 71 REAR COURTYARD COVERAGE OPTIONAL PROVIDED IT IS IN CONFORMITY WITH BUILDING BYE LAWS. Sd/- O.P. MEHTA ARCHITECT 4. 2. 70

THIS DRG. IS ACTUALLY TRACED FROM DRG. NO. 1 OF JOB NO. 649 ON DATED 18. 3. 72
 THIS DRG. IS ALSO APPLICABLE TO S.C.O. NOS. 68, 68-A, 70 AND 70-A, SEC. 31-C. Sd/- 14-3-05
 ATTESTED TRUE COPY
 Sd/- KUREKAR ASSTT. ARCHITECT.
 Sd/- S. L. VERMA CHIEF ADMINISTRATOR. 19. 9. 70.

Sd/- M.N. SHARMA 6. 2. 70 CHIEF ARCHITECT.
 Sd/- R.R. HANDA 5. 2. 70 SENIOR ARCHITECT.

Sd/- O.P. MEHTA 4. 2. 70 ARCHITECT.
 Sd/- IQBAL SINGH 4. 2. 70 ASSTT. ARCHITECT.

OFFICE OF THE CHIEF - ARCHITECT CHANDIGARH
 SCALE = 1/4" TO A FOOT DATE -
 RE-DRAWN Sd/- GURCHAMAN SINGH JOB NO. 649 DRG NO. 1
 CHECKED 649

SHOP - CUM - OFFICES IN SECTORS 28-D & 35, 31-C
 GROUND, FIRST & SECOND FLOOR PLANS.

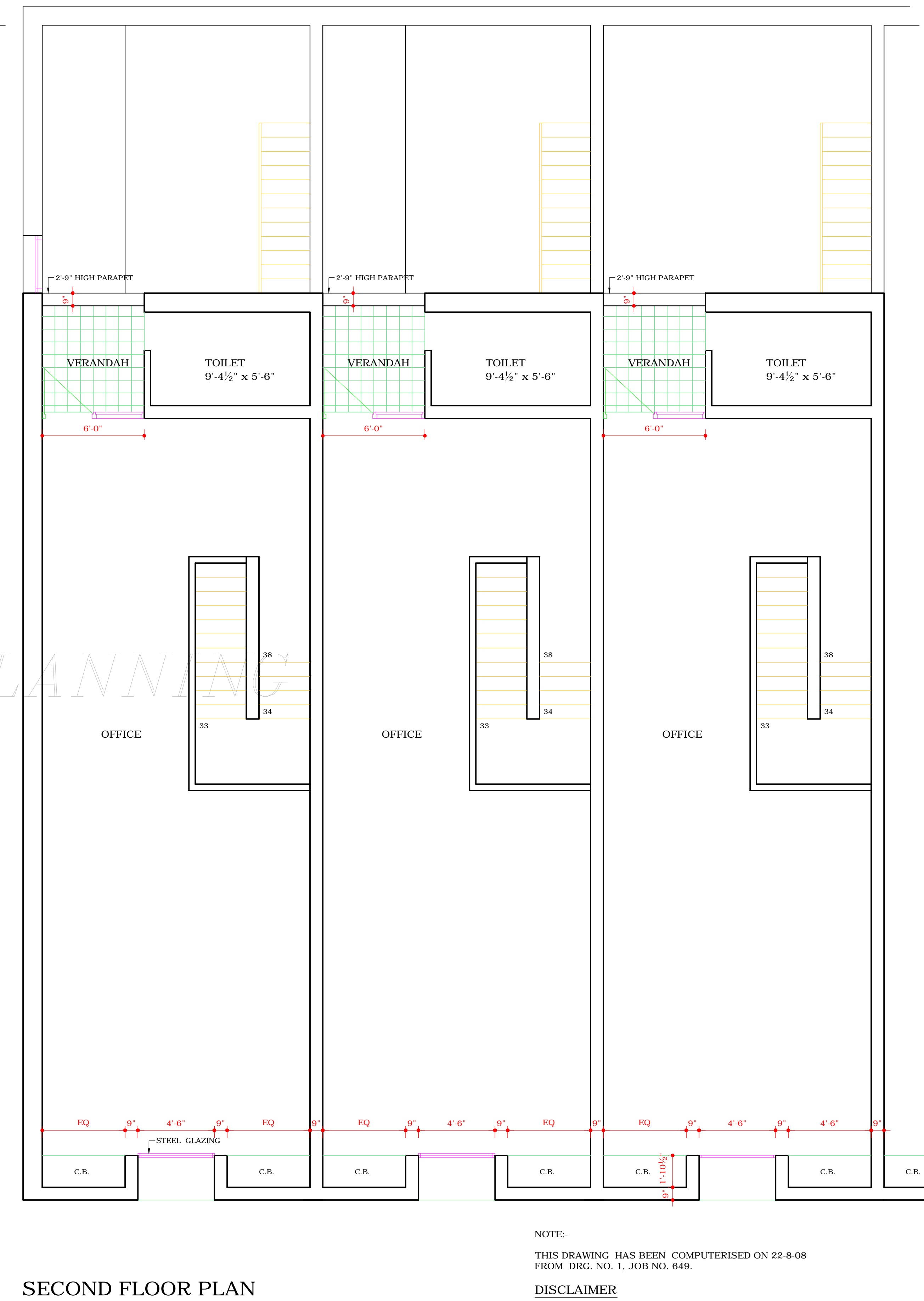
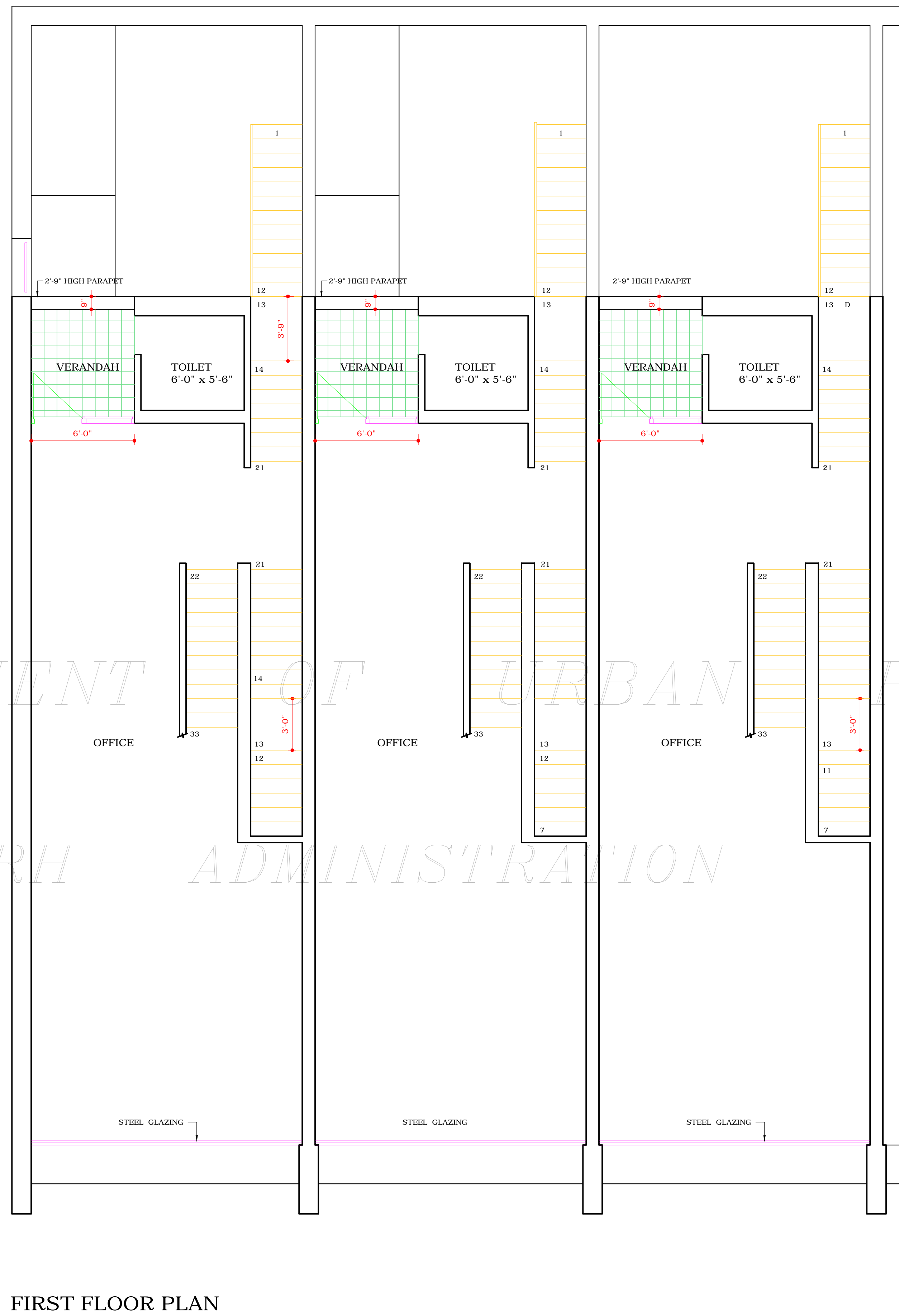
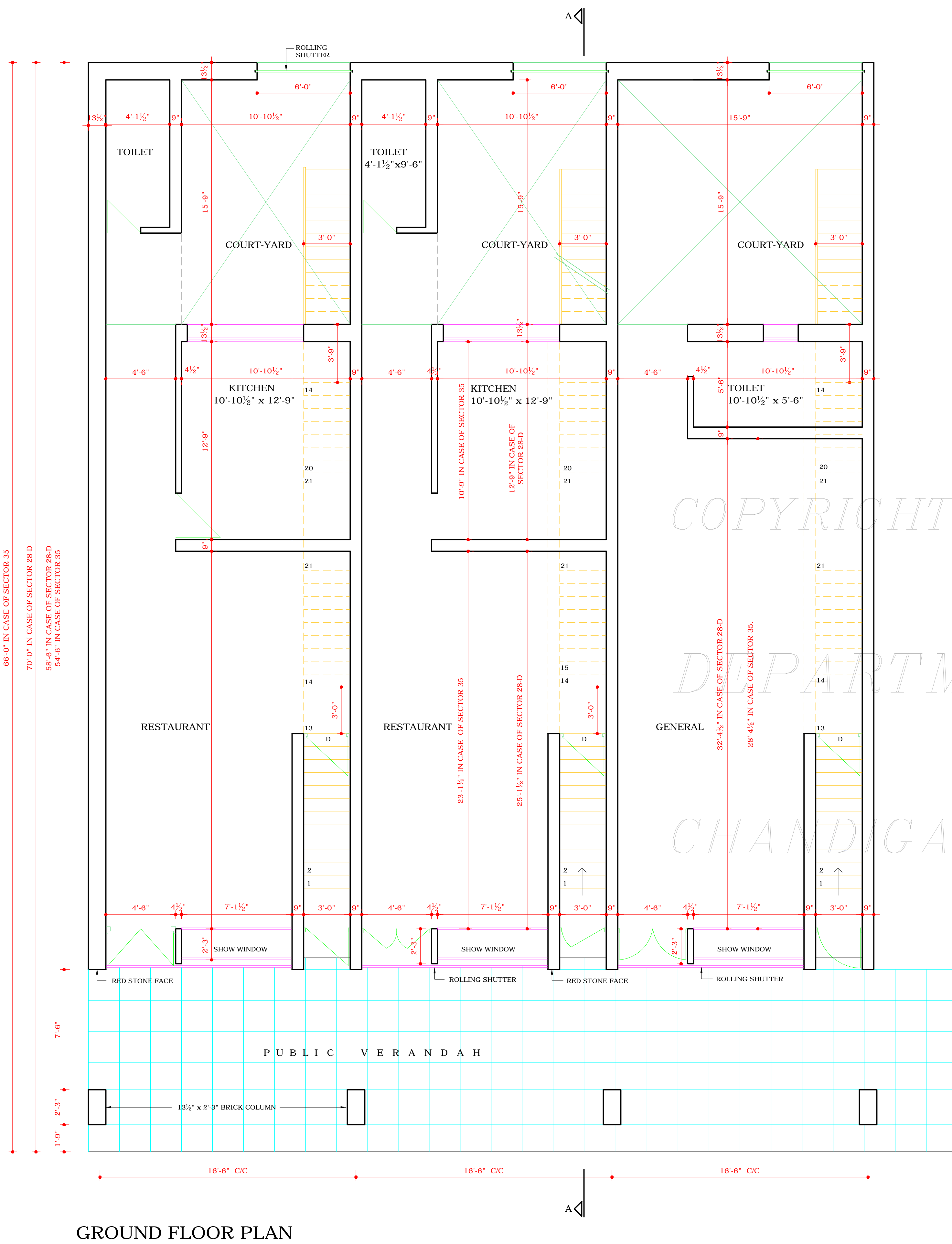

NOTE:
 THIS DRAWING HAS BEEN COMPUTERISED ON 22-8-08 FROM DRG. NO. 1, JOB NO. 649.

DISCLAIMER
 THOUGH EVERY CARE HAS BEEN TAKEN TO PROVIDE THE CORRECT VERSION OF THE ARCHITECTURAL CONTROL ON THIS DIGITIZED (PDF) FORMAT, YET IN CASE OF ANY DISCREPANCY, THE MASTER COPY OF THE ARCHITECTURAL CONTROL APPLICABLE ON EACH SUCH SITE, AS AVAILABLE IN THE COMMERCIAL RECORD OF THE OFFICE OF CHIEF ARCHITECT OR HERES INTERPRETATION WILL OVERRULE THE DIGITIZED FORMAT.