

DEPARTMENT OF ARCHITECTURE

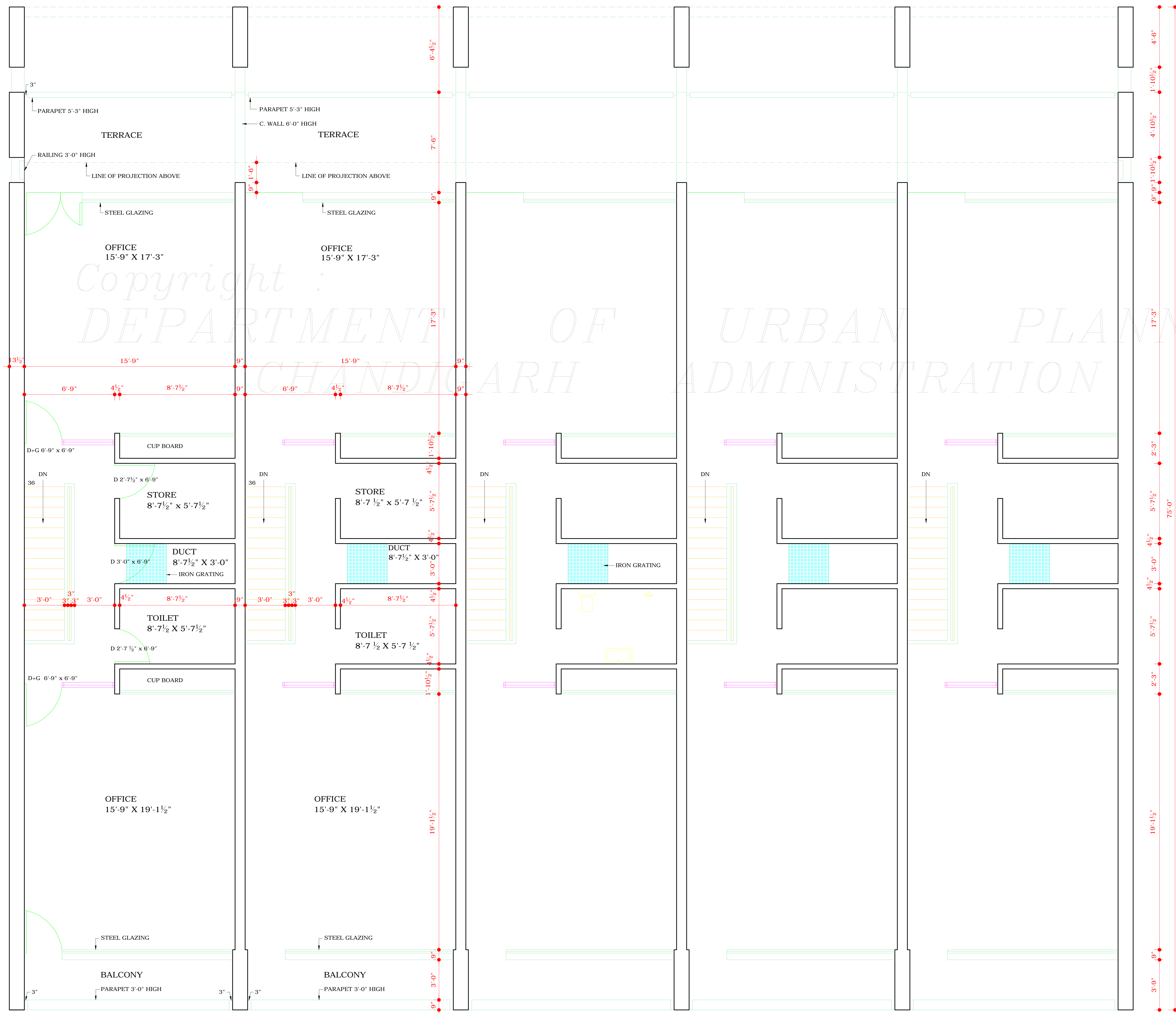

SECOND FLOOR PLAN

DISCLAIMER

THOUGH EVERY CARE HAS BEEN TAKEN TO PROVIDE THE CORRECT VERSION OF THE ARCHITECTURAL CONTROL ON THIS DIGITIZED (PDF) FORMAT, YET IN CASE OF ANY DISCREPANCY, THE MASTER COPY OF THE ARCHITECTURAL CONTROL APPLICABLE ON EACH SUCH SITE, AS AVAILABLE IN THE COMMERCIAL RECORD OF THE OFFICE OF CHIEF ARCHITECT OR HER/HIS INTERPRETATION WILL OVERRULE THE DIGITIZED FORMAT.

-----SD/-----
(S. P. KHURANA)
ASST. ARCHITECT

-----SD/-----
26-04-94
(S. S. SANDHU)
SENIOR ARCHITECT

-----SD/-----
03-05-94
(S. K. MIDHA)
CHIEF ARCHITECT

-----SD/-----
08-11-94
(A. R. TALWAR)
CHIEF ADMINISTRATOR

APPROVAL OF THE CHIEF ADMINISTRATOR RECEIVED REGARDING MAKING THE SKYLIGHT ON THE TOP TERRACE IS OPTIONAL VIDE HIS OFFICE MEMO NO. 139 - UTFI (3) - 2K/1201 DATED:- 8.2.2000

Sd/-
(RAKESH SINGH)
CHIEF ADMINISTRATOR

Sd/-13-01-2000
(SARBJEET SINGH)
CHIEF ARCHITECT

Sd/- 13-01-2000
(A.K SABHARWAL)
SENIOR ARCHITECT

Sd/- 13-01-2000
(K.I.S. VIRDI)
ARCHITECT

Sd/- 13-1-2000
(RAJEEV MEHTA)
ASSTT. ARCHITECT

Sd/- SEWA SINGH
18-02-83
CHIEF ADMINISTRATOR

Sd/- K.K MUKERJEE
21-12-74
CHIEF ADMINISTRATOR

S.NO	NOTES
1.	THIS DRAWING IS THE PROPERTY OF DEPTT. OF ARCHITECTURE, U.T. CHANDIGARH FORMERLY OF THE GOVT. OF PB. AND MUST NOT BE ALTERED COPIED OR USED IN WHOLE OR IN PART WITHOUT THE PERMISSION OF THIS DEPTT. IN WRITING.

1.	NOTE : THIS DRAWING IS THE COMPUTERISED REPRODUCTION OF ORIGINAL DRG. No. 3. JOB No. 883 DATED - 04.06.08
	HEIGHT OF REAR PARAPET INCREASED FROM 3'-0" TO 5'-3" AT 1ST AND 2ND FLOOR APPROVAL RECEIVED FROM FINANCE SECRETARY VIDE MEMO NO. 2228-UTFI(4)94/ 15225 DATED:- 8.11.94

S.NO.	DESCRIPTION
REVISIONS	
Sd/- CHIEF ARCHITECT	Sd/- SENIOR ARCHITECT
Sd/- ARCHITECT	Sd/- ASSTT. ARCHITECT

OFFICE OF THE CHIEF ARCHITECT CHANDIGARH U.T.

SCALE = 4 FT. TO AN INCH	DATE:- 19.12.74
DRAWN BY :- A. S. RATRA	JOB NO. 883
CHECKED BY:-	DRG. NO. 3

SHOP CUM OFFICES / FLATS SECTORS 31-D AND 47-C, AND 37-C & 37-D & 36-D ARCH. CONTROL SHEET

SECOND FLOOR PLAN