

DEPARTMENT OF  
URBAN PLANNING  
CHANDIGARH ADMN.

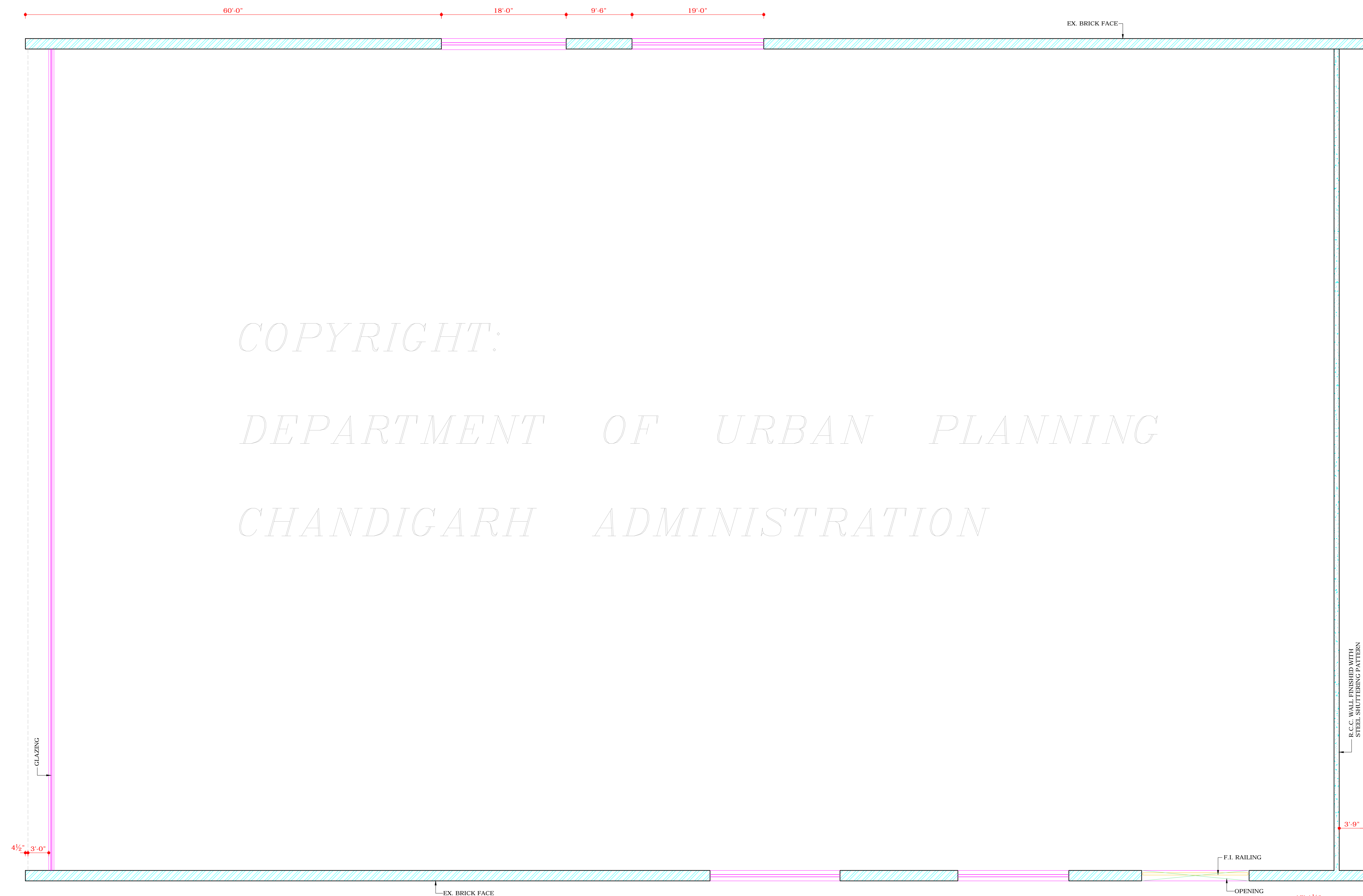

PLAN AT LEVEL +34'-10 1/2"  
(INTERNAL PLANNING AS PER THE CONCEPT  
APPROVED BY THE CHIEF ARCHITECT)

**DISCLAIMER**

THOUGH EVERY CARE HAS BEEN TAKEN TO PROVIDE THE CORRECT VERSION OF THE ARCHITECTURAL CONTROL ON THIS DIGITIZED (PDF) FORMAT, YET IN CASE OF ANY DISCREPANCY, THE MASTER COPY OF THE ARCHITECTURAL CONTROL APPLICABLE ON EACH SUCH SITE, AS AVAILABLE IN THE COMMERCIAL RECORD OF THE OFFICE OF CHIEF ARCHITECT OR HER/HIS INTERPRETATION WILL OVERRULE THE DIGITIZED FORMAT.

APPROVAL OF THE CHIEF ADMINISTRATOR  
RECEIVED VIDE HIS OFFICE MEMO No. 2314-  
UTFI (3)-2001/6654 DATED 16.8.2001

Sd/- 13.8.2001  
(KARAN A. SINGH)  
CHIEF ADMINISTRATOR  
CHANDIGARH ADMINISTRATION

S.No. NOTES

1. THIS DRG. IS THE PROPERTY OF THE PROPERTY OF THE DEPTT. OF URBAN PLANNING U.T. CHANDIGARH AND MUST NOT BE ALTERED, COPIED OR USED IN WHOLE OR IN PART WITHOUT THE PERMISSION OF THIS DEPTT. IN WRITING.

NOTE:  
THIS DRAWING HAS BEEN COMPUTERISED ON  
28-01-16 FROM DRG. No. 16 JOB No. 2019

S.No. DESCRIPTION SIGN DATE

REVISIONS

Sd/- (SARBJEET SINGH)  
20-7-2001  
CHIEF ARCHITECT

Sd/- (RENU SAIGAL)  
SENIOR ARCHITECT

Sd/- (RAKESH CUPTA)  
ARCHITECT ASSTT. ARCHITECT

OFFICE OF THE  
CHIEF ARCHITECT & SECY.  
CHANDIGARH U.T.

SCALE : 1/8" = 1'-0" DATED 19.7.2001

Sd/- DRAWN	JOB No.	DRG. No.
Sd/- S.D. SHARMA CHECKED	2019	16

ALTERNATIVE ARCHITECTURAL  
CONTROL SHEETS FOR  
CINEMA/ MULTIPLEX AT  
MANIMAJRA

PLAN AT LEVEL +34'-10 1/2"