

SECTION AT A-B

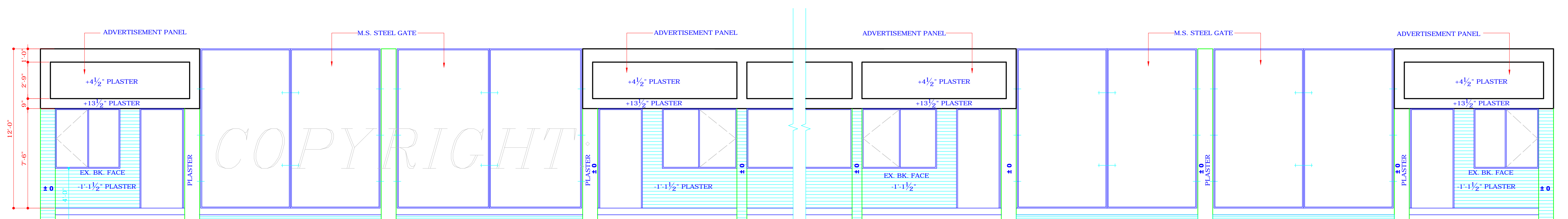

FRONT ELEVATION

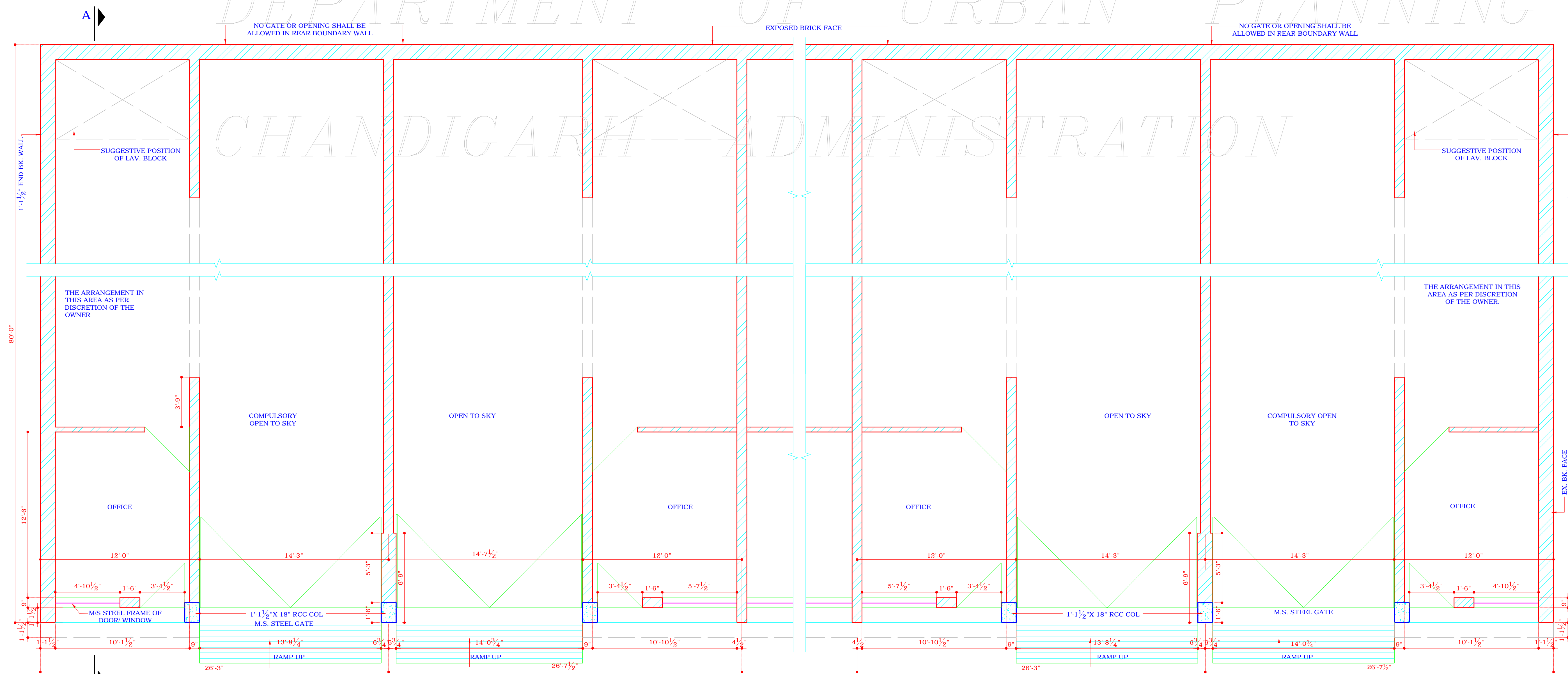

PLAN (LEFT END PLOT)

PLAN (RIGHT END PLOT)

SD: (KARAN A. SINGH)
CHIEF ADMINISTRATOR

NOTE:
APPROVAL HAS BEEN RECEIVED FROM THE CHIEF
ADMINISTRATOR VIDE HIS NO. 89-UTF1(3)-2003/81
DATED: 11-02-2003

DISCLAIMER
THROUGH EVERY CARE HAS BEEN TAKEN TO
PROVIDE THE CORRECT VERSION OF THE
ARCHITECTURAL CONTROL ON THIS DIGITIZED
(PDF) FORMAT. YET IN CASE OF ANY
DISCREPANCY, THE MASTER COPY OF THE
ARCHITECTURAL CONTROL APPLICABLE ON
EACH SUCH SITE, AS AVAILABLE IN THE
COMMERCIAL RECORD OF THE OFFICE OF THE
CHIEF ARCHITECT OR HER/HS INTERPRETATION
WILL OVERRULE THE DIGITIZED FORMAT.

S.NO.	NOTES
1.	THIS DRG. IS THE PROPERTY OF THE DEPTT. OF URBAN PLANNING U.T. CHD. AND IT MUST NOT BE ALTERED, COPIED OR USED IN WHOLE OR IN PART WITHOUT THE PERMISSION OF THIS DEPTT. IN WRITING.
2.	ONLY DULY QUALIFIED REGISTERED ARCHITECTS ARE ALLOWED TO SUBMIT THE PLANS. SUPERVISE CONSTRUCTION AND ISSUE THE COMPLETION CERTIFICATES.
3.	PLINTH LEVEL SHALL BE OBTAINED FROM THE CHIEF ARCHITECT, DEPT. OF URBAN PLANNING U.T. CHANDIGARH
4.	EXPOSED BRICK FACE SHALL MEAN A FAIR FACE BRICK FACE WITHOUT ANY PAINT, COLOUR WASH OR POINTING TO BE FINISHED.
5.	PLASTERED SURFACE SHOWN ON THE DRG. SHALL BE WHITE WASHED UNLESS OTHERWISE SPECIFIED.
6.	NO DEVIATION IN THE EXTERNAL FACADE SHALL BE ALLOWED.
7.	EXTERNAL DOOR, WINDOW, GATE AND JOINERY WORK IN STEEL AS SPECIFIED IN THE DRG., SHALL BE PAINTED AS PER OWNER DISCRETION.
8.	NO ADVERTISEMENT SHALL BE ALLOWED IN SPACES OTHER THAN STIPULATED ON DRGS.
9.	NO RAIN WATER PIPE, SOIL VENTILATING OR ANY OTHER PIPE SHALL BE SEEN ON THE EXTERNAL FACE OF THE BUILDING.
10.	THE MEANS OF TAKING ELECTRICAL, TELEPHONE OR ANY OTHER CONNECTION FROM PUBLIC SUPPLY LINE SHALL BE SHOWN ON THE BUILDING PLANS AND SHALL BE SUBJECT TO THE APPROVAL OF THE CHIEF ADMINISTRATOR.
11.	NO WATER STORAGE TANK OR CHIMNEY STACK ETC. OR ANY MATERIAL STACKS ON THE ROOF SHALL PROJECT BEYOND THE HEIGHT OF THE PARAPET WALL SO AS NOT TO BE VISIBLE FROM THE STREET.
12.	NO BASEMENT SHALL BE ALLOWED BELOW SITES.
13.	THIS DRG. IS TO BE READ ALONG WITH DRG. NO. 23 JOB NO 84 AND FOR LAYOUT REFER DRG. NO. 23 OF JOB NO. 84 OF T.P. WING.
14.	THIS ARCHITECTURAL CONTROL IS APPLICABLE TO SITE NO. 2000 TO 2007 AT MILKMAN COLONY DHANAS.
15.	LOADING, UNLOADING AND STACKING SHALL NOT BE PERMITTED OUTSIDE THE PREMISES.

S.NO.	DESCRIPTION	SIGN	DATE
REVISIONS			

SD-
(RENU SAIGAL)
CHIEF ARCHITECT

SD-
(ASHWANI K. SABHARWAL)
SENIOR ARCHITECT

SD-
(RASHIM GUPTA)
8.1.03
ARCHITECT

ASSTT.Architect

OFFICE OF THE
CHIEF ARCHITECT & SECRETARY
U.T, CHANDIGARH

SCALE :- 1/4" = 1'-0"

DATE : 8.01.2003

(DRAWN BY)

JOB NO.

DRG. NO.

CHECKED BY

2613

1

STANDARD DESIGN OF FUEL
WOOD SITES NO. 2000 TO 2007
AT MILKMAN COLONY DHANAS

PLAN, ELEVATION &
SECTION, DETAIL