

THE NECESSARY APPROVAL OF THE CHIEF ADMINISTRATOR FOR THE ADDITIONAL COVERAGE WITH IN THE HEIGHT LIMIT (9'-0") SHOWN AS CYCLE STAND WITH LINK PASSAGE AND OPEN COURTS ON EITHER SIDES, OBTAINED VIDE HIS OFFICE MEMO No. 1409 U.T.F.I. (2) 778435 DATED 25-5-77.

DEPARTMENT OF ARCHITECTURE

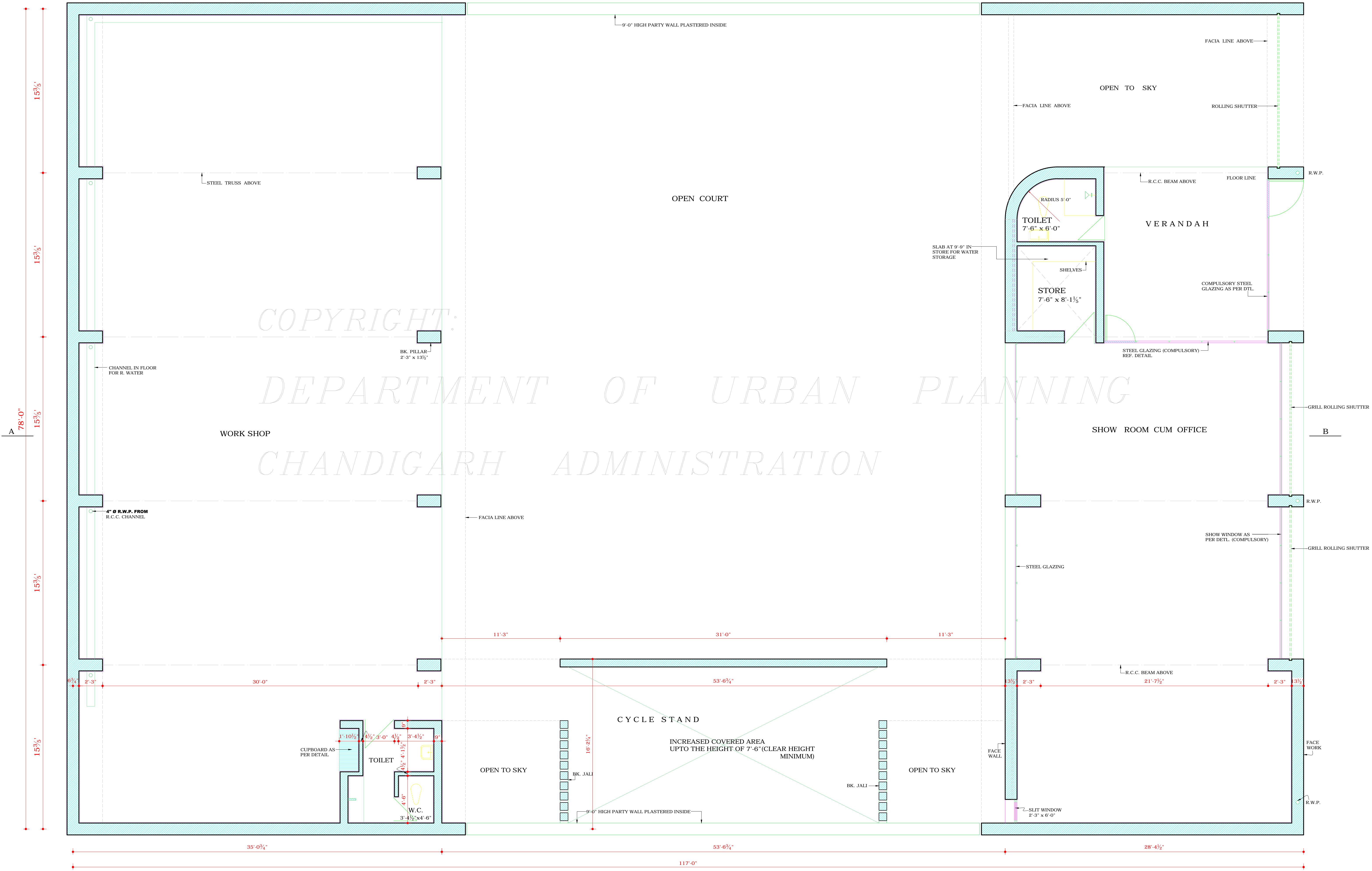

S.No. NOTES.

1. THIS DRAWING IS THE PROPERTY OF DEPT. OF ARCHITECTURE CHANDIGARH AND MUST NOT BE ALTERED, COPIED OR USED IN WHOLE OR IN PART WITHOUT THE PERMISSION OF THIS DEPTT. IN WRITING.
2. PLINTH LEVEL SHALL BE KEPT IN ACCORDANCE WITH THOSE INDICATED ON THE LAYOUT PLAN OF THE WORK SHOPS.
3. EXPOSED BRICK WORK SHALL MEAN FAIR FACED WORK WITHOUT ANY PAINT, COLOUR WASH OR POINTING.
4. PLASTERED SURFACES WHEREVER SHOWN ON THE DRG. SHALL BE WHITE WASHED UNLESS OTHERWISE SPECIFIED.
5. INTERNAL CHANGES MAY BE ALLOWED SUBJECT TO THE PRIOR APPROVAL OF THE CHIEF ADMINISTRATOR.
6. NO DEVIATION IN THE EXTERNAL FACADES SHALL BE ALLOWED.
7. THE EXTERNAL DOORS, WINDOWS, SHUTTERS AND JOINERY WORK IN STEEL OR WOOD AS IS SPECIFIED SHALL BE PAINTED IN GREY COLOUR OF I.S.I. SHADE No. 693 ONLY.
8. NO ADVERTISEMENT SHALL BE ALLOWED ON PLACES OTHER THAN STIPULATED.
9. COURT YARD SHALL REMAIN OPEN TO SKY AS SHOWN ON THE DRAWINGS.
10. NO RAIN WATER, SOIL, VENTILATING OR ANY OTHER PIPE SHALL BE PERMITTED ON THE EXTERNAL FACE OF ANY BUILDING.
11. THE MEANS OF TAKING ELECTRICAL, TELEPHONE OR ANY OTHER CONNECTIONS FROM THE PUBLIC SUPPLY LINES SHALL BE SHOWN ON THE BUILDING PLANS AND SHALL SUBJECT TO THE APPROVAL OF THE CHIEF ADMN.
12. ELECTRICAL INSTALLATIONS AS FAR AS LIGHT FITTINGS ARE CONCERNED SHALL BE AS SHOWN ON THE PLANS.
13. NO WATER STORAGE OR ANY OTHER TANK SHALL PROJECT BEYOND THE HEIGHT OF THE PARAPET OR PARTY WALL SO AS TO BE VISIBLE TO THE PUBLIC.
14. DULY QUALIFIED ARCHITECTS ARE ALLOWED TO SUBMIT PLANS, SUPERVISE CONSTRUCTION AND ISSUE COMPLETION CERTIFICATES FOR THESE BLDGS.
15. DRGS. Nos. 3 & 4 OF JOB No. 494 ARE TO BE READ TOGETHER.
16. DRGS. Nos. 3 & 4 OF JOB No. 494 SUPERCEED DRG. Nos. 1 & 2 OF JOB 494 AND DRG. No. 1 & 2 OF JOB No. 495.
17. THIS STANDARD DESIGN IS APPLICABLE TO TWO KANAL PLOT Nos. 217 TO 221 (BOTH INCLUSIVE), 346 TO 349 (BOTH INCLUSIVE) 358 TO 381 (BOTH INCLUSIVE).
18. INTERNAL ELEVATION SHALL BE SUBMITTED AND GOT SANCTIONED ALONG WITH THESE PLANS.

TOTAL AREA- 9126 SFT.
COVERED AREA- 4500 SFT.

NOTES:
THIS DRAWING HAS BEEN COMPUTERISED ON 30-04-10 FROM DRG. No. 3 JOB No. 494.

CHECKED Sd/- IQBAL SINGH 22/7/69 ASSTT. ARCHITECT	ATTESTED Sd/- O.P. MEHTA ARCHITECT
--	--

Sd/- DALJEET SINGH
2-3-68
CHIEF ADMINISTRATOR

Sd/- M.N. SHARMA 2-3-68 CHIEF ARCHITECT	Sd/- J.S. DETHÉ SENIOR ARCHITECT
---	-------------------------------------

Sd/- IQBAL SINGH ASSTT. ARCHITECT	Sd/- O.P. MEHTA ARCHITECT
--------------------------------------	------------------------------

OFFICE OF THE CHIEF ARCHITECT, CHANDIGARH

SCALE:- 4 FEET TO AN INCH DATE- 1st JULY 1969

Sd/- JATINDER DRAWN P. PARKASH RE-DRAWN	DRG. No. 3	JOB No. 494
---	------------	-------------

WORKSHOP IN INDUSTRIAL AREA

PLAN

DISCLAIMER
THOUGH EVERY CARE HAS BEEN TAKEN TO PROVIDE THE CORRECT VERSION OF THE ARCHITECTURAL CONTROL ON THIS DIGITIZED (PDF) FORMAT, YET IN CASE OF ANY DISCREPANCY, THE MASTER COPY OF THE ARCHITECTURAL CONTROL APPLICABLE ON EACH SUCH SITE, AS AVAILABLE IN THE COMMERCIAL RECORD OF THE OFFICE OF CHIEF ARCHITECT OR HER/HIS INTERPRETATION WILL OVERRULE THE DIGITIZED FORMAT.

Sd/- H.S. CHOPRA
25.2.77
SENIOR ARCHITECT

Sd/- ADITYA PARKASH
CHIEF ARCHITECT

Sd/- M.S. CHAHAL
CHIEF ADMINISTRATOR