

DEPARTMENT OF ARCHITECTURE U.T.

S.No. NOTES.

1. THIS DRG. IS THE PROPERTY OF THE DEPTT. OF ARCH. CHD. U.T. FORMERLY OF THE Pb. GOVT & HENCE MUST NOT BE ALTERED, COPIED OR USED IN WHOLE OR IN PARTS WITHOUT THE PERMISSION OF THIS DEPTT. IN WRITING.
2. P.L. WILL BE KEPT IN ACCORDANCE WITH THOSE INDICATED ON THE LAYOUT PLAN OF THE WORK SHOPS, EX. BK. WORK SHALL MEAN FAIR FACED BK. WORK WITHOUT ANY PAINT, COLOUR WASH OR POINTING.
3. PLASTERED SURFACES WHEREVER SHOWN ON THE DRG. SHALL BE WHITE WASHED UNLESS OTHERWISE SPECIFIED.
4. INTERNAL CHANGES MAY BE ALLOWED SUBJECT TO THE PRIOR APPROVAL OF THE CHIEF ADMINISTRATOR. NO DEVIATION IN THE EXTERNAL FACADES SHALL BE ALLOWED.
5. THE EXTERNAL DOORS, WINDOWS, SHUTTERS & JOINERY WORK IN STEEL SHALL BE PAINTED IN GREY COLOUR OF I.S. SHADE No. 693 ONLY.
6. NO ADVERTISEMENT SHALL BE ALLOWED IN PLACES OTHER THAN STIPULATED.
7. COURTYARDS SHALL REMAIN OPEN TO SKY AS SHOWN ON THE DRGS.
8. NO RAIN WATER, SOIL, VENTILATING OR ANY OTHER PIPE SHALL BE PERMITTED ON THE EXTERNAL FACE OF ANY BUILDING.
9. THE MEANS OF TAKING ELECTRICAL, TELEPHONE OR ANY OTHER CONNECTION FROM THE PUBLIC SUPPLY LINES SHALL BE SHOWN ON BLDG. PLANS AND SHALL BE SUBJECT TO THE APPROVAL OF THE CHIEF ADMINISTRATOR.
10. ELECTRICAL INSTALLATIONS AS FAR AS LIGHT FITTINGS ARE CONCERNED SHALL BE SHOWN ON THE PLANS.
11. NO WATER STORAGE OR ANY OTHER TANK SHALL PROJECT BEYOND THE HT. OF PARAPET OR PARTY WALL SO AS TO BE VISIBLE TO THE PUBLIC.
12. DILY QUALIFIED ARCHITECTS ARE ALLOWED TO SUBMIT PLANS, SUPERVISE CONSTRUCTION AND ISSUE COMPLETION CERTIFICATES FOR THESE BUILDINGS.
13. THESE DRGS. (Nos. 5, 6 & 7) OF JOB No. 494 ARE TO BE READ TOGETHER.
14. THIS STANDARD DESIGN IS APPLICABLE TO TWO KANAL PLOT Nos. 217 TO 231 (BOTH INCLUSIVE) 346 TO 349 (BOTH INCLUSIVE) 358 TO 381 (BOTH INCLUSIVE).
15. INTERNAL ELEVATIONS SHALL BE SUBMITTED AND GOT SANCTIONED ALONG WITH THESE PLANS.

(CONTINUED ON DRG. No. 6).

NOTES:- THIS DRAWING HAS BEEN COMPUTERISED ON 30-04-10 FROM DRG. No. 5 JOB No. 494.

Sd/- SEWA SINGH
27-11-82
CHIEF ADMINISTRATOR

Sd/- SURJIT SINGH
15-10-82
CHIEF ARCHITECT

Sd/- R.S. LALL
15-X-82
SENIOR ARCHITECT

Sd/- J.N. SETH
20-8-82
ARCHITECT

Sd/- S.S. VIRDI
20-8-82
ASSTT. ARCHITECT

OFFICE OF THE CHIEF ARCHITECT
CHANDIGARH

SCALE = 4 FEET TO AN INCH DATE: 20-8-82

DEALT BY HARINDER KAUR	JOB No. 494	DRG. No. 5
---------------------------	----------------	---------------

TWO KANAL WORKSHOP
IN INDUSTRIAL AREA

GROUND FLOOR PLAN

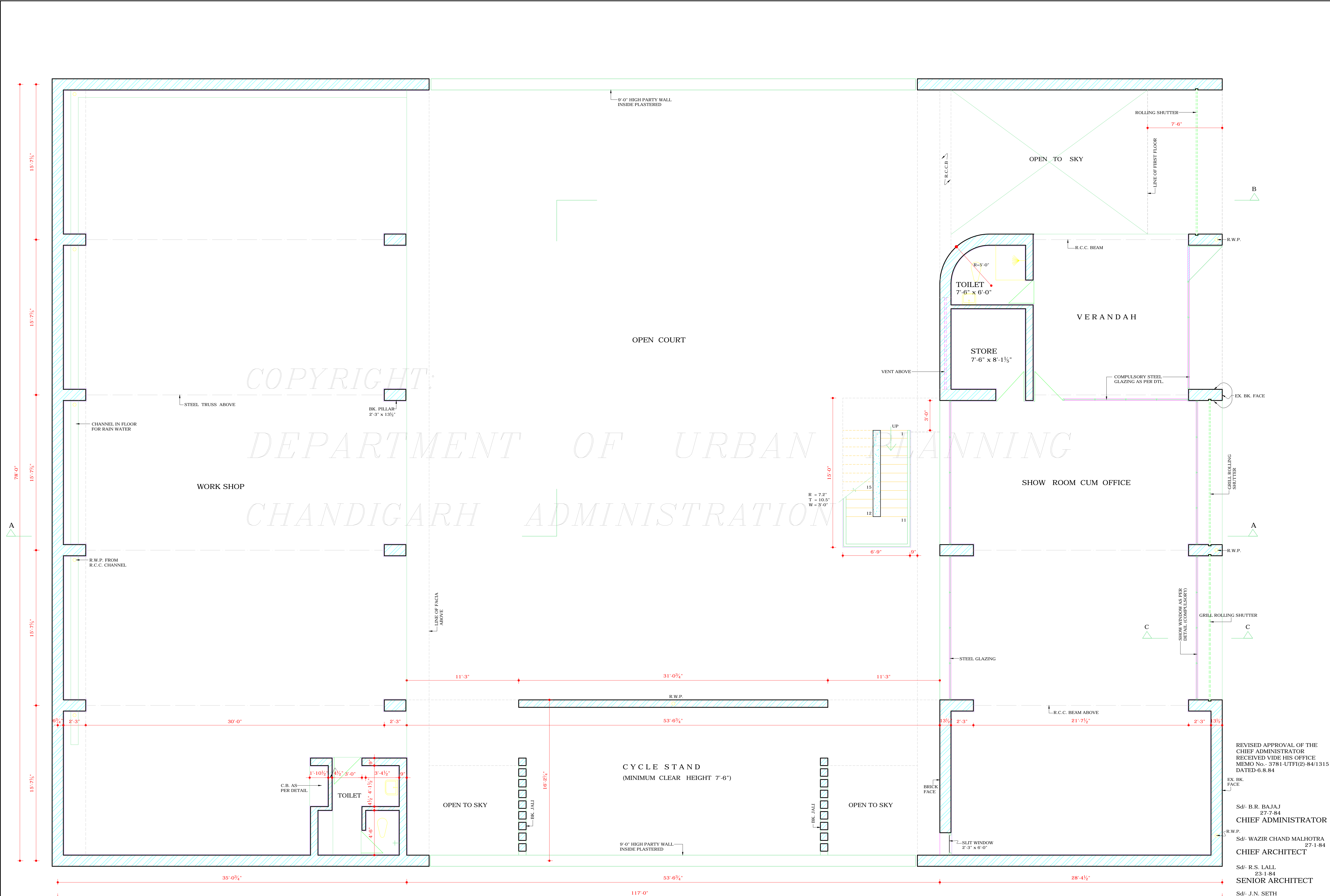

GROUND FLOOR PLAN

DISCLAIMER
THOUGH EVERY CARE HAS BEEN TAKEN TO PROVIDE THE CORRECT VERSION OF THE ARCHITECTURAL CONTROL ON THIS DIGITIZED (PDF) FORMAT, YET IN CASE OF ANY DISCREPANCY, THE MASTER COPY OF THE ARCHITECTURAL CONTROL APPLICABLE ON EACH SUCH SITE, AS AVAILABLE IN THE COMMERCIAL RECORD OF THE OFFICE OF CHIEF ARCHITECT OR HER/HIS INTERPRETATION WILL OVERRULE THE DIGITIZED FORMAT.

REVISED APPROVAL OF THE CHIEF ADMINISTRATOR RECEIVED VIDE HIS OFFICE MEMO No.- 3781-UTP(2)-84/13151 DATED-6-8-84

Sd/- B.R. BAJAJ
27-7-84
CHIEF ADMINISTRATOR

Sd/- WAZIR CHAND MALHOTRA
27-1-84
CHIEF ARCHITECT

Sd/- R.S. LALL
23-1-84
SENIOR ARCHITECT

Sd/- J.N. SETH
22-12-83
ARCHITECT

APPROVAL OF THE CHIEF ADMINISTRATOR RECEIVED VIDE HIS OFFICE MEMO No.- 89938-U.T.F.I.(2)-82/19299 DATED-15-12-82