

S.NO.	NOTES
-------	-------

NOTE
THIS DRAWING IS TO BE READ ALONG WITH
DRG. NO.4 OF JOB NO.811

COPYRIGHT:
DEPARTMENT OF URBAN PLANNING
CHANDIGARH ADMINISTRATION

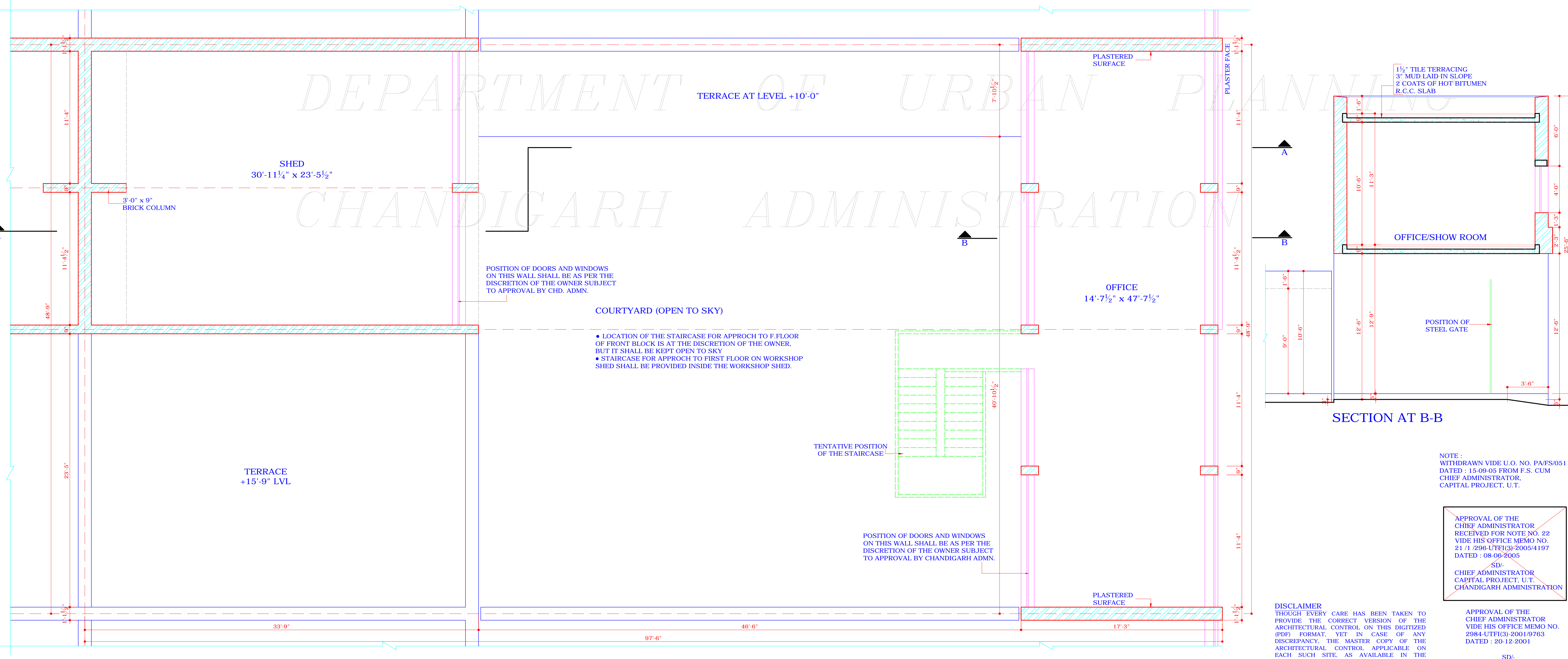

S.NO.	DESCRIPTION	SIGN	DATE
-------	-------------	------	------

REVISIONS

SD:
(SARBJEET SINGH)
(23-10-2001)
CHIEF ARCHITECT

SD:
(RENU SAIGAL)
SENIOR ARCHITECT

SD:
(BALVINDER SAINI)
(18-10-2001)
ARCHITECT

SD:
(SHAMS S. SHAIKH)
(18-10-2001)
ASST. ARCHITECT

OFFICE OF THE
CHIEF ARCHITECT,
U.T, CHANDIGARH

SCALE : 1/4" = 1'-0" DATE : 15.10.2001

DRAWN BY	JOB NO.	DRG. NO.
	811	5

CHECKED BY

ARCHITECTURAL CONTROL
OF ONE KANAL PLOTS
IN INDUSTRIAL AREA,
PH-I & II CHANDIGARH WITH
F.S.I. ABOVE 0.75

FIRST FLOOR PLAN,
ELEVATION AND SECTIONS