

DEPARTMENT OF ARCHITECTURE U.T.

- S.No. NOTES:-
1. THIS DRAWING IS THE PROPERTY OF THE DEPTT. OF ARCHITECTURE, CHD. FORMERLY OF P.B. GOVT. & MUST NOT BE ALTERED, COPIED OR USED IN WHOLE OR IN PART WITHOUT PRIOR PERMISSION OF THIS DEPTT. IN WRITING.
 2. ONLY QUALIFIED ARCHITECTS SHALL BE ALLOWED TO SUBMIT PLANS. SUPERVISE THE CONSTRUCTION & ISSUE COMPLETION CERTIFICATE FOR THESE BUILDINGS.
 3. PLINTH LEVEL SHALL BE KEPT IN ACCORDANCE WITH THOSE INDICATED ON THE LAYOUT PLAN OF THE INDUSTRIAL CENTRE.
 4. EXPOSED BK. WORK SHALL MEAN FAIR FACED BK. WORK WITHOUT ANY PAINT. COLOUR WASH OR POINTING.
 5. PLASTERED SURFACES WHERE EVER SHOWN ON THE DRG. SHALL BE WHITE WASHED UNLESS OTHERWISE SPECIFIED.
 6. INTERNAL CHANGES MAY BE ALLOWED SUBJECT TO THE PRIOR APPROVAL OF THE CHIEF ADMINISTRATOR. NO DEVIATIONS IN THE EXTERNAL FACADES SHALL BE ALLOWED.
 7. THE OWNER AT HIS OWN DISCRETION CAN ADOPT ANY ONE ELEVATION OUT OF THREE ALTERNATIVE ELEVATIONS SHOWN IN DRG. No. 2 OF JOB No. 987.
 8. THE EXTERNAL DOORS, WINDOWS SHUTTERS AND JOINERY WORK IN STEEL OR IN WOOD AS IS SPECIFIED SHALL BE PAINTED IN GREY COLOUR OF ISI SHADE NO. 693 ONLY.
 9. NO ADVERTISEMENTS WILL BE ALLOWED ON PLACES OTHER THAN STIPULATED.
 10. COURTYARD SHALL REMAIN OPEN TO SKY AS SHOWN ON DRAWING.
 11. NO RAIN WATER, SOIL VENTILATING OR ANY OTHER PIPE SHALL BE PERMITTED ON THE EXTERNAL FACE OF ANY BUILDING.
 12. THE MEANS OF TAKING ELECTRICAL, TELEPHONE OR ANY OTHER CONNECTION FROM THE PUBLIC SUPPLY LINES SHALL BE SHOWN ON THE BUILDING PLANS & SHALL BE SUBJECT TO THE PRIOR APPROVAL OF THE CHIEF ADMINISTRATOR.
 13. ELECTRICAL INSTALLATIONS AS FAR AS LIGHT FITTINGS ARE CONCERNED SHALL BE SHOWN ON THE PLAN.
 14. NO WATER STORAGE OR ANY OTHER TANK SHALL PROJECT BEYOND THE HEIGHT OF THE PARAPET OR PARTY WALL.
 15. NO LOFTS SHALL BE ALLOWED IN SHED & OFFICE BLOCK.
 16. THIS DRAWING SHOULD BE READ ALONG WITH DRG. NO. 2 OF JOB. 987.
 17. CONSTRUCTION OF FRONT BLOCK COMPRISING OF OFFICE & ENTERANCE & STORE OFFICE IS COMPULSORY. THE REMAINING SHALL BE PERMITTED TO BE CONSTRUCTED IN PHASES, AS PER CONVENIENCE OF THE OWNER.
 18. THE TREATMENT OF END WALL IN CASE OF CORNER PLOTS & DETAIL OF STEEL GATE, IF SIDE HUNG SHUTTERS ARE PROVIDED SHALL BE OBTAINED FROM THE OFFICE OF THE CHIEF ARCHITECT & SECY. CHANDIGARH.

NOTE: THIS DRAWING HAS BEEN COMPUTERISED ON 10/05/10 FROM DRG. No. 1 JOB No. 987

DESCRIPTION

REVISIONS

Sd/- M.N. SHARMA 25/2/77 CHIEF ARCHITECT	Sd/- 25/2/77 SENIOR ARCHITECT.
--	-----------------------------------

Sd/- S.K. MIDHA 24.2.77 ARCHITECT.	Sd/- 24.2.77 ASSTT. ARCHITECT.
--	-----------------------------------

OFFICE OF THE CHIEF ARCHITECT CHANDIGARH U.T.

SCALE = 1/4" TO A FOOT DATE: 21.2.77

DRAWN BY JASWINDER VIRDI	JOB No. 987	DRG. No. 1
CHECKED BY		

ARCHITECTURAL CONTROL OF TWO KANAL PLOTS FOR POWER LOOM INDUSTRY, INDUSTRIAL AREA CHANDIGARH

PLAN

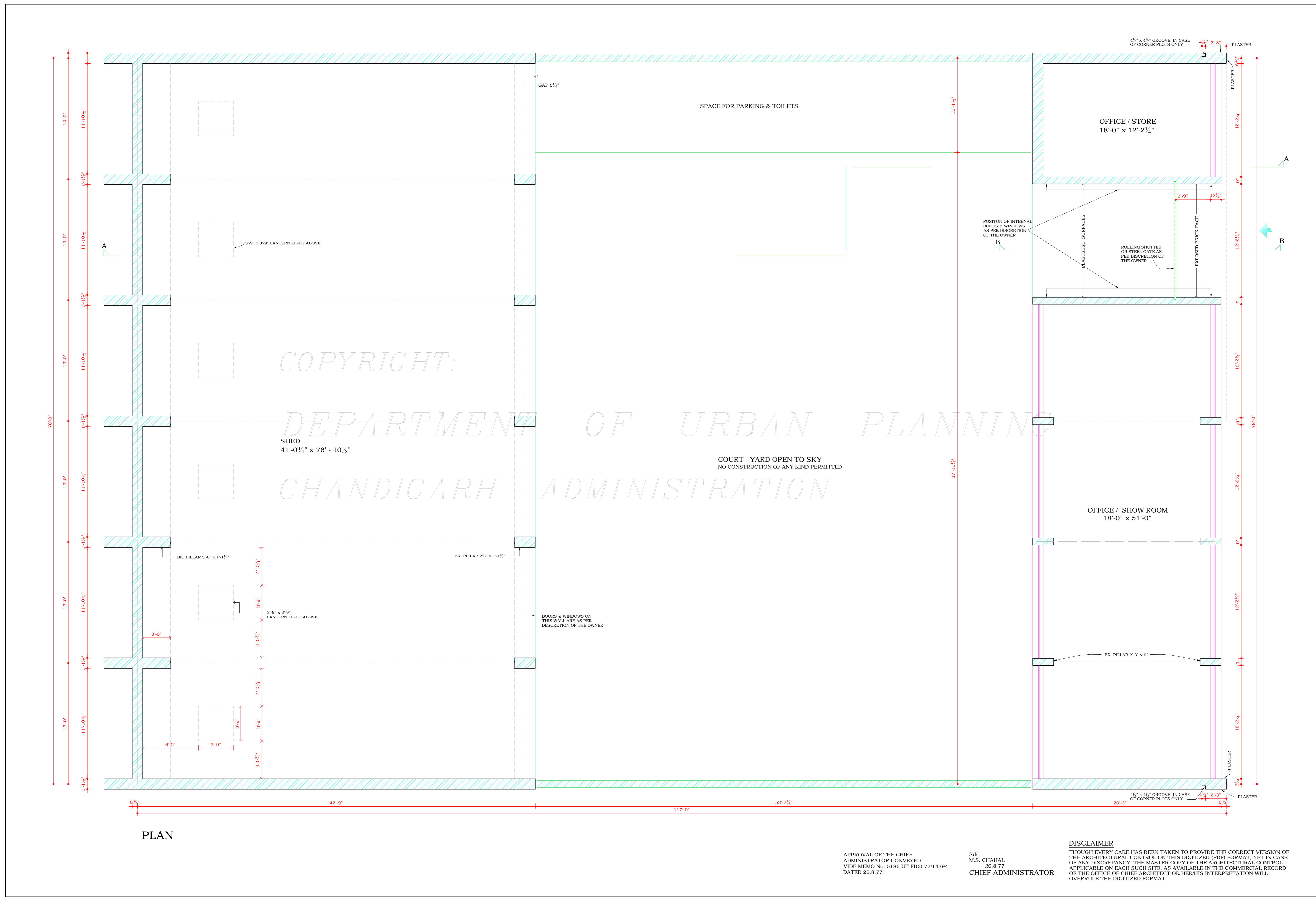

APPROVAL OF THE CHIEF ADMINISTRATOR CONVEYED VIDE MEMO No. 5182-UT FI(2)-77/14394 DATED 26.8.77

Sd/- M.S. CHAHAL
20.8.77
CHIEF ADMINISTRATOR

DISCLAIMER
THOUGH EVERY CARE HAS BEEN TAKEN TO PROVIDE THE CORRECT VERSION OF THE ARCHITECTURAL CONTROL ON THIS DIGITIZED (PDF) FORMAT, YET IN CASE OF ANY DISCREPANCY, THE MASTER COPY OF THE ARCHITECTURAL CONTROL APPLICABLE ON EACH SUCH SITE, AS AVAILABLE IN THE COMMERCIAL RECORD OF THE OFFICE OF CHIEF ARCHITECT OR HER/HIS INTERPRETATION WILL OVERRULE THE DIGITIZED FORMAT.