

NOTES:

- FOR SECTIONS OF DAKSHAN MARG AND ROUND ABOUT REF. TOWN PLANNING DRG.

NOTE: THIS DRAWING HAS BEEN COMPUTERISED ON 27/07/88 FROM ORIGINAL DRG. No. 3 OF 80 No. 451

S.No.	DESCRIPTION	DATE	SIGN
REVISIONS			

Sd/-
28.10.88
CHIEF ADMINISTRATOR
CAPITAL PROJECT
CHANDIGARH

Sd/- M.N. SHARMA
28.10.88
ARCHITECT.

Sd/- J.S. DETHI
27.10.88
SENIOR ARCHITECT.

Sd/-
28.10.88
ARCHITECT. ASSTT. ARCHITECT.

OFFICE OF THE CHIEF ARCHITECT TO GOVT. Pb. CHANDIGARH.

SCALE - 3/4" = 1' TO AN INCH
DRAWN GURBAL J.S. SACHDEVIA
CHECKED SACHDEVIA
DRG. No. 3
JOB No. 451

ZONING PLAN OF COMMERCIAL STRIP IN DAKSHAN MARG SEC-29-C CHANDIGARH.

SUBSECTOR - 29 C

SUBSECTOR - 30 C

COMMERCIAL STRIP SECTOR - 29/D

SECTOR - 31

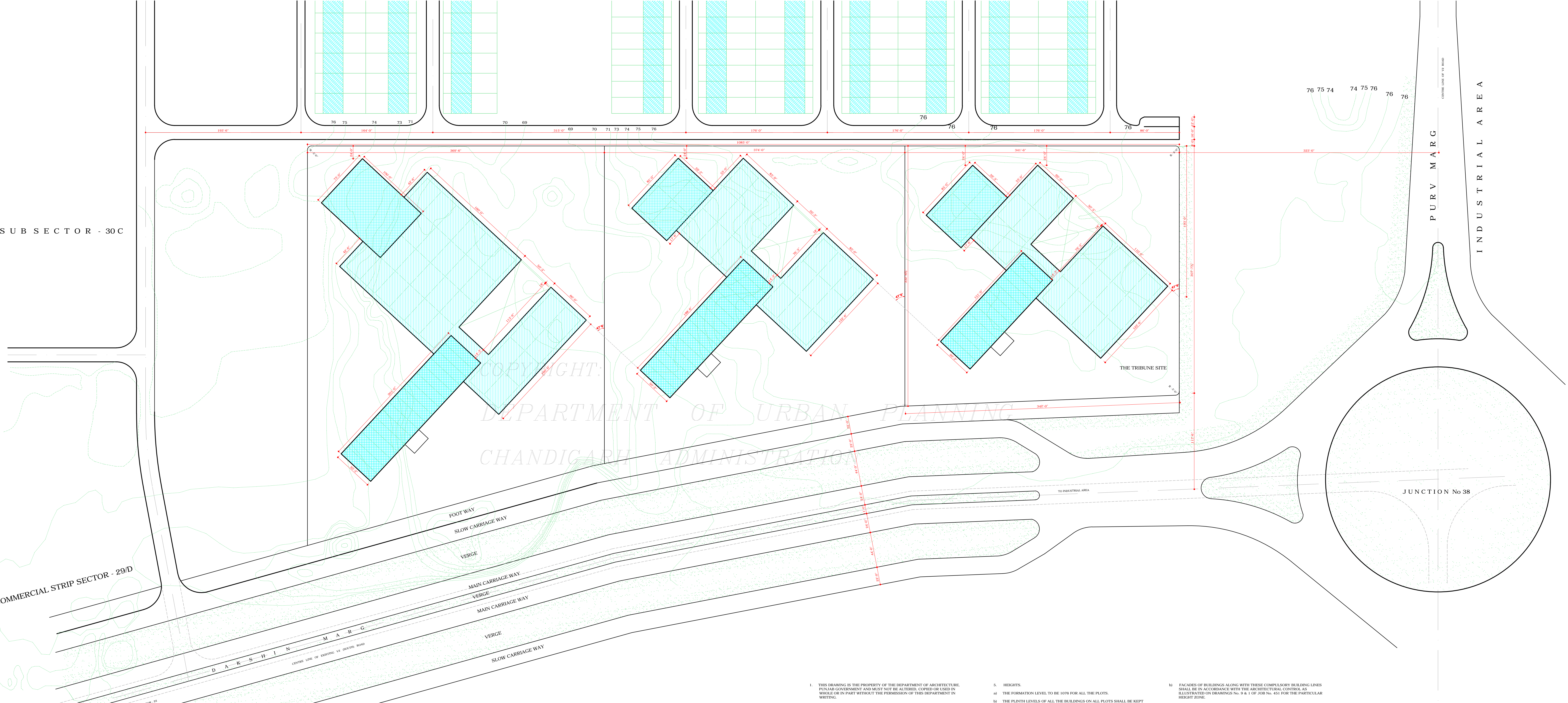

- THIS DRAWING IS THE PROPERTY OF THE DEPARTMENT OF ARCHITECTURE, PUNJAB GOVERNMENT AND MUST NOT BE ALTERED, COPIED OR USED IN WHOLE OR IN PART WITHOUT THE PERMISSION OF THIS DEPARTMENT IN WRITING.
- PRELIMINARY
- THIS ZONING AND ARCHITECTURAL CONTROL SHEETS ARE ISSUED IN EXERCISE OF THE POWERS CONFERRED BY SECTION 4 OF THE CAPITAL OF PUNJAB DEVELOPMENT AND REGULATION ACT, 1952 AND ARE TO BE READ IN CONJUNCTION WITH THE BUILDING RULES MADE UNDER THE SAID ACT.
- THIS ZONING PLAN IS TO BE READ WITH THE ARCHITECTURAL CONTROL SHEETS (DRG. No. 2 TO 12) AND OTHER DETAILS OF JOB No. 451.
- SITE COVERAGE
- THE MAXIMUM PERMISSIBLE COVERED AREA ON ANY OF THE SITE SHALL NOT EXCEED THE AREA HATCHED AND CROSS HATCHED ON THE PLAN FOR THAT PARTICULAR SITE.
- OPEN COURT OR COURTS OF ANY SHAPE INSIDE THE SINGLE STOREY ZONE ARE PERMISSIBLE PROVIDED THAT NO SUCH COURT YARD IS LESS THAN 12' 0" WIDE AT ITS NARROWEST PORTION.
- TYPE OF BUILDING PERMITTED

ZONE No.	INDICATIONS	NUMBER OF STOREYS PERMISSIBLE	COMPULSORY HEIGHTS ABOVE PLINTH
1.		ONE STOREY	21'-0"
2.		TWO STOREYS	28'-0"
3.		FOUR STOREYS	58'-0"

- HEIGHTS
- THE FORMATION LEVEL TO BE 10% FOR ALL THE PLOTS.
- THE PLINTH LEVELS OF ALL THE BUILDINGS ON ALL PLOTS SHALL BE KEPT ONE FOOT ABOVE THE FORMATIONS LEVEL. I.e. 1077.
- EACH BLOCK IS DIVIDED IN TO THREE HEIGHTS ZONES AS UNDER

- FAÇADES OF BUILDINGS ALONG WITH THESE COMPULSORY BUILDING LINES SHALL BE IN ACCORDANCE WITH THE ARCHITECTURAL CONTROL AS ILLUSTRATED IN DRAWINGS No. 9 & 1 OF JOB No. 451 FOR THE PARTICULAR HEIGHT ZONE.
- THE PLINTH LEVELS OF ALL THE BUILDINGS ON ALL PLOTS SHALL BE KEPT ONE FOOT ABOVE THE FORMATIONS LEVEL. I.e. 1077.
- ANY DILATION, MODIFICATION OR ALTERATION IN THE FAÇADE MAY BE PERMITTED BY THE CHIEF ADMINISTRATOR, BUT SUCH PERMISSION MUST BE OBTAINED PRIOR TO EXECUTION OF THE BUILDING AT SITE.
- FINISHES OF CONCRETE FACE AND EXPOSED BRICK WORK SHALL BE AS INDICATED ON THE ARCHITECTURAL CONTROL SHEET DRAWING No. 9 OF JOB No. 451.
- BOUNDARY WALLS AND GATE POSTS AND GATES SHALL BE ERRECTED IN ACCORDANCE WITH THE STANDARD DESIGN.
- DESIGN AND SUPERVISION
- THE DESIGN SHALL BE PREPARED BY A DULY QUALIFIED ARCHITECT IN CONSULTATION WITH THE CHIEF ADMINISTRATOR AND THE WORK EXECUTED UNDER THE SUPERVISION OF SAME ARCHITECT OR ANOTHER DULY QUALIFIED ARCHITECT, BUT IN CASE OF ANY OTHER DULY QUALIFIED ARCHITECT PERMISSION TO SUPERVISE THE EXECUTION MUST BE TAKEN FROM THE CHIEF ADMINISTRATOR BEFORE COMMENCEMENT OF HIS DUTIES.
- THE BUILDING PLANS FOR A BUILDING TO BE ERRECTED OR BE ERRECTED ON ANY OF THE SITES SHOWN ON THIS PLAN SHALL BE ACCOMPANIED BY DRAWINGS TO A SCALE 4" = 1' TO AN INCH, SHOWING THE FULL ELEVATIONS AND TYPICAL SECTIONS OF EACH FAÇADE OR PART THEREOF, AS RUN ALONG THE COMPULSORY BUILDING LINES.
- NO DOWN PIPES, WASTE PIPES, VENT PIPES ETC. AND THE WATER STORAGE TANKS ON TERRACE SHALL BE EXPOSED TO VIEW ON THE FAÇADE OF THE BUILDING BUT SHALL BE SEATILY ENCASED.

DISCLAIMER
THOUGH EVERY CARE HAS BEEN TAKEN TO PROVIDE THE CORRECT VERSION OF THE ARCHITECTURAL CONTROL ON THIS DIGITIZED PDF FORMAT, YET IN CASE OF ANY DISCREPANCY, THE MASTER COPY OF THE ARCHITECTURAL CONTROL, APPLICABLE ON EACH SUCH SITE, AS AVAILABLE IN THE COMMERCIAL RECORD OF THE OFFICE OF CHIEF ARCHITECT OF CHANDIGARH WILL OVERRULE THE DIGITIZED FORMAT.